

Single Row Tapered Roller Bearings (Inch Series)

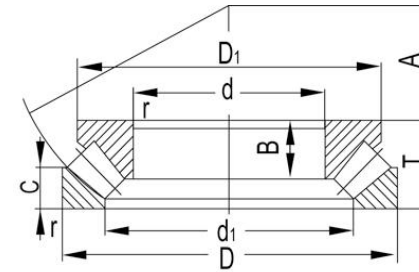

Bearing NO.	Boundary dimensions(mm)								Basic load ratings(kN)		Limiting speed(rpm)		Applicati on point	Abutment and fillet dimensions(mm)						Value			Weight(kg)
	d	D	T	B	C	r ₁ , 2min	r ₃ , 4min	Cr	Cor	Grease	Oil	a	d _{a max}	d _{b min}	D _{a max}	D _{b min}	r _{a max}	r _{b max}	e	Y	Y ₀	Refer	
HH221440/HH221410	95.25	190.5	57.15	57.531	46.038	7.9	3.2	440	602	2300	3400	42.5	115	119	168	179	7.9	3.2	0.33	1.79	0.99	7.37	
42381/42584	96.838	148.43	28.575	28.971	21.433	3.6	3	143	225	2300	3400	31.9	108	108	133	140	3.6	3	0.49	1.22	0.67	1.64	
90381/90744	96.838	188.913	50.8	46.038	31.75	3.6	3.2	276	357	2300	3400	63	108	115	161	179	3.6	3.2	0.87	0.69	0.38	5.68	
52387/52637	98.425	161.925	36.512	36.116	26.195	3.6	3.2	180	288	2200	3300	36	110	114	142	151	3.6	3.2	0.47	1.26	0.69	2.74	
685/672	98.425	168.275	41.275	41.275	30.162	3.6	3.2	224	349	2200	3300	38.6	110	115	147	156	3.6	3.2	0.47	1.28	0.7	3.51	
779/772	98.425	180.975	47.625	48.006	38.1	3.6	3.2	288	438	2100	3200	39.5	110	120	156	166	3.6	3.2	0.39	1.56	0.86	5.2	
HH421246/HH421210	98.425	184.15	63.5	63.5	52.388	6.4	3.2	445	687	2100	3200	46.2	115	117	161	174	6.4	3.2	0.37	1.6	0.88	7.45	
866/854	98.425	190.5	57.15	57.531	44.45	3.6	3.2	353	504	2100	3200	40	110	120	162	172	3.6	3.2	0.33	1.79	0.99	6.99	
HH221442/HH221410	98.425	190.5	57.15	57.531	46.038	3.6	3.2	440	602	2100	3200	42.5	110	119	168	179	3.6	3.2	0.33	1.79	0.99	7.18	
HM321245/HM321210	99.212	171.45	49.213	49.213	38.1	3.6	3.2	295	434	2200	3200	36.6	110	116	153	162	3.6	3.2	0.34	1.75	0.96	4.45	
LM720646/LM720611	99.975	144.975	25.4	25.4	19.05	1.6	1.6	125	216	2200	3200	30.1	107	113	134	140	1.6	1.6	0.46	1.31	0.72	1.34	
HM220149/HM220110	99.975	156.975	42	42	34	7.9	3.6	245	396	2200	3200	32.4	112	120	143	150	7.9	3.6	0.33	1.8	0.99	2.9	
944A/933	99.975	210	67	66.675	53.975	3.6	3.2	450	674	2200	3200	47.9	111	135	181	193	3.6	3.2	0.33	1.84	1.01	10.9	
HH224334/HH224310	99.975	212.725	66.675	66.675	53.975	3.6	3.2	513	699	2200	3200	47.6	111	134	190	201	3.6	3.2	0.33	1.84	1.01	10.9	
HH221447/HH221410	99.982	190.5	57.15	57.531	46.038	6.4	3.2	440	602	2200	3200	42.5	117	119	168	179	6.4	3.2	0.33	1.79	0.99	7.06	
JM720249/JM720210	100	155	36	35	28	3	2.5	191	325	1900	2800	36.8	118	108	140	150	3	2.5	0.47	1.3	0.7	2.45	
JHM720249/JHM720210	100	160	41	40	32	3	2.5	239	380	1900	2800	38.2	107	119	144	155	3	2.5	0.47	1.3	0.7	3.07	
52394X/52637	100	161.925	36.513	36.116	26.195	3.6	3.2	180	288	1900	2800	36	111	114	142	151	3.6	3.2	0.47	1.26	0.69	2.67	
783/772A	100	174.625	47.625	48.006	38.1	3.6	3.2	288	438	1800	2700	39.4	111	120	156	166	3.6	3.2	0.39	1.56	0.86	4.57	
783/772	100	180.975	47.625	48.006	38.1	3.5	3.3	258	375	1800	2700	39.1	111	123	160	172	3.5	3.3	0.39	1.6	0.86	4.96	
863X/853	100	189.997	57	57.531	48	6	3	353	504	1700	2600	39.8	116	120	163	174	6	3	0.33	1.79	0.99	6.94	
863X/854	100	190.5	57.15	57.531	44.45	6	3.3	355	500	1700	2600	41.8	111	126	168	181	6	3.3	0.33	1.8	0.99	6.81	
98394X/98788	100	200	52.761	49.213	34.925	3.6	3.2	347	471	1700	2600	54.7	111	123	171	185	3.6	3.2	0.63	0.95	0.52	6.91	

Bearing NO.	Boundary dimensions(mm)							Basic load ratings(kN)		Limiting speed(rpm)		Application point	Abutment and fillet dimensions(mm)						Value			Weight(kg)
	d	D	T	B	C	r _{1, 2min}	r _{3, 4min}	Cr	Cor	Grease	Oil		a	d _{a max}	d _{b min}	D _{a max}	D _{b min}	r _{a max}	r _{b max}	e	Y	
HH224334/HH224310	100	212.725	66.675	66.675	53.975	3.5	3.3	570	810	1700	2600	47.3	118	133	191	206	3.5	3.3	0.33	1.8	1	11.4
EE215039/215096	100	250.825	76.2	73.025	50.8	6.4	3.2	442	575	1700	2600	72.4	117	140	201	225	6.4	3.2	0.7	0.85	0.47	17.3
52393/52618	100.012	157.162	36.512	36.116	26.195	3.5	3.3	191	310	1900	2800	36.1	108	119	142	153	3.5	3.3	0.47	1.3	0.69	2.51
52393/52638	100.012	161.925	39.688	36.116	29.37	3.5	3.3	191	310	1900	2800	39.2	108	119	143	155	3.5	3.3	0.47	1.3	0.69	2.92
789/772A	100.813	174.625	47.625	47.625	38.1	3.6	3.2	288	438	1900	2800	39.4	113	120	156	166	3.6	3.2	0.39	1.56	0.86	4.51
L420449/L420410	101.6	136.525	21.433	21.433	16.67	1.6	1.6	86	162	1900	2800	24.3	110	111	126	130	1.6	1.6	0.37	1.63	0.9	0.852
L521945R/L521910	101.6	146.05	21.433	21.433	16.67	1.6	1.6	86.4	167	1900	2800	26.2	110	119	134	139	1.6	1.6	0.39	1.53	0.84	1.17
LM720648/LM720610	101.6	146.05	25.4	25.4	19.05	1.6	1.6	125	216	1900	2800	30.1	110	113	134	140	1.6	1.6	0.46	1.31	0.72	1.32
52400/52618	101.6	157.162	36.512	36.116	26.195	3.5	3.3	191	310	1900	2800	36.1	109	120	142	153	3.5	3.3	0.47	1.3	0.69	2.45
52400/52637	101.6	161.925	36.512	36.116	26.195	3.5	3.3	191	310	1900	2800	36.1	109	120	144	155	3.5	3.3	0.47	1.3	0.69	2.69
687/672A	101.6	168.275	41.275	41.275	34.925	3.5	3.3	223	345	1900	2800	38.3	109	121	149	162	3.5	3.3	0.47	1.3	0.7	3.49
687/672	101.6	168.275	41.275	41.275	30.162	3.5	3.3	223	345	1900	2800	38.3	109	121	149	161	3.5	3.3	0.47	1.3	0.7	3.39
780/772A	101.6	174.625	47.625	48.006	38.1	3.6	3.2	288	438	1900	2800	39.4	114	120	156	166	3.6	3.2	0.39	1.56	0.86	4.47
781X/773	101.6	180	48	50.8	40	3.6	3	288	438	1800	2600	39.8	114	120	156	167	3.6	3	0.39	1.56	0.86	5.05
780/772	101.6	180.975	47.625	48.006	38.1	3.5	3.3	258	375	1800	2600	39.1	111	124	160	172	3.5	3.3	0.39	1.6	0.86	4.86
861/853	101.6	189.997	57	57.531	48	7.9	3	353	504	1800	2600	39.8	122	120	163	174	7.9	3	0.33	1.79	0.99	6.81
HH221449/HH221410	101.6	190.5	57.15	57.531	46.038	8	3.3	390	520	1800	2600	42.3	113	131	170	183	8	3.3	0.33	1.8	0.99	6.79
861/854	101.6	190.5	57.15	57.531	44.45	8	3.3	355	500	1800	2600	41.8	112	130	168	181	8	3.3	0.33	1.8	0.99	6.68
98400/98788	101.6	200	52.761	49.212	34.925	3.5	3.3	315	425	1800	2600	54.4	114	132	174	191	3.5	3.3	0.63	0.95	0.52	6.81
HH221449/HH221416	101.6	200.025	61.912	57.531	50.8	8	3.3	390	520	1800	2600	47	113	131	174	188	8	3.3	0.33	1.8	0.99	8.29
HH224335/HH224310	101.6	212.725	66.675	66.675	53.975	7	3.3	570	810	950	1400	47.3	119	137	191	206	7	3.3	0.33	1.8	1	11.2
941/932	101.6	212.725	66.675	66.675	53.975	7	3.3	475	700	950	1400	46.9	118	136	187	201	7	3.3	0.33	1.8	1	11.2
H924033/H924010	101.6	214.313	55.563	52.388	39.688	3.6	3.2	404	578	950	1400	62.3	134	114	185	203	3.6	3.2	0.67	0.89	0.49	9.21
EE215040/215098	101.6	250.825	76.2	73.025	50.8	6.4	6.4	485	635	1500	2000	72.8	122	146	207	236	6.4	6.4	0.7	0.86	0.47	17
HH923649/HH923610	101.6	250.825	76.2	73.025	50.8	6.4	6.4	530	645	1500	2000	73.3	118	145	210	238	6.4	6.4	0.7	0.86	0.47	16.8
HH923649/HH923611	101.6	250.825	76.2	73.025	50.8	6.4	3.3	530	645	1500	2000	73.3	118	145	213	238	6.4	3.3	0.7	0.86	0.47	16.8
689/672	103.188	168.275	41.275	41.275	30.163	3.6	3.2	224	349	1500	2000	38.7	115	115	147	156	3.6	3.2	0.47	1.28	0.7	3.27
782/772A	104.775	174.625	47.625	48.006	38.1	3.6	3.2	288	438	1800	2600	39.4	117	120	156	166	3.6	3.2	0.39	1.56	0.86	4.28
786/772A	104.775	174.625	47.625	48.006	38.1	6.4	3.2	288	438	1800	2600	39.4	120	123	156	166	6.4	3.2	0.39	1.56	0.86	4.27
787/772A	104.775	174.625	47.625	48.006	38.1	7.1	3.2	288	438	1800	2600	39.4	120	124	156	166	7.1	3.2	0.39	1.56	0.86	4.26
782/772	104.775	180.975	47.625	48.006	38.1	3.5	3.3	258	375	1800	2600	39.1	113	125	160	172	3.5	3.3	0.39	1.6	0.86	4.67
786/772	104.775	180.975	47.625	48.006	38.1	6.4	3.3	258	375	1800	2600	39.1	113	128	160	172	6.4	3.3	0.39	1.6	0.86	4.65
787/772	104.775	180.975	47.625	48.006	38.1	7	3.3	258	375	1800	2600	39.1	113	129	160	172	7	3.3	0.39	1.6	0.86	4.65
71412/71750	104.775	190.5	47.625	49.212	34.925	3.5	3.3	296	465	1800	2600	40.1	119	131	171	183	3.5	3.3	0.42	1.4	0.79	5.71
56413/56650	104.775	165.1	36.513	36.513	26.988	3.6	3.2	184	300	1900	2800	38.5	117	120	148	157	3.6	3.2	0.5	1.21	0.66	2.71
64413/64700	104.775	177.8	41.275	41.275	30.162	3.6	3.2	227	365	1900	2800	42.8	117	127	160	170	3.6	3.2	0.52	1.16	0.64	3.99
56418/56650	106.362	165.1	36.512	36.512	26.988	3.5	3.3	195	320	1900	2800	38.6	114	126	148	160	3.5	3.3	0.5	1.2	0.66	2.73
56418/56662	106.362	168.275	36.513	36.512	26.988	3.5	3.3	195	320	1900	2800	38.6	114	126	150	161	3.5	3.3	0.5	1.2	0.66	2.91
L521949R/L521910	107.95	146.05	21.432	21.432	16.67	1.6	1.6	86.4	167	1900	2800	26.2	116	119	134	139	1.6	1.6	0.39	1.53	0.84	0.99
37425/37625	107.95	158.75	23.02	21.438	15.875	3.5	3.3	102	165	1900	2800	37	115	124	143	152	3.5	3.3	0.61	0.99	0.54	1.37
LM522546/LM522510	107.95	159.987	34.925	34.925	26.988	3.5	3.3	164	315	1900	2800	33.7	117	126	145	154	3.5	3.3	0.4	1.5	0.82	2.43
48190/48120	107.95	161.925	34.925	34.925	26.988	3.5	3.3	164	280	1900	2800	38.7	115	126	145	157	3.5	3.3	0.51	1.2	0.65	2.42
56425/56650	107.95	165.1	36.512	36.512	26.988	3.5	3.3	195	320	1900	2800	38.6	115	127	148	160	3.5	3.3	0.5	1.2	0.66	2.66
56425/56662	107.95	168.275	36.512	36.512	26.988	3.5	3.3	195	320	1900	2800	38.6	115	127	150	161	3.5	3.3	0.5	1.2	0.66	2.83
67425/67675	107.95	171.45	34	30.163	25.268	3.6	3.2	177	254	1800	2600	39.3	120	124	153	161	3.6	3.2	0.47	1.27	0.7	2.63
71425/71750	107.95	190.5	47.625	49.212	34.925	3.5	3.3	296	465	1700	2400	40.1	121	133	171	183	3.5	3.3	0.42	1.4	0.79	5.5
71425/71753	107.95	191.975	47.625	49.213	34.925	3.6	3.2	303	483	1700	2400	40.9	120	131	168	177	3.6	3.2	0.42	1.44	0.79	5.58
935/930	107.95	206.375	66.675	66.675	53.975	13.5	3.2	450	674	1700	2400	47.6	135	140	181	193	13.5	3.2	0.33	1.84	1.01	9.62
936/930	107.95	206.375	66.675	66.675	53.975	7.9	3.2	450	674	1700	2400	47.6	129	135	181	193	7.9	3.2	0.33	1.84	1.01	9.69
HH224340/HH224310	107.95	212.725	66.675	66.675	53.975	8	3.3	570	810	1700	2400	47.3	122	142	191	206	8	3.3	0.33	1.8	1	10.6
936/932	107.95	212.725	66.675	66.675	53.975	8	3.3	475	700	1700	2400	46.9	121	140	187	201	8	3.3	0.33	1.8	1	10.7
37431/37625	109.538	158.75	23.02	21.438	15.875	6.4	6.4	104	169	1900	2800	36.5	120	122	142	148	6.4	6.4	0.61	0.99	0.54	1.33
937XA/932	109.9	212.725	66.675	74	53.975	SP	3.2	450	674	1800	2600	47.6	115	135	181	193	SP	3.2	0.33	1.84	1.01	10.7
71432/71750	109.952	190.5	47.625	49.212	34.925	3.5	3.3	296	465	1800	2600	40.1	122	134	171	183	3.5	3.3	0.42	1.4	0.79	5.37

EVERGLORY INDUSTRY CO., LIMITED

No. 29 Industrial Park North Road Wafangdian City Liaoning China

www.evergloryindustry.com

info@evergloryindustry.com

Tel / Whatsapp: 008613130008503



Bearing NO.	Boundary dimensions(mm)							Basic load ratings(kN)		Limiting speed(rpm)		Application point	Abutment and fillet dimensions(mm)						Value			Weight(kg)
	d	D	T	B	C	r _{1, 2min}	r _{3, 4min}	Cr	Cor	Grease	Oil		a	d _{a max}	d _{b min}	D _{a max}	D _{b min}	r _{a max}	r _{b max}	e	Y	
71432/71788	109.952	199.975	50	49.213	36.8	3.6	4	303	483	1800	2600	43.3	122	131	167	177	3.6	4	0.42	1.44	0.79	6.3
64432/64700	109.974	177.8	41.275	41.275	30.162	3.5	3.3	251	415	1800	2600	42	123	126	164	171	3	3	0.52	1.15	0.6	3.7
64432/64708	109.974	180	41.275	41.275	30.162	3.5	3.3	251	415	1800	2600	42	123	126	166	171	3	3	0.52	1.15	0.6	3.9
H924043/H924010	109.985	214.313	55.563	52.388	39.688	3.6	3.2	404	578	1800	2600	62.3	122	134	185	203	3.6	3.2	0.67	0.89	0.49	8.65
LM522548/LM522510	109.985	159.987	34.925	34.925	26.988	8	3.3	164	315	1900	2800	33.7	118	132	145	154	8	3.3	0.4	1.5	0.82	2.31
LM522549/LM522510	109.985	159.987	34.925	34.925	26.988	3.5	3.3	164	315	1900	2800	33.7	118	127	145	154	3.5	3.3	0.4	1.5	0.82	2.33
LM522549/LM522518	109.985	164.737	37.313	34.925	32.131	3.6	2.4	184	319	1800	2600	35.3	121	122	146	155	3.6	2.4	0.4	1.5	0.82	2.62
64433/64700	109.992	177.8	41.275	41.275	30.162	3.5	3.3	232	375	1800	2600	42.4	119	132	160	173	3.5	3.3	0.52	1.2	0.64	3.75
64433/64701X	109.992	178	41.275	41.275	30.163	3.6	3	227	365	1800	2600	42.8	122	127	160	170	3.6	3	0.52	1.16	0.64	3.73
64433/64708	109.992	180	41.275	41.275	30.162	3.5	3.3	232	375	1800	2600	42.4	123	126	166	171	3	3	0.52	1.15	0.6	3.9
JM822049/JM822010	110	165	35	35	26.5	3	2.5	195	320	1800	2600	38.1	116	127	149	160	3	2.5	0.5	1.2	0.66	2.48
JHM522649/JHM522610	110	180	47	46	38	3	2.5	310	490	1800	2600	40.9	118	131	162	174	3	2.5	0.41	1.5	0.81	4.62
71433X/71736	110	186.975	45	49.213	35.001	3.6	5.2	303	483	1800	2600	38.3	122	131	169	179	3.6	5.2	0.42	1.44	0.79	4.92
942/930	110	206.35	66.675	66.675	53.975	6.4	3.2	450	674	1800	2600	47.6	128	135	181	193	6.4	3.2	0.33	1.84	1.01	9.53
942/932	110	212.725	66.675	66.675	53.975	6.4	3.2	450	674	1800	2600	47.6	128	135	181	193	6.4	3.2	0.33	1.84	1.01	10.4
67434/67675	110.333	171.45	34	30.163	25.268	3.6	3.2	177	254	1800	2600	39.3	123	124	153	161	3.6	3.2	0.47	1.27	0.7	2.53
67437/67675	111.125	171.45	34	30.163	25.268	3.6	3.2	177	254	1800	2600	39.3	123	124	153	161	3.6	3.2	0.47	1.27	0.7	2.5
64437/64713	111.125	180.975	41.275	41.275	30.163	3.6	3.2	227	365	1800	2600	42.8	123	127	160	170	3.6	3.2	0.52	1.16	0.64	3.86
71437/71736	111.125	186.975	45	49.212	35.001	3.6	3.2	303	483	1800	2600	38.3	123	131	169	179	3.6	5.2	0.42	1.44	0.79	4.85
71437/71750	111.125	190.5	47.625	49.212	34.925	3.5	3.3	296	465	1800	2600	40.1	122	135	171	183	3.5	3.3	0.42	1.4	0.79	5.29
H924045/H924010	111.125	214.312	55.562	52.388	39.688	3.5	3.3	355	490	1800	2600	62.4	124	143	187	206	3.5	3.3	0.67	0.89	0.49	8.32
947/930	111.917	206.375	66.675	66.675	53.975	13.5	3.2	450	674	1800	2600	47.6	135	144	181	193	13.5	3.2	0.33	1.84	1.01	9.26
L623149/L623110	114.3	152.4	21.433	21.433	16.67	1.5	1.5	89.5	178	1800	2600	27.4	121	127	142	148	1.5	1.5	0.41	1.5	0.8	1.07
L623149/L623114	114.3	155.575	21.433	21.433	21.433	1.6	1.6	96.4	197	1800	2600	27.7	123	125	142	148.11.6		0.41	1.45	0.8	1.24	
64450/64700	114.3	177.8	41.275	41.275	30.162	3.5	3.3	232	375	1800	2600	42.4	122	135	160	173	3.5	3.3	0.52	1.2	0.64	3.5
64450/64701X	114.3	178	41.275	41.275	30.163	3.6	3	227	365	1800	2600	42.8	127	127	160	170	3.6	3	0.52	1.16	0.64	3.49
68450/68709	114.3	179.975	34.925	31.75	25.4	3.6	0.8	171	247	1800	2600	40.7	127	131	161	169	3.6	0.8	0.5	1.21	0.66	2.87
68450A/68709	114.3	179.975	34.925	31.75	25.4	3.6	0.8	171	247	1800	2600	40.7	127	131	161	169	3.6	0.8	0.5	1.21	0.66	2.87
64450/64708	114.3	180	41.275	41.275	30.162	3.5	3.3	232	375	1800	2600	42.4	122	135	166	171	3.5	3.3	0.52	1.2	0.64	3.8
68450/68709	114.3	180	34.925	31.75	25.4	3.5	0.8	174	254	1800	2600	40	124	134	165	173	3.5	0.8	0.5	1.2	0.66	2.95
68450/68712	114.3	180.975	34.925	31.75	25.4	3.5	3.3	174	254	1800	2600	40	124	134	163	174	3.5	3.3	0.5	1.2	0.66	2.93
71450/71736	114.3	186.975	45	49.212	35.001	3.6	5.2	303	483	1800	2600	38.3	127	131	169	179	3.6	5.2	0.42	1.44	0.79	4.64
71451/71736	114.3	186.975	45	49.212	35.001	3.6	5.2	303	483	1800	2600	38.3	127	131	169	179	3.6	5.2	0.42	1.44	0.79	4.64
71450/71750	114.3	190.5	47.625	49.212	34.925	3.5	3.3	296	465	1700	2400	40.1	124	135	171	183	3.5	3.3	0.42	1.4	0.79	5.07
71450/71753	114.3	192	47.625	49.212	34.925	3.5	3.3	296	465	1700	2400	40	124	136	178	178	3	3	0.42	1.4	0.79	5.4
938/930	114.3	206.375	66.675	66.675	53.975	7.1	3.2	450	674	1700	2400	47.6	134	135	181	193	7.1	3.2	0.33	1.84	1.01	9.13
HH224346/HH224310	114.3	212.725	66.675	66.675	53.975	7	3.3	475	700	1700	2400	47.3	125	144	191	206	7	3.3	0.33	1.8	1	10.1
938/932	114.3	212.725	66.675	66.675	53.975	7	3.3	475	700	1700	2400	46.9	124	142	187	201	7	3.3	0.33	1.8	1	10.1
HH224346/HH224310	114.3	212.725	66.675	66.675	53.975	7	3.3	512	765	1700	2400	47	132	136	201	202	6	3	0.33	1.8	1	10.5
HM926740/HM926710	114.3	228.6	53.975	49.428	38.1	3.5	3.3	375	530	1300	1800	67.7	133	152	201	223	3.5	3.3	0.74	0.81	0.45	9.52
97450/97900	114.3	228.6	53.975	49.428	38.1	3.5	3.3	330	475	1300	1800	67.5	131	151	198	219	3.5	3.3	0.74	0.82	0.45	9.52
HH926744/HH926710	114.3	273.05	82.55	82.55	53.975	6.4	6.4	685	870	1200	2000	77	134	162	234	261	6.4	6.4	0.63	0.95	0.52	21.8
EE514045/514110	114.3	279.4	82.55	82.55	53.975	6.4	6.4	660	909	1200	2000	77.8	132	159	228	252	6.4	6.4	0.65	0.92	0.51	24.2
HH926744/HH926716	114.3	279.4	82.55	82.55	53.975	6.4	6.4	685	870	1200	2000	77	134	162	237	264	6.4	6.4	0.63	0.95	0.52	23
64452/64700	114.976	177.8	41.275	41.275	30.162	3.6	3.2	227	365	1800	2600	42.8	127	127	160	170	3.6	3.2	0.52	1.16	0.64	3.43
64452A/64700	114.976	177.8	41.275	41.275	30.162	9	3.3	251	415	1800	2600	42	126	135	164	171	8	3	0.52	1.15	0.6	3.55
64452A/64708	114.976	180	41.275	41.275	30.162	9	3.3	251	415	1800	2600	42	126	135	166	171	8	3	0.52	1.15	0.6	3.75
HH224349/HH224310	114.976	212.725	66.675	66.675	53.975	7	3.3	570	810	1100	1600	47.3	125	144	191	206	7	3.3	0.33	1.8	1	10
64452/64700	115	177.8	41.275	41.275	30.162	3.5	3.3	232	375	1800	2600	42.4	122	135	160	173	3.5	3.3	0.52	1.2	0.64	3.46
71453/71736	115.087	186.975	45	49.212	35.001	3.6	5.2	303	483	1800	2600	38.3	127	131	169	179	3.6	5.2	0.42	1.44	0.79	4.58
71455/71736	115.087	186.975	45	49.212	35.001	7.9	5.2	303	483	1800	2600	38.3	131	136	169	179	7.9	5.2	0.42	1.44	0.79	4.55
71453/71750	115.087	190.5	47.625	49.212	34.925	3.5	3.3	296	465	1800	2600	40.1	124	137	171	183	3.5	3.3	0.42	1.4	0.79	5.02
71455/71750	115.087	190.5	47.625	49.212	34.925	7.9	3.2	303	483	1800	2600	40.9	131	136	168	177	7.9	3.2	0.42	1.44	0.79	4.97
HM124644/HM124618	117.373	195.263	53.975	57.15	44.45	1.6	3.2	365	599	1800	2600	35.9	126	136	173	181	1.6	3.2	0.26	2.27	1.25	6.36

EVERGLORY INDUSTRY CO., LIMITED

No. 29 Industrial Park North Road Wafangdian City Liaoning China

www.evergloryindustry.com

info@evergloryindustry.com

Tel / Whatsapp: 008613130008503



Bearing NO.	Boundary dimensions(mm)							Basic load ratings(kN)		Limiting speed(rpm)		Application point	Abutment and fillet dimensions(mm)						Value			Weight(kg)
	d	D	T	B	C	r _{1, 2min}	r _{3, 4min}	Cr	Cor	Grease	Oil		a	d _{a max}	d _{b min}	D _{a max}	D _{b min}	r _{a max}	r _{b max}	e	Y	
68462/68709	117.475	179.975	34.925	31.75	25.4	3.6	0.8	171	247	1800	2600	40.7	130	131	161	169	3.6	0.8	0.5	1.21	0.66	2.73
68463/68709	117.475	179.975	34.925	31.75	25.4	7.9	0.8	171	247	1800	2600	40.7	131	138	161	169	7.9	0.8	0.5	1.21	0.66	2.7
68462/68712	117.475	180.975	34.925	31.75	25.4	3.5	3.3	174	254	1800	2600	40	125	135	163	174	3.5	3.3	0.5	1.2	0.66	2.78
71464/71736	117.975	186.975	42.376	45	35.001	5.2	5.2	303	483	1800	2600	38.4	131	133	169	179	5.2	5.2	0.42	1.44	0.79	4.2
HM124646/HM124618	119.063	195.263	53.975	57.15	44.45	1.6	3.2	365	599	1700	2500	35.9	127	136	173	181	9.5	1.6	0.26	2.27	1.25	6.22
HM124649/HM124618	119.949	195.263	53.975	57.15	44.45	3	3.2	365	599	1700	2500	35.9	131	136	173	181	9.5	3	0.26	2.27	1.25	6.14
HM125943/HM125910	119.949	204.775	55.563	60.325	45.237	3.2	3.2	412	658	1700	2500	41.1	131	142	183	192	10.3	3.2	0.3	1.97	1.08	7.48
95471/95905	119.95	230	63.5	68.715	49.213	6.4	3.2	523	826	1700	2500	49.9	138	155	204	216	14.3	6.4	0.37	1.62	0.89	12
74472/74846X	119.964	215	47.625	47.625	34.925	3.5	3.3	287	495	1700	2500	48.4	140	153	195	208	3.5	3.3	0.49	1.2	0.68	7.33
74472/74850	119.964	215.9	47.625	47.625	34.925	3.5	3.3	287	495	1700	2500	48.4	140	153	195	209	3.5	3.3	0.49	1.2	0.68	7.42
L724348/L724310	119.975	166.688	25.4	25.4	19.05	3.2	3.2	137	229	1700	2500	32.9	130	131	154	160	3.2	3.2	0.46	1.31	0.72	1.57
M224748/M224711	119.975	172.242	35.72	36.513	27.783	3.6	1.6	208	362	1700	2500	32.1	132	133	159	166	3.6	1.6	0.33	1.8	0.99	2.58
M624649/M624610	119.975	179.975	36	36	26	3.6	1.6	212	348	1700	2500	35.6	132	134	164	171	3.6	1.6	0.41	1.45	0.8	3.02
HH228336/HH228310	119.975	254	77.788	82.55	61.913	4	6.4	717	1050	1700	2500	54	133	158	220	233	4	6.4	0.32	1.87	1.03	18.7
HH228336/HH228318	119.975	259.975	77.788	82.55	61.913	4	4	717	1050	1800	2600	54	133	158	220	233	4	4	0.32	1.87	1.03	19.9
JL724348/JL724314	120	170	25.4	25.4	19.05	3.3	3.3	130	219	1800	2600	32.9	127	135	155	164	3.3	3.3	0.46	1.3	0.72	1.67
M224748/M224710	120	174.625	35.72	36.512	27.783	3.5	1.5	212	385	1800	2600	32.2	126	137	162	169	3.5	1.5	0.33	1.8	0.99	2.76
74473X/74845	120	214.975	47.625	47.625	34.925	4	3.2	322	549	1800	2600	49.7	133	156	193	205	4	3.2	0.49	1.23	0.68	7.24
97472X/97905X	120	230	53.975	49.428	38.1	3.5	3.3	330	475	1800	2600	67.6	134	154	199	220	3.5	3.3	0.74	0.82	0.45	9.27
L624549/L624510	120.65	160.338	21.433	21.433	16.67	1.5	1.5	92.5	190	1800	2600	29.3	127	133	150	155	1.5	1.5	0.44	1.4	0.76	1.18
L724349/L724310	120.65	166.688	25.4	25.4	19.05	3.2	3.2	137	229	1800	2600	32.9	130	132	154	160	3.2	3.2	0.46	1.31	0.72	1.54
L225842/L225810	120.65	169.862	25.4	26.195	20.638	1.5	1.5	132	265	1800	2600	28	129	138	160	162	1	1	0.33	1.8	1	1.85
L724349/L724314	120.65	169.975	25.4	25.4	19.05	3.2	3.2	137	229	1800	2600	32.9	130	130	154	160	3.2	3.2	0.46	1.31	0.72	1.67
M224749/M224710	120.65	174.625	35.72	36.513	27.783	3.6	1.6	208	362	1800	2600	32.1	133	133	159	166	3.6	1.6	0.33	1.8	0.99	2.69
48282/48220	120.65	182.562	39.688	38.1	33.338	3.5	3.3	228	445	1700	2400	34.2	132	132	167	177	3.5	3.3	0.31	2	1.1	3.69
48282/48220XX	120.65	182.562	39.688	38.1	33.338	3.6	3.2	227	429	1700	2400	34.1	133	141	166	173	3.6	3.2	0.31	1.97	1.08	3.6
HM624749/HM624710	120.65	190.5	46.038	46.038	34.925	3.5	1.5	314	540	1700	2400	42	131	135	180	182	3	1	0.43	1.4	0.8	4.85
HM624749/HM624716	120.65	199.974	46.038	46.038	34.925	3.6	1.6	313	512	1700	2400	41.6	133	135	172	182	3.6	1.6	0.43	1.41	0.77	5.43
795/792	120.65	206.375	47.625	47.625	34.925	3.3	3.3	320	530	1700	2400	45.7	149	134	186	199	3.3	3.3	0.46	1.3	0.72	6.35
95475/95905	120.65	230	63.5	63.5	49.213	6.4	3.2	523	826	1600	2300	49.9	139	155	204	216	6.4	3.2	0.37	1.62	0.89	11.6
95475/95925	120.65	234.95	63.5	63.5	49.212	6.4	3.3	510	790	1600	2300	50.5	159	140	212	226	6.4	3.3	0.37	1.6	0.89	12.3
EE153044/153100	120.65	254	77.788	82.55	57.15	9.5	6.4	692	1010	1400	1900	51.1	145	156	217	230	9.5	6.4	0.32	1.87	1.03	18.4
HH228340/HH228310	120.65	254	77.788	82.55	61.913	9.7	6.4	675	975	1400	1900	55	163	140	223	242	9.7	6.4	0.34	1.8	0.97	18.4
HH228340/HH228315	120.65	258.763	77.788	82.55	61.912	9.5	6.4	717	1050	1400	1900	54	145	158	220	233	9.5	6.4	0.32	1.87	1.03	19.5
HH926749/HH926710	120.65	273.05	82.55	82.55	53.975	6.4	6.4	685	870	1300	1800	77	165	137	234	261	6.4	6.4	0.63	0.95	0.52	21
HH926749/HH926716	120.65	279.4	82.55	82.55	53.975	6.4	6.4	685	870	1300	1800	77	165	137	237	264	6.4	6.4	0.63	0.95	0.52	22.2
48286/48220	123.825	182.562	39.688	38.1	33.338	3.5	3.3	228	445	1300	1800	34.2	143	134	167	177	3.5	3.3	0.31	2	1.1	3.51
HM125948/HM125918	123.825	212.725	55.563	60.325	45.237	3.2	3.2	412	658	1300	1800	41.1	135	142	183	192	3.2	3.2	0.3	1.97	1.08	8.05
EE153049/153101	123.825	258.763	77.788	82.55	57.15	9.5	6.4	692	1010	1200	1700	51.1	148	156	217	230	9.5	6.4	0.32	1.87	1.03	18.8
HH228334/HH228318	123.825	259.975	77.788	82.55	61.913	9.5	4	717	1050	1200	1700	54	148	158	220	233	9.5	4	0.32	1.87	1.03	19.4
95491/95912	124.943	231.775	63.5	63.5	49.213	6.4	3.2	523	826	1200	1700	49.9	143	155	204	216	6.4	3.2	0.37	1.62	0.89	11.5
95491/95925	124.943	234.95	63.5	63.5	49.212	6.4	3.3	510	790	1200	1700	50.5	162	142	212	226	6.4	3.3	0.37	1.6	0.89	11.9
JL725346/JL725316	125	175	25.4	25.4	18.288	3.3	3.3	134	232	1200	1700	34.3	141	131	160	170	3.3	3.3	0.48	1.3	0.69	1.76
HM926745/HM926710	125.298	228.6	53.975	49.428	38.1	3.5	3.3	375	530	1800	2600	67.7	157	138	201	223	3.5	3.3	0.74	0.81	0.45	8.72
97493/97900	125.298	228.6	53.975	49.428	38.1	3.6	3.2	325	459	1800	2600	65.6	138	144	194	212	3.6	3.2	0.74	0.81	0.45	8.37
LL225748/LL225710	127	165.895	18.258	17.462	13.495	1.5	1.5	84.5	149	1800	2600	24.2	138	133	157	161	1.5	1.5	0.33	1.8	0.99	0.93
L225849/L225810	127	169.862	25.4	26.195	20.638	1.5	1.5	123	251	1800	2600	28.1	140	134	159	165	1.5	1.5	0.33	1.8	0.99	1.65
L225849/L225818	127	180.975	25.4	26.195	20.638	1.5	1.5	123	251	1700	2400	28.1	140	134	165	170	1.5	1.5	0.33	1.8	0.99	2.14
48290/48220	127	182.562	39.688	38.1	33.338	3.5	3.3	228	445	1700	2400	34.2	145	135	167	177	3.5	3.3	0.31	2	1.1	3.33
67388/67322	127	196.85	46.038	46.038	38.1	3.5	3.3	315	560	1600	2200	39.7	150	139	180	192	3.5	3.3	0.34	1.7	0.96	5.2
67388/67320	127	203.2	46.038	46.038	38.1	3.5	3.3	315	560	1600	2200	39.7	150	139	183	195	3.5	3.3	0.34	1.7	0.96	5.8
796x/793	127	206.375	47.625	47.625	34.925	3.6	3.2	326	548	1600	2200	45.7	139	146	183	194	3.6	3.2	0.46	1.31	0.72	5.93
798/792	127	206.375	47.625	50.013	34.925	3.2	3.2	326	548	1600	2200	45.7	138	146	183	194	3.3	3.2	0.46	1.31	0.72	6
74500/74850	127	215.9	47.625	47.625	34.925	3.5	3.3	287	495	1500	2000	48.4	157	143	195	209	3.5	3.3	0.49	1.2	0.68	6.91



EVERGLORY INDUSTRY CO., LIMITED

No. 29 Industrial Park North Road Wafangdian City Liaoning China

www.evergloryindustry.com

info@evergloryindustry.com

Tel / Whatsapp: 008613130008503

Bearing NO.	Boundary dimensions(mm)							Basic load ratings(kN)		Limiting speed(rpm)		Application point	Abutment and fillet dimensions(mm)						Value			Weight(kg)
	d	D	T	B	C	r _{1, 2min}	r _{3, 4min}	Cr	Cor	Grease	Oil		a	d _{a max}	d _{b min}	D _{a max}	D _{b min}	r _{a max}	r _{b max}	e	Y	
74500/74856	127	217.488	47.625	47.625	34.925	3.5	3.3	287	495	1500	2000	48.4	157	143	196	210	3.5	3.3	0.49	1.2	0.68	7.06
HM926747/HM926710	127	228.6	53.975	49.428	38.1	3.5	3.3	375	530	1500	2000	67.7	158	139	201	223	3.5	3.3	0.74	0.81	0.45	8.59
97500/97900	127	228.6	53.975	49.428	38.1	3.5	3.3	330	475	1500	2000	67.5	157	137	198	219	3.5	3.3	0.74	0.82	0.45	8.59
95500/95925	127	234.95	63.5	63.5	49.212	6.4	3.3	505	790	1500	2000	49.4	160	142	210	224	6.4	3.3	0.37	1.6	0.89	11.8
95502/95925	127	234.95	63.5	68.715	49.212	9.7	3.3	505	790	1500	2000	49.5	166	143	210	224	9.7	3.3	0.37	1.6	0.89	12
HM926747/HM926719	127	239.975	53.975	49.428	38.1	3.6	3.2	430	651	1500	2000	68.1	139	148	200	219	3.6	3.2	0.74	0.81	0.45	10.3
EE116050/116097	127	247.65	63.5	63.5	47.625	3.3	4.8	465	640	1500	2000	50.1	158	143	219	234	3.3	4.8	0.37	1.6	0.9	12.6
95500/95975	127	247.65	63.5	63.5	49.212	6.4	3.3	510	790	1500	2000	50.5	163	143	218	233	6.4	3.3	0.37	1.6	0.89	13.5
99500/99100	127	254	66.675	66.675	47.625	6.4	3.2	549	913	1400	1900	55	145	174	224	236	6.4	3.2	0.41	1.47	0.81	15.5
EE153050/153100	127	254	77.788	82.55	57.15	9.7	6.4	570	800	1400	1900	53.7	167	144	223	240	9.7	6.4	0.32	1.9	1	16.6
HH228349/HH228310	127	254	77.788	82.55	61.913	9.7	6.4	675	975	1400	1900	55	166	143	223	242	9.7	6.4	0.34	1.8	0.97	17.6
HH228348/HH228310	127	254	80.963	85.725	61.912	9.5	6.4	717	1050	1400	1900	54.1	151	158	220	233	9.5	6.4	0.32	1.87	1.03	18.1
EE153050/153102	127	260.35	77.788	82.55	57.15	9.5	6.4	692	1010	1400	1900	51.1	151	156	217	230	9.5	6.4	0.32	1.87	1.03	18.7
EE514050/514110	127	279.4	82.55	82.55	53.975	6.4	6.4	660	909	1400	1900	77.8	145	159	228	252	6.4	6.4	0.65	0.92	0.51	22.7
HH231637/HH231610	127	288.925	82.55	87.312	57.15	13.5	6.4	770	1010	1500	2000	56.3	179	151	258	275	13.5	6.4	0.32	1.9	1	24.3
EE540502/541162	127	295.275	82.55	87.313	57.15	13.5	6.4	765	1070	1500	2000	61.9	159	178	249	264	13.5	6.4	0.4	1.51	0.83	27.1
HH231637/HH231615	127	295.275	82.55	87.312	57.15	13.5	6.4	770	1010	1500	2000	56.3	179	151	261	278	13.5	6.4	0.32	1.9	1	25.6
EE750502/751200	127	304.8	60.325	61.912	41.275	6.4	6.4	635	780	1500	2000	49.2	174	158	271	285	6.4	6.4	0.33	1.8	0.99	21.4
EE516050/516120	127	304.8	88.9	82.55	57.15	6.4	6.4	652	896	1500	2000	91.9	145	179	252	280	6.4	6.4	0.73	0.82	0.45	29.2
HH932132/HH932110	127	304.8	88.9	82.55	57.15	6.4	6.4	745	1010	1500	2000	92.3	185	154	262	295	6.4	6.4	0.73	0.82	0.45	29.6
HM926749/HM926710	127.792	228.6	53.975	49.428	38.1	3.5	3.3	375	530	1600	2100	67.7	158	139	201	223	3.5	3.3	0.74	0.81	0.45	8.53
97503/97900	127.792	228.6	53.975	49.428	38.1	3.6	3.2	325	459	1600	2100	65.6	140	144	194	212	3.6	3.2	0.74	0.81	0.45	8.18
48506/48750	128.588	190.5	34.925	31.75	25.4	3.5	3.3	176	325	1700	2200	50.3	150	137	171	184	3.5	3.3	0.65	0.92	0.51	3.24
799/792	128.588	206.375	47.625	47.625	34.925	3.3	3.3	320	530	1700	2200	45.7	153	138	186	199	3.3	3.3	0.46	1.3	0.72	5.77
95514X/95926	129.967	234.95	63.5	68.715	49.213	3.2	3.2	523	826	1700	2200	49.9	141	155	204	216	3.2	3.2	0.37	1.62	0.89	11.6
95512/95925	129.975	234.95	63.5	63.5	49.213	6.4	3.2	523	826	1700	2200	49.9	148	155	204	216	6.4	3.2	0.37	1.62	0.89	11.4
797/792	130	206.375	47.625	47.625	34.925	3.5	3.3	320	530	1700	2200	45.7	153	139	186	199	3.5	3.3	0.46	1.3	0.72	5.66
74511X/74854	130	215.9	47.625	47.625	34.925	3.6	3.2	322	549	1700	2200	49.7	142	156	193	205	3.6	3.2	0.49	1.23	0.68	6.6
67389/67322	130.175	196.85	46.038	46.038	38.1	3.5	3.3	315	560	1700	2200	39.7	152	140	180	192	3.5	3.3	0.34	1.7	0.96	4.97
67389/67320	130.175	203.2	46.038	46.038	38.1	3.5	3.3	315	560	1700	2300	39.7	152	140	183	195	3.5	3.3	0.34	1.7	0.96	5.57
799A/792	130.175	206.375	47.625	47.625	34.925	3.5	3.3	320	530	1700	2300	45.7	154	139	186	199	3.5	3.3	0.46	1.3	0.72	5.65
48384X/48320XX	133.248	190.5	39.688	39.688	33.338	3.6	3.2	236	472	1700	2300	35.9	145	150	175	182	3.6	3.2	0.32	1.87	1.03	3.58
L327249/L327210	133.35	177.008	25.4	26.195	20.638	1.5	1.5	124	258	1700	2300	29.5	147	141	166	172	1.5	1.5	0.35	1.7	0.95	1.73
48385/48320	133.35	190.5	39.688	39.688	33.338	3.5	3.3	240	485	1700	2400	35.9	153	142	175	185	3.5	3.3	0.32	1.9	1	3.74
67390/67322	133.35	196.85	46.038	46.038	38.1	3.5	3.3	315	560	1600	2200	39.7	153	142	180	192	3.5	3.3	0.34	1.7	0.96	4.74
67391/67322	133.35	196.85	46.038	46.038	38.1	8	3.3	315	560	1600	2200	39.7	158	142	180	192	8	3.3	0.34	1.7	0.96	4.7
48385/48328	133.35	203.2	39.688	39.688	33.338	3.5	3.3	240	485	1600	2200	35.9	153	142	182	191	3.5	3.3	0.32	1.9	1	4.76
67390/67320	133.35	203.2	46.038	46.038	38.1	3.5	3.3	315	560	1600	2200	39.7	153	142	183	195	3.5	3.3	0.34	1.7	0.96	5.33
67391/67320	133.35	203.2	46.038	46.038	38.1	8	3.3	315	560	1600	2200	39.7	158	142	183	195	8	3.3	0.34	1.7	0.96	5.29
67390/67324	133.35	203.2	46.038	46.038	46.038	3.6	3.2	311	561	1600	2200	39.7	146	148	182	192	3.6	3.2	0.34	1.74	0.96	5.42
74525/74846X	133.35	215	47.625	47.625	34.925	3.5	3.3	287	495	1500	2000	48.4	160	147	195	208	3.5	3.3	0.49	1.2	0.68	6.34
74525/74850	133.35	215.9	47.625	47.625	34.925	3.5	3.3	287	495	1500	2000	48.4	160	147	195	209	3.5	3.3	0.49	1.2	0.68	6.42
74525/74856	133.35	217.488	47.625	47.625	34.925	3.5	3.3	287	495	1500	2000	48.4	160	147	196	210	3.5	3.3	0.49	1.2	0.68	6.57
95525/95925	133.35	234.95	63.5	63.5	49.212	9.7	3.3	510	790	1500	2000	50.5	169	146	212	226	9.7	3.3	0.37	1.6	0.89	11
95528/95925	133.35	234.95	63.5	63.5	49.212	4.8	3.3	510	790	1500	2000	50.5	164	146	212	226	4.8	3.3	0.37	1.6	0.89	11
95525/95928	133.35	234.975	63.5	63.5	49.212	9.7	3.3	510	790	1500	2000	50.5	169	146	212	227	9.7	3.3	0.37	1.6	0.89	11
95528/95928	133.35	234.975	63.5	63.5	49.212	4.8	3.3	510	790	1500	2000	50.5	164	146	212	227	4.8	3.3	0.37	1.6	0.89	11
95529X/95925	133.35	234.975	63.5	68.715	49.212	3.2	3.2	523	826	1500	2000	49.9	145	155	204	216	3.2	3.2	0.37	1.62	0.89	11.3
95525/95929	133.35	234.975	64.798	63.5	49.949	9.5	3.2	523	826	1500	2000	51.2	157	155	204	216	9.5	3.2	0.37	1.62	0.89	11.1
95527A/95975	133.35	247.65	63.5	63.5	49.213	13.2	3.2	523	826	1500	2000	49.9	165	155	204	216	13.2	3.2	0.37	1.62	0.89	12.8
95525/95975	133.35	247.65	63.5	63.5	49.212	9.7	3.3	510	790	1500	2000	50.5	169	146	218	233	9.7	3.3	0.37	1.6	0.89	12.8
95528/95975	133.35	247.65	63.5	63.5	49.212	4.8	3.3	510	790	1500	2000	50.5	164	146	218	233	4.8	3.3	0.37	1.6	0.89	12.9
74529/74853	134.975	215.9	53.975	47.625	47.625	3.6	3.2	322	549	1700	2400	56.1	147	156	193	209	3.6	3.2	0.49	1.23	0.68	6.92
LM328444/LM328410	136.525	187.325	28.575	29.37	23.02	1.6	1.6	178	323	1700	2400	31.7	14.7	151	175	181	1.6	1.6	0.35	1.69	0.93	2.24



EVERGLORY INDUSTRY CO., LIMITED

No. 29 Industrial Park North Road Wafangdian City Liaoning China

www.evergloryindustry.com

info@evergloryindustry.com

Tel / Whatsapp: 008613130008503

Bearing NO.	Boundary dimensions(mm)							Basic load ratings(kN)		Limiting speed(rpm)		Application point	Abutment and fillet dimensions(mm)						Value			Weight(kg)
	d	D	T	B	C	r _{1, 2min}	r _{3, 4min}	Cr	Cor	Grease	Oil		a	d _{a max}	d _{b min}	D _{a max}	D _{b min}	r _{a max}	r _{b max}	e	Y	
48393/48320	136.525	190.5	39.688	39.688	33.338	3.5	3.3	240	485	1700	2400	35.9	154	144	175	185	3.5	3.3	0.32	1.9	1	3.53
48393A/48320	136.525	190.5	39.688	39.688	33.338	5.5	3.3	246	500	1700	2400	35	151	140	176	182	5	3	0.33	1.8	1	3.3
48393/48328	136.525	203.2	39.688	39.688	33.338	3.6	3.2	236	472	1700	2400	35.9	149	150	175	182	3.6	3.2	0.32	1.87	1.03	4.38
74537/74846X	136.525	215	47.625	47.625	34.925	3.5	3.3	287	495	1700	2400	48.4	162	148	195	208	3.5	3.3	0.49	1.2	0.68	6.09
74537/74850	136.525	215.9	47.625	47.625	34.925	3.5	3.3	287	495	1700	2400	48.4	162	148	195	209	3.5	3.3	0.49	1.2	0.68	6.17
74537/74856	136.525	217.488	47.625	47.625	34.925	3.5	3.3	287	495	1700	2400	48.4	162	148	196	210	3.5	3.3	0.49	1.2	0.68	6.32
896/892	136.525	228.6	57.15	57.15	44.45	3.5	3.3	380	620	1600	2300	51.5	163	149	204	219	3.5	3.3	0.42	1.4	0.78	8.86
99537/99097	136.525	249.975	66.675	66.675	53.401	7.1	3	549	913	1600	2300	55	156	174	225	240	7.1	3	0.41	1.47	0.81	14.1
99537/99100	136.525	254	66.675	66.675	47.625	7	3.3	515	830	1600	2300	55.3	178	157	230	245	7	3.3	0.41	1.5	0.81	14.2
99540/99100	137.317	254	66.675	66.675	47.625	13.5	3.2	549	913	1600	2300	55	169	174	224	236	13.5	3.2	0.41	1.47	0.81	14.3
LL428349/LL428310	139.7	180.975	21.433	20.638	16.67	1.5	1.5	104	194	1600	2300	29.8	152	147	171	176	1.5	1.5	0.37	1.6	0.9	1.36
LM328448/LM328410	139.7	187.325	28.575	29.37	23.02	1.5	1.5	153	305	1600	2300	31.7	155	148	176	182	1.5	1.5	0.36	1.7	0.93	2.26
48680/48620	139.7	200.025	41.275	39.688	34.13	3.6	3.3	246	491	1500	2000	38.6	152	156	183	190	3.6	3.3	0.34	1.78	0.98	4.04
74550/74846X	139.7	215	47.625	47.625	34.925	3.5	3.3	287	495	1500	2000	48.4	163	150	195	208	3.5	3.3	0.49	1.2	0.68	5.83
74550A/74846X	139.7	215	47.625	47.625	34.925	6.4	3.3	287	495	1500	2000	48.4	166	150	195	208	6.4	3.3	0.49	1.2	0.68	5.81
74555/74846X	139.7	215	47.625	53.37	34.925	12.7	3.2	322	549	1500	2000	49.7	170	156	193	205	12.7	3.2	0.49	1.23	0.68	5.77
74550/74850	139.7	215.9	47.625	47.625	34.925	3.5	3.3	287	495	1500	2000	48.4	163	150	195	209	3.5	3.3	0.49	1.2	0.68	5.92
74550A/74850	139.7	215.9	47.625	47.625	34.925	6.4	3.2	322	549	1500	2000	49.7	158	156	193	205	6.4	3.2	0.49	1.23	0.68	5.82
73551/73875	139.7	222.25	34.925	31.623	23.812	3.5	3.3	191	267	1400	1900	41.6	162	152	203	211	3.5	3.3	0.44	1.4	0.75	4.25
898/892	139.7	228.6	57.15	57.15	44.45	3.5	3.3	380	620	1400	1900	51.5	165	151	204	219	3.5	3.3	0.42	1.4	0.78	8.55
898A/892	139.7	228.6	57.15	57.15	44.45	6.4	3.3	380	620	1400	1900	51.5	168	151	204	219	6.4	3.3	0.42	1.4	0.78	8.53
899/892	139.7	228.6	57.15	58.738	44.45	3.6	3.2	439	730	1400	1900	50.6	152	157	202	214	3.6	3.2	0.42	1.43	0.78	8.72
HM231132/HM231110	139.7	236.538	57.15	56.642	44.45	3.5	3.3	455	720	1400	1900	45.9	168	154	216	228	3.5	3.3	0.32	1.9	1	9.63
82550/82931	139.7	236.538	57.15	56.642	44.45	3.5	3.3	400	680	1400	1900	53.7	170	155	213	228	3.5	3.3	0.44	1.4	0.75	9.81
HM231133/HM231110	139.7	236.538	57.15	60.325	44.45	3.6	3.2	499	832	1400	1900	45.2	152	168	213	223	3.6	3.2	0.32	1.88	1.04	10.3
HM231132/HM231115	139.7	241.3	57.15	56.642	44.45	3.5	3.3	455	720	1400	1900	45.9	168	154	218	230	3.5	3.3	0.32	1.9	1	10.3
82550/82950	139.7	241.3	57.15	56.642	44.45	3.5	3.3	400	680	1400	1900	53.7	170	155	215	230	3.5	3.3	0.44	1.4	0.75	10.4
99550/99098X	139.7	250	66.675	66.675	47.625	7	3.3	515	830	1300	1800	55.3	179	158	228	243	7	3.3	0.41	1.5	0.81	13.2
99549/99098X	139.7	250	66.675	71.438	47.625	3.2	3.2	549	913	1300	1800	55	151	174	224	236	3.2	3.2	0.41	1.47	0.81	13.9
99550/99100	139.7	254	66.675	66.675	47.625	7	3.3	515	830	1300	1800	55.3	179	158	230	245	7	3.3	0.41	1.5	0.81	13.8
99550/99100S	139.7	254	66.675	66.675	47.625	7.1	3.2	549	913	1300	1800	55	159	174	224	236	7.1	3.2	0.41	1.47	0.81	14.1
EE107055/107105	139.7	268.288	74.613	74.613	57.15	6.4	6.4	658	1050	1300	1800	59.4	158	177	234	249	6.4	6.4	0.39	1.55	0.85	18.8
HH231649/HH231610	139.7	288.925	82.55	87.312	57.15	9.7	6.4	770	1010	1300	1800	56.3	182	158	258	275	9.7	6.4	0.32	1.9	1	22.6
EE540550/541162	139.7	295.275	82.55	87.313	57.15	9.5	6.4	765	1070	1300	1800	61.9	164	178	249	264	9.5	6.4	0.4	1.51	0.83	25.4
HH231649/HH231615	139.7	295.275	82.55	87.312	57.15	9.7	6.4	770	1010	1300	1800	56.3	182	158	261	278	9.7	6.4	0.32	1.9	1	23.9
EE75058/751200	139.7	304.8	60.325	61.913	41.275	3.2	6.4	599	800	1300	1800	49.8	151	192	258	268	3.2	6.4	0.33	1.8	0.99	20.3
EE750562/751200	139.7	304.8	60.325	61.913	41.275	6.4	6.4	599	800	1300	1800	49.8	158	192	258	268	6.4	6.4	0.33	1.8	0.99	20.3
HH234031/HH234010	139.7	307.975	88.9	93.662	66.675	9.7	6.8	885	1190	1300	1800	63.2	191	165	275	294	9.7	6.8	0.33	1.8	1	29.8
HH234032/HH234010	139.7	307.975	88.9	93.663	66.675	9.5	6.7	1020	1450	1300	1800	63.3	164	191	271	285	9.5	6.7	0.33	1.84	1.01	31.6
EE516055/516122	139.7	311.15	88.9	82.55	57.15	6.4	6.4	652	896	1300	1800	91.9	158	179	252	280	6.4	6.4	0.73	0.82	0.45	28.8
HH234031/HH234018	139.7	317.5	88.9	93.662	66.675	9.7	6.8	885	1190	1300	1800	63.2	191	165	279	298	9.7	6.8	0.33	1.8	1	32.2
74556/74846X	139.975	215	47.625	47.625	34.925	3.6	3.2	322	549	1200	1700	49.7	152	156	193	205	3.6	3.2	0.49	1.23	0.68	5.74
99553/99097	139.97	249.975	66.675	71.438	53.401	1.6	3	549	913	1200	1700	55	148	174	225	240	1.6	3	0.41	1.47	0.81	14
74551X/74846X	140	215	47.625	47.625	34.925	3.5	3.3	287	495	1600	2200	48.4	163	150	195	208	3.5	3.3	0.49	1.2	0.68	5.81
74551/74850	140	215.9	47.625	47.625	34.925	3.5	3.3	287	495	1600	2200	48.4	163	150	195	209	3.5	3.3	0.49	1.2	0.68	5.89
74551X/74856	140	217.488	47.625	47.625	34.925	3.5	3.3	287	495	1600	2200	48.4	163	150	196	210	3.5	3.3	0.49	1.2	0.68	6.04
36686/36620	142.875	193.675	28.575	28.575	23.02	1.6	1.6	187	375	1600	2200	33.7	151	157	180	186	1.6	1.6	0.37	1.63	0.9	2.41
48684/48620	142.875	200.025	41.275	39.688	34.13	8	3.3	227	460	1600	2200	37.6	167	153	185	195	8	3.3	0.34	1.8	0.98	3.77
48685/48620	142.875	200.025	41.275	39.688	34.13	3.5	3.3	227	460	1600	2200	37.6	162	153	185	195	3.5	3.3	0.34	1.8	0.98	3.81
48686/48620	142.875	200.025	41.275	42.863	34.13	3.6	3.3	246	491	1600	2200	38.6	155	156	183	190	3.6	3.3	0.34	1.78	0.98	3.89
73562/73875	142.875	222.25	34.925	31.623	23.813	3.6	3.2	209	302	1600	2200	41.9	155	163	198	205	3.6	3.2	0.44	1.37	0.75	3.2
HM231136/HM231110	142.875	236.538	57.15	56.642	44.45	3.5	3.3	455	720	1600	2200	45.9	170	156	216	228	3.5	3.3	0.32	1.9	1	9.32
82562/82931	142.875	236.538	57.15	56.642	44.45	3.5	3.3	400	680	1600	2200	53.7	171	156	213	228	3.5	3.3	0.44	1.4	0.75	9.5
HM231136/HM231115	142.875	241.3	57.15	56.642	44.45	3.5	3.3	455	720	1600	2200	45.9	170	156	218	230	3.5	3.3	0.32	1.9	1	9.94



EVERGLORY INDUSTRY CO., LIMITED

No. 29 Industrial Park North Road Wafangdian City Liaoning China

www.evergloryindustry.com

info@evergloryindustry.com

Tel / Whatsapp: 008613130008503

Bearing NO.	Boundary dimensions(mm)							Basic load ratings(kN)		Limiting speed(rpm)		Application point	Abutment and fillet dimensions(mm)						Value			Weight(kg)
	d	D	T	B	C	r _{1, 2min}	r _{3, 4min}	Cr	Cor	Grease	Oil		a	d _{a max}	d _{b min}	D _{a max}	D _{b min}	r _{a max}	r _{b max}	e	Y	
82562/82950	142.875	241.3	57.15	56.642	44.45	3.5	3.3	400	680	1600	2200	53.7	171	156	215	230	3.5	3.3	0.44	1.4	0.75	10.1
LL529749/LL529710	146.05	188.12	22.225	20.638	16.67	1.5	1.5	107	200	1600	2200	33.5	159	153	178	183	1.5	1.5	0.42	1.4	0.79	1.44
36690/36620	146.05	193.675	28.575	28.575	23.02	1.5	1.5	170	355	1600	2200	33.5	161	154	182	188	1.5	1.5	0.37	1.6	0.9	2.36
36691/36620	146.05	193.675	28.575	28.575	23.02	4.8	1.5	170	355	1400	1900	33.5	164	154	182	188	4.8	1.5	0.37	1.6	0.9	2.35
36690/36626	146.05	203.2	28.575	28.575	23.02	1.6	1.6	187	375	1400	1900	33.7	154	157	180	186	1.6	1.6	0.37	1.63	0.9	2.78
HM231140/HM231110	146.05	236.538	57.15	56.642	44.45	3.5	3.3	455	720	1400	1900	45.9	171	158	216	228	3.5	3.3	0.32	1.9	1	9
82576/82931	146.05	236.538	57.15	56.642	44.45	3.5	3.3	400	680	1400	1900	53.7	173	158	213	228	3.5	3.3	0.44	1.4	0.75	9.18
82576/82950	146.05	241.3	57.15	56.642	44.45	3.5	3.3	400	680	1400	1900	53.7	173	158	215	230	3.5	3.3	0.44	1.4	0.75	9.8
81575/81962	146.05	244.475	47.625	50.005	33.338	3.5	3.3	330	510	1400	1900	42.9	175	164	225	235	3.5	3.3	0.35	1.7	0.94	8.28
99575/99100	146.05	254	66.675	66.675	47.625	7	3.3	515	830	1400	1900	55.3	182	162	230	245	7	3.3	0.41	1.5	0.81	13.1
EE107057/107105	146.05	268.288	74.612	74.612	57.15	6.4	6.4	610	980	1400	1900	59.5	184	163	236	256	6.4	6.4	0.39	1.5	0.85	17.6
EE217056/217112	146.05	285.75	76.2	73.025	55.563	6.4	6.4	588	882	1400	1900	60.4	164	186	246	261	6.4	6.4	0.4	1.49	0.82	20
EE217064/217112	146.05	285.75	76.2	73.025	55.563	1.2	6.4	588	882	1400	1900	60.4	154	186	246	261	1.2	6.4	0.4	1.49	0.82	20.1
EE750573/751200	146.05	304.8	60.325	61.913	41.275	12.7	6.4	599	800	1000	1400	49.8	177	192	258	268	12.7	6.4	0.33	1.8	0.99	19.5
EE750576/751200	146.05	304.8	60.325	61.913	41.275	3.2	6.4	599	800	1000	1400	49.8	158	192	258	268	3.2	6.4	0.33	1.8	0.99	19.7
EE750577/751200	146.05	304.8	60.325	61.913	41.275	6.4	6.4	599	800	1000	1400	49.8	164	192	258	268	6.4	6.4	0.33	1.8	0.99	19.6
EE516057/516120	146.05	304.8	88.9	82.55	57.15	6.4	6.4	652	896	950	1400	91.9	164	179	252	280	6.4	6.4	0.73	0.82	0.45	26.5
HH932145/HH932110	146.05	304.8	88.9	82.55	57.15	6.4	6.4	745	1010	950	1400	92.3	195	164	262	295	6.4	6.4	0.73	0.82	0.45	27
EE450577/451212	146.05	307.975	88.9	93.662	61.912	9.7	6.8	745	1070	950	1400	61.5	196	171	271	289	9.7	6.8	0.33	1.8	1	28.8
HH234040/HH234010	146.05	307.975	88.9	93.662	66.675	9.7	6.8	885	1190	950	1400	63.2	194	168	275	294	9.7	6.8	0.33	1.8	1	28.7
HH932145/HH932115	146.05	311.15	88.9	82.55	57.15	6.4	6.4	791	1060	950	1400	92.1	164	177	260	288	6.4	6.4	0.73	0.82	0.45	28.3
HH932145/HH932115	146.05	311.15	88.9	82.55	57.15	6.4	6.4	745	1010	950	1400	92.3	195	164	265	298	6.4	6.4	0.73	0.82	0.45	28.3
HH234040/HH234018	146.05	317.5	88.9	93.662	66.675	9.7	6.8	885	1190	950	1400	63.2	194	168	279	298	9.7	6.8	0.33	1.8	1	31.2
HM231148/HM231110	149.225	236.538	57.15	56.642	44.45	6.4	3.3	455	720	1100	1500	45.9	176	159	216	228	6.4	3.3	0.32	1.9	1	8.65
HM231149/HM231110	149.225	236.538	57.15	56.642	44.45	3.5	3.3	455	720	1100	1500	45.9	173	159	216	228	3.5	3.3	0.32	1.9	1	8.68
82587/82931	149.225	236.538	57.15	56.642	44.45	3.5	3.3	400	680	1100	1500	53.7	175	160	213	228	3.5	3.3	0.44	1.4	0.75	8.85
HM231148/HM231115	149.225	241.3	57.15	56.642	44.45	6.4	3.3	455	720	1100	1500	45.9	176	159	218	230	6.4	3.3	0.32	1.9	1	9.27
HM231149/HM231115	149.225	241.3	57.15	56.642	44.45	3.5	3.3	455	720	1100	1500	45.9	173	159	218	230	3.5	3.3	0.32	1.9	1	9.3
82587/82950	149.225	241.3	57.15	56.642	44.45	3.5	3.3	400	680	1100	1500	53.7	175	160	215	230	3.5	3.3	0.44	1.4	0.75	9.47
99587/99098X	149.225	250	66.675	66.675	47.625	7.1	3.2	549	913	1100	1500	55	168	174	224	236	7.1	3.2	0.41	1.47	0.81	12.4
560990/561251	149.86	317.5	77.788	76.2	53.975	3.2	4.8	752	1100	1100	1500	69.7	177	201	271	287	3.2	4.8	0.46	1.29	0.71	25.1
99591/99100S	149.975	254	66.675	71.438	47.625	3.2	3.2	549	913	1100	1500	55	161	174	224	236	3.2	3.2	0.41	1.47	0.81	13.2
81590/81962X	150	244.475	47.498	50.005	41.275	3.6	3.2	322	494	1200	1600	41.7	162	177	221	230	3.6	3.2	0.35	1.72	0.95	8.02
81590/81962	150	244.475	47.625	50.005	33.338	3.5	3.3	330	510	1200	1600	42.9	177	166	225	235	3.5	3.3	0.35	1.7	0.94	7.92
99590X/99098X	150	250	66.675	66.675	47.625	7.1	3.2	549	913	1200	1600	55	169	174	224	236	7.1	3.2	0.41	1.47	0.81	12.3
EE560592/561251	150.698	317.5	77.788	76.2	53.975	17.5	4.8	752	1100	1100	1500	69.7	191	201	271	287	17.5	4.8	0.46	1.29	0.71	26.9
81593/81964	150.813	245	47.625	50.005	33.338	3.6	3.2	322	494	1200	1600	41.8	163	177	219	227	3.6	3.2	0.35	1.72	0.95	7.63
99599X/99098X	152.146	250	66.675	66.675	47.625	7.1	3.2	549	913	1200	1600	55	171	174	224	236	7.1	3.2	0.41	1.47	0.81	12.1
M231649/M231610	152.4	222.25	46.83	46.83	34.925	3.3	1.5	287	530	1500	2000	41.6	175	163	207	215	3.3	1.5	0.33	1.8	0.99	5.76
81600/81962	152.4	244.475	47.625	50.005	33.338	3.5	3.3	330	510	1500	2000	42.9	178	167	225	235	3.5	3.3	0.35	1.7	0.94	7.7
99600/99098X	152.4	250	66.675	66.675	47.625	7.1	3.2	549	913	1500	2000	55	172	174	224	236	7.1	3.2	0.41	1.47	0.81	12.1
99600/99100	152.4	254	66.675	66.675	47.625	7	3.3	515	830	1300	1800	55.3	185	165	230	245	7	3.3	0.41	1.5	0.81	12.3
99603/99100	152.4	254	66.675	71.438	47.625	1.6	3.2	549	913	1300	1800	55	161	174	224	236	1.6	3.2	0.41	1.47	0.81	12.8
HM234636/HM234610	152.4	266.7	66.675	71.438	50.8	6.4	3.2	602	993	1300	1800	52.6	170	188	240	252	6.4	3.2	0.34	1.78	0.98	15.6
EE107060/107105	152.4	268.288	74.612	74.612	57.15	6.4	6.4	610	980	1300	1800	59.5	187	166	236	256	6.4	6.4	0.39	1.5	0.85	16.7
107960/107105	152.4	268.288	74.613	77.788	57.15	6.4	6.4	658	1050	1300	1800	59.4	170	177	234	249	6.4	6.4	0.39	1.55	0.85	17.2
EE107060/107107	152.4	269.799	74.612	74.613	57.15	6.4	6.4	658	1050	1300	1800	59.4	170	177	234	249	6.4	6.4	0.39	1.55	0.85	17.4
EE217060/217112	152.4	285.75	76.2	73.025	55.563	1.6	6.4	588	882	1200	1600	60.4	161	186	246	261	1.6	6.4	0.4	1.49	0.82	19.2
EE450601/451212	152.4	307.975	88.9	93.662	61.912	9.7	6.8	745	1070	1200	1600	61.5	199	174	271	289	9.7	6.8	0.33	1.8	1	27.7
HH234048/HH234010	152.4	307.975	88.9	93.662	66.675	9.7	6.8	885	1190	1200	1600	63.2	197	171	275	294	9.7	6.8	0.33	1.8	1	27.6
HH234049/HH234010	152.4	307.975	88.9	93.663	66.675	9.5	6.7	1020	1450	1200	1600	63.3	176	191	271	285	9.5	6.7	0.33	1.84	1.01	29.4
HH234048/HH234018	152.4	317.5	88.9	93.662	66.675	9.7	6.8	885	1190	1200	1600	63.2	197	171	279	298	9.7	6.8	0.33	1.8	1	30.1
EE560600/561279	152.4	323.85	77.788	76.2	53.975	17.5	4.8	752	1100	1200	1600	69.7	192	201	271	287	17.5	4.8	0.46	1.29	0.71	28
81606/81962	153.988	244.475	47.625	50.005	33.338	3.5	3.3	330	510	1300	1800	42.9	179	168	225	235	3.5	3.3	0.35	1.7	0.94	7.55

EVERGLORY INDUSTRY CO., LIMITED

No. 29 Industrial Park North Road Wafangdian City Liaoning China

www.evergloryindustry.com

info@evergloryindustry.com

Tel / Whatsapp: 008613130008503

Bearing NO.	Boundary dimensions(mm)							Basic load ratings(kN)		Limiting speed(rpm)		Application point	Abutment and fillet dimensions(mm)						Value			Weight(kg)
	d	D	T	B	C	r _{1, 2min}	r _{3, 4min}	Cr	Cor	Grease	Oil		a	d _{a max}	d _{b min}	D _{a max}	D _{b min}	r _{a max}	r _{b max}	e	Y	
81606/81962	153.988	244.475	47.625	50.005	33.338	3.6	3.2	322	494	1300	1800	41.8	166	177	219	227	3.6	3.2	0.35	1.72	0.95	7.29
H936340/H936310	155.575	330.2	85.725	79.375	53.975	6.4	6.4	760	1060	1200	1600	103.3	209	178	283	317	6.4	6.4	0.81	0.74	0.41	32.5
H936340/H936316	155.575	342.9	85.725	79.375	53.975	6.4	6.4	760	1060	1200	1600	103.3	209	178	289	323	6.4	6.4	0.81	0.74	0.41	35.3
L432348/L432310	158.75	205.583	23.812	23.812	18.258	4.8	1.5	138	280	1500	2000	33	176	173	198	197	4.4	1.5	0.37	1.6	0.9	1.9
L432348/L432310XX	158.75	205.583	23.813	23.813	18.258	4.8	1.6	131	253	1500	2000	33.4	173	172	193	197	4.8	1.6	0.37	1.6	0.88	1.86
L432349/L432310	158.75	205.583	23.812	23.812	18.258	1.5	1.5	127	249	1500	2000	33.9	173	167	195	200	1.5	1.5	0.39	1.5	0.84	1.99
46780/46720	158.75	225.425	41.275	39.688	33.338	3.5	3.3	240	540	1400	1900	44.3	183	172	208	219	3.5	3.3	0.38	1.6	0.86	5.34
EE217062X/217112	158.75	285.75	76.2	73.025	55.563	13.5	6.4	588	882	1400	1900	60.4	191	186	246	261	13.5	6.4	0.4	1.49	0.82	18.2
EE280626/281200	158.75	304.8	66.675	69.106	42.863	6.4	3.2	548	802	1400	1900	54.4	177	211	271	282	6.4	3.2	0.36	1.67	0.92	20
HM234643/HM234612	159.512	266.7	66.675	71.438	50.8	1.6	3.2	602	993	1400	1900	52.6	168	188	240	252	1.6	3.2	0.34	1.78	0.98	14.6
EE560629/561251	159.918	317.5	77.788	76.2	53.975	10.4	4.8	752	1100	1400	1900	69.7	186	201	271	287	10.4	4.8	0.46	1.29	0.71	25.8
81630/81962	159.951	244.475	47.625	46.83	33.338	3.6	3.2	322	494	1400	1900	41.8	172	177	219	227	3.6	3.2	0.35	1.72	0.95	6.62
81629/81962	159.951	244.475	47.625	50.005	33.338	3.5	3.3	330	510	1400	1900	42.9	182	171	225	235	3.5	3.3	0.35	1.7	0.94	6.97
JM734445/JM734410	160	240	46	44.501	37	3	2.5	353	666	1400	1900	50.1	171	184	221	231	3	2.5	0.44	1.37	0.75	7.19
HM237532/HM237510	160.323	288.925	63.5	63.5	47.625	7	3.3	615	935	1300	1800	52.7	202	183	266	278	7	3.3	0.32	1.9	1	17
EE560631X/561251	160.338	317.5	77.788	76.2	53.975	11.2	4.8	752	1100	1300	1800	69.7	188	201	271	287	11.2	4.8	0.46	1.29	0.71	25.7
81637/81962	161.925	244.475	47.625	46.83	33.338	3.5	3.3	330	510	1300	1800	42.9	183	172	225	235	3.5	3.3	0.35	1.7	0.94	6.67
EE590638/591326	161.925	336.55	79.375	80.963	53.975	6.4	6.4	757	1100	1300	1800	75.7	180	213	286	303	6.4	6.4	0.49	1.22	0.67	30.7
590938/591326	161.925	336.55	79.375	80.963	53.975	6.4	6.4	757	1100	1300	1800	75.7	180	213	286	303	6.4	6.4	0.49	1.22	0.67	30.7
EE117063/117148	161.925	374.65	87.312	79.375	60.325	6.4	3.3	855	1090	1300	1800	98.6	217	188	325	355	6.4	3.3	0.71	0.85	0.47	42.2
HM237537/HM237510	164.975	288.925	63.5	68	47.625	7.1	3.2	628	973	1300	1800	52.2	184	203	260	270	7.1	3.2	0.32		1.04	16.7
L43749L/433710	165.1	215.9	26.195	26.195	20.638	1.5	1.5	154	295	1400	1900	34.5	180	173	204	210	1.5	1.5	0.36	1.7	0.91	2.45
46790/46720	165.1	225.425	41.275	39.688	33.338	3.5	3.3	240	540	1400	1900	44.3	186	175	208	219	3.5	3.3	0.38	1.6	0.86	4.84
67780/67720	165.1	247.65	47.625	47.625	38.1	3.5	3.3	345	705	1400	1900	52.4	194	180	228	241	3.5	3.3	0.44	1.4	0.75	8.16
86650/86100	165.1	254	46.038	46.038	33.338	4.8	3.3	340	535	1400	1900	44.9	191	178	235	246	4.8	3.3	0.37	1.6	0.89	7.56
M235145/M235113	165.1	254	465.038	46.038	33.338	4.8	3.3	370	595	1400	1900	41.9	191	178	235	245	4.8	3.3	0.32	1.9	1	7.72
M235144/M235113	165.1	254	49.213	52.388	33.338	4.8	3.2	378	620	1400	1900	41.6	180	191	232	239	4.8	3.2	0.32	1.88	1.04	8.34
HM235148/HM235118	165.1	260.35	53.975	58.738	41.275	1.6	3.2	467	812	1400	1900	45	173	189	232	241	1.6	3.2	0.32	1.88	1.04	10.6
HM234648/HM234610	165.1	266.7	66.675	71.438	50.8	1.6	3.2	602	993	1400	1900	52.6	173	188	240	252	1.6	3.2	0.34	1.78	0.98	13.9
HM237535/HM237510	165.1	288.925	63.5	63.5	47.625	7	3.3	615	935	1300	1800	52.7	204	185	266	278	7	3.3	0.32	1.9	1	16.4
HM237536/HM237511	165.1	288.925	63.5	63.5	47.625	7.1	3.2	628	973	1300	1800	52.2	184	203	260	270	7.1	3.2	0.32	1.88	1.04	16.4
94649/94113	165.1	288.925	63.5	63.5	47.625	7	3.3	545	940	1300	1800	62.6	206	185	261	277	7	3.3	0.47	1.3	0.7	17.2
94650/94113A	165.1	288.925	63.5	63.5	47.625	7.1	3.2	550	960	1300	1800	63.2	184	203	255	270	7.1	3.2	0.47	1.28	0.7	17
HM237534/HM237511	165.1	288.925	63.5	68.263	47.625	3.2	3.2	628	973	1300	1800	52.2	177	203	260	270	3.2	3.2	0.32	1.88	1.04	16.8
HM237535/HM237513	165.1	289.975	63.5	63.5	48	7.1	3	628	973	1300	1800	52.2	184	203	260	270	7.1	3	0.32	1.88	1.04	16.6
EE219065/219117	165.1	298.45	82.55	82.55	63.5	6.4	6.4	716	1130	1300	1800	67	183	202	264	280	6.4	6.4	0.38	1.59	0.88	23.4
94649/94118	165.1	298.45	63.5	63.5	47.625	7	3.3	545	940	1300	1800	62.6	206	185	265	282	7	3.3	0.47	1.3	0.7	18.8
EE219065/219122	165.1	311.15	82.55	82.55	63.5	6.4	6.4	770	1230	1200	1600	65.8	206	185	274	295	6.4	6.4	0.38	1.6	0.88	26.3
H238140/H238110	165.1	311.15	82.55	82.55	65.088	6.4	6.4	835	1280	1200	1600	63.9	208	187	279	298	6.4	6.4	0.33	1.8	1	26.5
EE560650/561251	165.1	317.5	77.788	76.2	53.975	3.2	4.8	752	1100	1200	1600	69.7	177	201	271	287	3.2	4.8	0.46	1.29	0.71	25.1
560950/561251	165.1	317.5	77.788	76.2	53.975	3.2	4.8	752	1100	1200	1600	69.7	177	201	271	287	3.2	4.8	0.46	1.29	0.71	25.1
560950/561279	165.1	323.85	77.788	76.2	53.975	3.2	4.8	752	1100	1200	1600	69.7	177	201	271	287	3.2	4.8	0.46	1.29	0.71	26.4
EE590650/591326	165.1	336.55	79.375	80.962	53.975	17.5	6.4	757	1100	1200	1600	75.7	205	213	286	303	17.5	6.4	0.49	1.22	0.67	30
HH437549/HH437510	165.1	336.55	92.075	95.25	69.85	3.3	6.4	990	1380	1100	1400	70.8	206	185	297	320	3.3	6.4	0.37	1.6	0.89	35
EE590649/591350	165.1	342.9	79.375	80.962	53.975	1.2	6.4	757	1100	1100	1400	75.7	173	213	286	303	1.2	6.4	0.49	1.22	0.67	31.7
EE420651/421417	165.1	360	92.075	88.897	63.5	9.7	3.3	875	1340	1100	1400	78.9	234	208	329	349	9.7	3.3	0.42	1.4	0.79	42.1
EE108065/108142	165.1	361.95	106.362	104.775	76.2	13.5	3.3	1240	1690	1100	1400	73.4	220	188	323	342	13.5	3.3	0.33	1.8	0.99	48.5
46792R/46720	166.688	225.425	41.275	39.688	33.338	3.6	3.2	258	568	1300	1800	4	179	181	207	215	3.6	3.2	0.38	1.57	0.86	4.46
46792/46720	166.688	225.425	41.275	39.688	33.338	3.5	3.3	240	540	1300	1800	44.3	187	176	208	219	3.5	3.3	0.38	1.6	0.86	4.71
M235147X/M235113	167.945	254	49.213	53.975	33.338	4.8	3.2	378	620	1300	1800	41.6	183	191	232	239	4.8	3.2	0.32	1.88	1.04	8.1
67782/67720	168.275	247.65	47.625	47.625	38.1	3.5	3.3	345	705	1300	1800	52.4	195	182	228	241	3.5	3.3	0.44	1.4	0.75	7.85
M235147/M235113	168.275	254	46.038	50.8	33.338	3.2	3.2	378	620	1300	1800	41.5	180	191	232	239	3.2	3.2	0.32	1.88	1.04	7.79
H936349/H936310	168.275	330.2	85.725	79.375	53.975	6.4	6.4	760	1060	1300	1800	103.3	216	184	283	317	6.4	6.4	0.81	0.74	0.41	30.5
H936349/H936316	168.275	342.9	85.725	79.375	53.975	6.4	6.4	760	1060	1300	1800	103.3	216	184	289	323	6.4	6.4	0.81	0.74	0.41	33.3



EVERGLORY INDUSTRY CO., LIMITED

No. 29 Industrial Park North Road Wafangdian City Liaoning China

www.evergloryindustry.com

info@everglory

Bearing NO.	Boundary dimensions(mm)							Basic load ratings(kN)		Limiting speed(rpm)		Application point	Abutment and fillet dimensions(mm)						Value			Weight(kg)
	d	D	T	B	C	r _{1, 2min}	r _{3, 4min}	Cr	Cor	Grease	Oil		a	d _{a max}	d _{b min}	D _{a max}	D _{b min}	r _{a max}	r _{b max}	e	Y	
HM535347/HM535310	169.977	260.35	66.675	66.675	52.388	3.6	3.2	538	1030	1300	1800	58	182	189	234	248	3.6	3.2	0.4	1.49	0.82	12.4
94669/94118	169.984	298.45	63.5	63.5	47.625	7.1	3.2	550	960	1300	1800	63.2	189	203	25	270	7.1	3.2	0.47	1.28	0.7	18
JHM534149/JHM534110	170	230	39	38	31	3	2.5	278	520	1300	1800	43.2	188	177	215	225	3	2.5	0.38	1.6	0.86	4.41
JM734449/JM734410	170	240	46.038	44.5	37	3	2.5	380	720	1300	1800	50.5	191	178	222	234	3	2.5	0.44	1.4	0.75	6.44
M235149/M235113	170	254	46.038	46.038	33.338	4.8	3.3	370	595	1300	1800	41.9	194	180	235	245	4.8	3.3	0.32	1.9	1	7.26
86669/86100	170	254	46.038	46.038	33.338	4.8	3.3	340	535	1300	1800	44.9	194	181	235	246	4.8	3.3	0.37	1.6	0.89	7.09
86669/86105	170	266.7	46.038	46.038	33.338	4.8	1.6	336	531	1300	1800	44.9	185	189	230	238	4.8	1.6	0.37	1.63	0.9	8.36
L435049/L435010	171.45	222.25	25.4	24.608	19.05	1.6	1.6	157	299	1300	1800	36	180	185	208	213	1.6	1.6	0.38	1.6	0.88	2.33
HM535349/HM535310	171.45	260.35	66.675	66.675	52.388	3.5	3.3	540	1030	1300	1800	57.6	198	182	236	252	3.5	3.3	0.4	1.5	0.82	12.5
HM237540/HM237510	171.45	288.925	63.5	63.5	47.625	7.1	3.2	628	973	1200	1600	52.2	191	203	260	270	7.1	3.2	0.32	1.88	1.04	15.5
94675/94113A	171.45	288.925	63.5	63.5	47.625	7.1	3.2	550	960	1200	1600	63.2	191	203	255	270	7.1	3.2	0.47	1.28	0.7	16.2
94675/94113	171.45	288.925	63.5	63.5	47.625	7	3.3	545	940	1200	1600	62.6	209	189	261	277	7	3.3	0.47	1.3	0.7	16.3
94675/94118	171.45	298.45	63.5	63.5	47.625	7	3.3	545	940	1200	1600	62.6	209	189	265	282	7	3.3	0.47	1.3	0.7	18
EE590675/591326	171.45	336.55	79.375	80.963	53.975	6.4	6.4	757	1100	1100	1600	75.7	189	213	286	303	6.4	6.4	0.49	1.22	0.67	29.2
EE590675/591350	171.45	342.9	79.375	80.963	53.975	6.4	6.4	757	1100	1100	1600	75.7	189	213	286	303	6.4	6.4	0.49	1.22	0.67	30.6
590977/591350	171.45	342.9	79.375	84.138	53.975	1.2	6.4	757	1100	1100	1600	75.7	179	213	286	303	1.2	6.4	0.49	1.22	0.67	30.9
EE117067/117148	171.45	374.65	87.313	79.375	60.325	6.4	3.2	868	1220	1100	1600	103.7	189	218	308	338	6.4	3.2	0.73	0.82	0.45	42.2
67786/67720	174.625	247.65	47.625	47.625	38.1	7.9	3.2	346	701	1100	1600	52.3	195	192	227	238	7.9	3.2	0.44	1.36	0.75	6.93
67787/67720	174.625	247.65	47.625	47.625	38.1	3.5	3.3	345	705	1100	1600	52.4	199	185	228	241	3.5	3.3	0.44	1.4	0.75	7.21
M236845/M236810	174.625	260.35	53.975	53.975	41.275	3.6	3.2	442	821	1100	1600	48.4	187	198	238	247	3.6	3.2	0.33	1.8	0.99	9.31
HM237542/HM237510	174.625	288.925	63.5	63.5	47.625	7	3.3	615	935	1100	1600	52.7	209	190	266	278	7	3.3	0.32	1.9	1	15.2
94687/94113	174.625	288.925	63.5	63.5	47.625	7	3.3	545	940	1100	1600	62.6	211	190	261	277	7	3.3	0.47	1.3	0.7	15.9
94687/94113A	174.625	288.925	63.5	63.5	47.625	7.1	3.2	550	960	1100	1600	63.2	194	203	255	270	7.1	3.2	0.47	1.28	0.7	15.8
94687/94118	174.625	298.45	63.5	63.5	47.625	7	3.3	545	940	1100	1600	62.6	211	190	265	282	7	3.3	0.47	1.3	0.7	17.5
EE219068/219117	174.625	298.45	82.55	82.55	63.5	6.4	6.4	795	1290	1100	1600	66.4	211	190	267	288	6.4	6.4	0.38	1.6	0.88	22.1
EE219068/219122	174.625	311.15	82.55	82.55	63.5	6.4	6.4	716	1130	1000	1500	67	192	202	264	280	6.4	6.4	0.38	1.59	0.88	24.7
H238148/H238110	174.625	311.15	82.55	82.55	65.088	6.4	6.4	835	1280	1000	1500	63.9	212	191	279	298	6.4	6.4	0.33	1.8	1	24.9
EE607071/607140	177.292	355.6	79.375	77.788	53.975	6.4	6.4	754	1090	1000	1500	83.8	195	228	305	324	6.4	6.4	0.55	1.1	0.6	32.8
LL735449/LL735410	177.8	215.9	20.638	20.638	15.083	1.5	1.5	109	241	1200	1600	38.5	190	184	206	211	1.5	1.5	0.45	1.3	0.73	1.51
36990/36920	177.8	227.012	30.162	30.162	23.02	1.5	1.5	181	415	1300	1800	42.9	193	185	214	222	1.5	1.5	0.44	1.4	0.75	3.01
67790/67720	177.8	247.65	47.625	47.625	38.1	3.5	3.3	345	705	1300	1800	52.4	200	186	228	241	3.5	3.3	0.44	1.4	0.75	6.88
67791/67720	177.8	247.65	47.625	47.625	38.1	10.4	3.3	345	705	1300	1800	52.4	207	186	228	241	10.4	3.3	0.44	1.4	0.75	6.79
M236848/M236810	177.8	260.35	53.975	53.975	41.275	7.9	3.2	442	821	1300	1800	48.4	199	198	238	247	7.9	3.2	0.33	1.8	0.99	8.9
M236849/M236810	177.8	260.35	53.975	53.975	41.275	3.5	3.3	455	835	1200	1700	47.5	201	189	241	252	3.5	3.3	0.33	1.8	0.99	9.35
M238840/M238810	177.8	269.875	55.562	55.562	42.862	3.5	3.3	465	875	1200	1700	51.1	208	194	250	262	3.5	3.3	0.35	1.7	0.95	11.1
82680X/82620	177.8	279.4	61.913	61.913	43.655	3.2	3.2	483	821	1200	1700	65.6	189	201	251	267	3.2	3.2	0.52	1.14	0.63	12.8
EE91702/91112	177.8	285.75	63.5	63.5	41.275	6.4	3.3	450	725	1200	1700	58.9	210	193	260	274	6.4	3.3	0.43	1.4	0.77	13.7
HM237545/HM237510	177.8	288.925	63.5	63.5	47.625	7	3.3	615	935	1200	1700	52.7	210	191	266	278	7	3.3	0.32	1.9	1	14.7
94700/94113	177.8	288.925	63.5	63.5	47.625	7	3.3	545	940	1200	1700	62.6	213	192	261	277	7	3.3	0.47	1.3	0.7	15.5
94700/94113A	177.8	288.925	63.5	63.5	47.625	7.1	3.2	550	960	1200	1700	63.2	197	203	255	270	7.1	3.2	0.47	1.28	0.7	15.3
HM237545/HM237513	177.8	289.974	63.5	63.5	48	7	3	680	1070	1200	1700	62.6	205	194	267	272	7	3	0.32	1.88	1.04	14.6
HM237543/HM237513	177.8	289.975	63.5	68.263	48	3.2	3	628	973	1200	1700	52.2	189	203	260	270	3.2	3	0.32	1.88	1.04	15.2
280970/281200	177.8	304.8	60.325	63.5	42.863	1.6	3.2	548	802	1100	1500	54.4	186	211	271	282	1.6	3.2	0.36	1.67	0.92	16.4
EE280702/281202	177.8	304.8	66.675	69.106	42.863	6.4	3.2	548	802	1100	1500	54.4	196	211	271	282	6.4	3.2	0.36	1.67	0.92	17.3
EE280702/281200	177.8	304.8	66.675	69.106	42.862	6.4	3.3	555	810	1100	1500	54.3	214	196	280	292	6.4	3.3	0.36	1.7	0.92	17.4
H238147/H238110	177.8	311.15	82.55	85.725	65.088	6.4	6.4	862	1340	1100	1500	64.3	196	207	273	288	6.4	6.4	0.33	1.82	1	24.9
EE222070/222126	177.8	319.964	88.9	85.725	65.088	3.5	4.8	790	1300	1100	1500	72.6	218	199	287	307	3.5	4.8	0.4	1.5	0.83	28.4
H239640/H239610	177.8	319.964	88.9	85.725	65.088	3.5	4.8	855	1270	1100	1500	66.3	215	197	292	309	3.5	4.8	0.32	1.9	1	26.9
EE222070/222128	177.8	320.675	88.9	85.725	65.088	3.5	4.8	790	1300	1100	1500	72.6	218	199	287	308	3.5	4.8	0.4	1.5	0.83	28.6
H239640/H239612	177.8	320.675	88.9	85.725	65.088	3.5	4.8	855	1270	1100	1500	66.3	215	197	292	309	3.5	4.8	0.32	1.9	1	27
EE470078/470128	177.8	327.025	90.488	92.075	63.5	6.4	6.4	930	1500	1000	1500	68.6	223	200	294	315	6.4	6.4	0.37	1.6	0.9	31
EE470078X/470128	177.8	327.025	90.488	92.075	63.5	9.5	6.4	864	1430	1000	1500	68.3	202	224	290	305	9.5	6.4	0.37	1.63	0.9	31
470978/470128	177.8	327.025	90.488	92.075	63.5	6.4	6.4	864	1430	1000	1500	68.3	196	224	290	305	6.4	6.4	0.37	1.63	0.9	31.1
590900/591326	177.8	336.55	79.375	80.963	53.975	3.2	6.4	757	1100	1000	1500	75.7	189	213	286	303	3.2	6.4	0.49	1.22	0.67	28.1

EVERGLORY INDUSTRY CO., LIMITED

No. 29 Industrial Park North Road Wafangdian City Liaoning China

www.evergloryindustry.com

info@evergloryindustry.com

Tel / Whatsapp: 008613130008503



Bearing NO.	Boundary dimensions(mm)							Basic load ratings(kN)		Limiting speed(rpm)		Application point	Abutment and fillet dimensions(mm)						Value			Weight(kg)
	d	D	T	B	C	r _{1, 2min}	r _{3, 4min}	Cr	Cor	Grease	Oil		a	d _{a max}	d _{b min}	D _{a max}	D _{b min}	r _{a max}	r _{b max}	e	Y	
EE470073/470132	177.8	336.55	90.488	92.075	63.5	13.5	6.4	864	1430	1000	1500	68.3	210	224	290	305	13.5	6.4	0.37	1.63	0.9	33.4
EE607070/607140	177.8	355.6	79.375	77.788	53.975	6.4	6.4	754	1090	1000	1500	83.8	196	228	305	324	6.4	6.4	0.55	1.1	0.6	32.7
EE420701/421417	177.8	360	92.075	88.897	63.5	12.7	3.2	938	1460	1000	1500	75.6	208	243	317	334	12.7	3.2	0.4	1.49	0.82	40.5
EE420701/421437	177.8	365.049	92.075	88.897	63.5	12.7	3.3	875	1340	1000	1500	78.9	243	214	332	351	12.7	3.3	0.42	1.4	0.79	41.1
EE420701/421450	177.8	368.3	92.075	88.897	63.5	12.7	3.3	875	1340	1000	1500	78.9	243	214	333	353	12.7	3.3	0.42	1.4	0.79	42
EE350701/351687	177.8	428.625	106.362	95.25	61.912	6.4	6.4	1070	1390	1000	1500	118.7	196	237	350	382	6.4	6.4	0.76	0.79	0.44	64.6
M336948/M336912	178.595	265.112	51.595	57.15	38.895	3.3	3.3	495	880	1200	1700	47	194	196	250	251	3	3	0.33	1.8	1	9.6
M336949/M336912	179.934	265.112	51.595	57.15	38.895	3.3	3.3	495	880	1200	1700	47	194	196	250	251	3	3	0.33	1.8	1	9.6
93708/93125	179.972	317.5	63.5	63.5	46.038	3.5	3.3	575	1060	1200	1700	71	224	206	288	306	3.5	3.3	0.52	1.1	0.63	21.2
93708/93126	179.972	317.5	68.262	63.5	50.8	3.5	3.3	575	1060	1200	1700	75.8	224	206	286	306	3.5	3.3	0.52	1.1	0.63	22.1
93708/93125	179.975	317.5	63.5	63.5	46.038	3.6	3.2	604	1130	1200	1700	71.4	192	227	278	295	3.6	3.2	0.52	1.15	0.63	20.8
67875/67820	179.997	266.7	47.099	46	38.1	6.4	3.2	339	703	1200	1700	57.8	198	211	245	257	6.4	3.2	0.48	1.26	0.69	8.87
JM736149/JM736110	180	250	47	45	37	3	2.5	369	695	1200	1700	56	192	192	240	243	2.5	2.5	0.48	1.25	0.7	6.65
HM237547/HM237510	180	288.925	63.5	68.262	47.625	7	3.2	628	973	1200	1700	52.2	199	203	260	270	7	3.2	0.32	1.88	1.04	14.6
M238843/M238810	180.975	269.875	55.563	55.563	42.863	1.6	3.2	411	805	1100	1600	49.9	189	209	246	255	1.6	3.2	0.33	1.8	0.99	10.5
LL537649/LL537610	184.15	236.538	26.192	25.4	19.05	1.5	1.5	155	291	1100	1600	38	199	193	225	230	1.5	1.5	0.37	1.6	0.89	2.66
67883/67820	184.15	266.7	47.625	46.833	38.1	3.5	3.3	345	720	1100	1600	57.9	212	198	246	260	3.5	3.3	0.48	1.3	0.69	8.73
67883/67830	184.15	279.997	46.525	46.833	36	3.6	3.2	339	703	1100	1600	56.7	196	211	245	257	3.6	3.2	0.48	1.26	0.69	10
67884/67820	187.325	266.7	47.625	46.833	38.1	3.5	3.3	345	720	1100	1600	57.9	214	200	246	260	3.5	3.3	0.48	1.3	0.69	8.39
M238849/M238810	187.325	269.875	55.562	55.562	42.862	3.5	3.3	490	920	1100	1600	49.6	211	198	250	261	3.5	3.3	0.33	1.8	0.99	10.1
87737/87111	187.325	282.575	50.8	47.625	36.512	3.5	3.3	360	600	1100	1600	54.8	215	202	262	274	3.5	3.3	0.42	1.4	0.79	9.94
67884/67835	187.325	289.992	46.525	46.833	36	3.6	3.2	339	703	1100	1600	56.7	200	211	245	257	3.6	3.2	0.48	1.26	0.69	10.9
H239649/H239610	187.325	319.964	88.9	85.725	65.088	5.5	4.8	855	1270	1100	1600	66.3	222	202	292	309	5.5	4.8	0.32	1.9	1	25
H239649/H239612	187.325	320.675	88.9	85.725	65.088	5.5	4.8	855	1270	1100	1600	66.3	222	202	292	309	5.5	4.8	0.32	1.9	1	25.2
M239447/M239410	189.738	279.4	52.388	57.15	41.275	3.3	3.3	523	980	1100	1600	49	202	212	266	266	3	3	0.33	1.8	1	11
JM738249/JM738210	190	260	46	44	36.5	3	2.5	370	730	1100	1600	56.4	212	198	241	255	3	2.5	0.48	1.3	0.69	6.94
67886/67820	190.078	266.7	47.099	46	38.1	6.4	3.2	339	703	1100	1600	57.8	208	211	245	257	6.4	3.2	0.48	1.26	0.69	7.82
M239449/M239410	190.475	279.4	52.388	57.15	41.275	3.3	3.3	523	980	1100	1600	49	203	212	266	266	3	3	0.33	1.8	1	11
67885/67820	190.5	266.7	47.625	46.833	38.1	3.5	3.3	345	720	1100	1600	57.9	215	202	246	260	3.5	3.3	0.48	1.3	0.69	8.04
87750/87111	190.5	282.575	50.8	47.625	36.512	3.5	3.3	360	600	1100	1600	54.8	217	204	262	274	3.5	3.3	0.42	1.4	0.79	9.59
93750/93125	190.5	317.5	63.5	63.5	46.038	4.3	3.3	575	1060	1000	1500	71	231	211	288	306	4.3	3.3	0.52	1.1	0.63	19.7
93750/93126	190.5	317.5	68.262	63.5	50.8	4.3	3.3	575	1060	1000	1500	75.8	231	211	286	306	4.3	3.3	0.52	1.1	0.63	20.6
EE470075/470128	190.5	327.025	90.488	92.075	63.5	6.4	6.4	930	1500	1000	1500	68.6	229	206	294	315	6.4	6.4	0.37	1.6	0.9	28.3
470975/470130	190.5	330.2	82.551	84.138	63.5	4.8	6.4	864	1430	1000	1500	68.4	205	224	290	305	4.8	6.4	0.37	1.63	0.9	27.9
HH840249/HH840210	190.5	336.55	98.425	95.25	73.025	6.4	6.4	940	1600	1000	1500	93.7	237	205	292	325	6.4	6.4	0.58	1	0.57	35.7
470975/470133	190.5	339.725	82.551	84.138	63.5	4.8	6.4	864	1430	1000	1500	68.4	205	224	290	305	4.8	6.4	0.37	1.63	0.9	30.4
EE470075/470133	190.5	339.725	90.488	92.075	63.5	6.4	6.4	864	1430	1000	1500	68.3	208	224	290	305	6.4	6.4	0.37	1.63	0.9	31.7
EE607075/607140	190.5	355.6	79.375	77.788	53.975	6.4	6.4	754	1090	1000	1500	83.8	208	228	305	324	6.4	6.4	0.55	1.1	0.6	30.5
EE420751/421437	190.5	365.049	92.075	88.897	63.5	6.4	3.3	975	1600	1000	1500		227	218	329	334	6.4	3.3	0.4	1.49	0.82	42.9
EE420751/421450	190.5	368.3	92.075	88.897	63.5	6.4	3.3	875	1340	1000	1500	78.9	243	220	333	353	6.4	3.3	0.42	1.4	0.79	39.6
EE350705/351687	190.5	428.625	106.362	95.25	61.912	6.4	6.4	1140	1400	950	1400	119	246	213	369	405	6.4	6.4	0.76	0.79	0.44	57.9
M239448A/M239410	191.237	279.4	53.975	58.738	41.275	3.3	3.3	523	980	1100	1600	49	204	212	265	266	3	3	0.33	1.8	1	10.5
67887/67820	192.088	266.7	47.625	46.833	38.1	10.4	3.2	339	703	1100	1600	57.8	218	211	245	257	10.4	3.2	0.48	1.26	0.69	7.6
87762/87111	193.675	282.575	50.8	47.625	36.512	3.5	3.3	360	600	1100	1600	54.8	218	205	262	274	3.5	3.3	0.42	1.4	0.79	9.23
67888/67820	194.975	266.7	47.625	46.833	38.1	3.6	3.2	339	703	1100	1600	57.8	207	211	245	257	3.6	3.2	0.48	1.26	0.69	7.38
LL639249/LL639210	196.85	241.3	23.812	23.017	17.462	1.5	1.5	131	293	1100	1600	41.4	210	204	230	236	1.5	1.5	0.42	1.4	0.79	2.23
L540049/L540010	196.85	254	28.575	27.783	21.433	1.5	1.5	177	355	1100	1600	42.9	213	206	241	247	1.5	1.5	0.4	1.5	0.83	3.48
LM739749/LM739710	196.85	257.175	39.688	39.688	30.162	3.5	3.3	271	620	1100	1600	51.3	218	206	240	251	3.5	3.3	0.45	1.3	0.73	5.33
LM739749/LM739719	196.85	266.7	39.688	39.688	30.163	3.6	3.2	268	632	1100	1600	50.6	209	211	238	247	3.6	3.2	0.45	1.34	0.74	6.18
93775/93125	196.85	317.5	63.5	63.5	46.038	4.3	3.3	575	1060	1100	1600	71	234	214	288	306	4.3	3.3	0.52	1.1	0.63	18.7
93775/93126	196.85	317.5	68.262	63.5	50.8	4.3	3.3	575	1060	1100	1600	75.8	234	214	286	306	4.3	3.3	0.52	1.1	0.63	19.7
67981/67919	198.298	279.4	46.038	49.213	36.513	3.6	3.2	349	707	1100	1600	61.6	211	222	259	272	3.6	3.2	0.51	1.18	0.65	8.75
67981/67920	198.298	282.575	46.038	49.213	36.513	3.6	3.2	349	707	1100	1600	61.6	211	222	259	272	3.6	3.2	0.51	1.18	0.65	9.15
67982/67920	199.949	282.575	46.038	49.213	36.513	3.6	3.2	349	707	1100	1600	61.6	212	222	259	272	3.6	3.2	0.51	1.18	0.65	8.95

EVERGLORY INDUSTRY CO., LIMITED

No. 29 Industrial Park North Road Wafangdian City Liaoning China

www.evergloryindustry.com

info@evergloryindustry.com

Tel / Whatsapp: 008613130008503



Bearing NO.	Boundary dimensions(mm)							Basic load ratings(kN)		Limiting speed(rpm)		Application point	Abutment and fillet dimensions(mm)						Value			Weight(kg)
	d	D	T	B	C	r _{1, 2min}	r _{3, 4min}	Cr	Cor	Grease	Oil		a	d _{a max}	d _{b min}	D _{a max}	D _{b min}	r _{a max}	r _{b max}	e	Y	
122978/122125	199.975	317.5	66.675	70	50.8	4.3	3.2	741	1270	1100	1600	54.4	214	232	289	299	4.3	3.2	0.3	2.02	1.11	19.5
JHM840449/JHM840410	200	300	65	62	51	3.5	2.5	615	1130	950	1400	73.1	230	211	274	292	3.5	2.5	0.52	1.2	0.63	15.5
HR32040XJ	200	310	70	70	53	3	2.5	760	1370	950	1400	67.4	231	213	285	302	2.5	2	0.43	1.4	0.77	18.9
LM241147/LM241110	200.025	276.225	42.862	46.038	34.133	3.5	3.3	390	780	1000	1500	45	216	220	261	265	3	3	0.31	1.9	1.1	7.7
M241543/M241510	200.025	292.1	57.945	57.945	46.038	3.6	3.2	545	1030	1000	1500	52.6	213	223	268	278	3.6	3.2	0.33	1.8	0.99	12.1
M241542/M241510	200.025	292.1	57.945	61.913	46.038	6.4	3.2	545	1030	1000	1500	52.6	219	223	268	278	6.4	3.2	0.33	1.8	0.99	12.3
93787/93125	200.025	317.5	63.5	63.5	46.038	4.3	3.3	575	1060	1000	1500	71	235	216	288	306	4.3	3.3	0.52	1.1	0.63	18.3
93787/93126	200.025	317.5	68.262	63.5	50.8	4.3	3.3	575	1060	1000	1500	75.8	235	216	286	306	4.3	3.3	0.52	1.1	0.63	19.2
HM743337/HM743310	200.025	333.375	69.85	69.85	52.388	6.4	6.4	690	1190	1000	1500	71.3	242	222	302	322	6.4	6.4	0.44	1.4	0.75	23.3
EE130787/131400	200.025	355.6	69.85	69.85	49.212	6.8	1.5	695	1230	1000	1500	59.8	250	232	329	340	6.8	1.5	0.33	1.8	0.99	28.3
H247535/H247510	200.025	384.175	112.712	112.712	90.488	6.4	6.4	1220	2220	1000	1500	84.2	258	234	344	369	6.4	6.4	0.33	1.8	0.99	58.8
HH144642/HH144614	200.025	393.7	111.125	111.125	84.138	6.4	6.4	1300	2030	1000	1500	78.1	251	227	352	374	6.4	6.4	0.3	2	1.1	57.4
M241545/M241510	200.812	292.1	57.945	61.913	46.038	6.4	3.2	545	1030	1000	1500	52.6	220	223	268	278	6.4	3.2	0.33	1.8	0.99	12.2
EE420793/421417	201.612	360	92.075	88.897	63.5	3.3	3.3	875	1340	1000	1500	78.9	246	226	329	349	3.3	3.3	0.42	1.4	0.79	34.9
LL641149/LL641110	203.2	261.142	28.575	27.783	21.433	1.5	1.5	176	355	1100	1600	43.7	219	212	247	254	1.5	1.5	0.41	1.5	0.81	3.54
LM241149/LM241110	203.2	276.225	42.862	42.862	34.133	3.5	3.3	335	620	1100	1600	44	224	213	259	269	3.5	3.3	0.32	1.9	1	6.84
67983/67919	203.2	279.4	46.038	46.038	36.513	3.6	3.2	349	707	1100	1600	61.6	216	222	259	272	3.6	3.2	0.51	1.18	0.65	8.04
67983/67920	203.2	282.575	46.038	46.038	36.512	3.5	3.3	365	800	1100	1600	61.9	230	215	261	276	3.5	3.3	0.51	1.2	0.65	8.85
M241547/M241510	203.2	292.1	57.945	57.945	46.038	3.6	3.2	545	1030	1100	1600	52.6	216	223	268	278	3.6	3.2	0.33	1.8	0.99	11.7
EE132083/132125	203.2	317.5	53.975	53.975	34.925	4	3.3	460	725	1100	1600	48	232	219	293	302	4	3.3	0.31	1.9	1.1	13.5
93800/93125	203.2	317.5	63.5	63.5	46.038	4.3	3.3	575	1060	1100	1600	71	237	217	288	306	4.3	3.3	0.52	1.1	0.63	17.8
93800A/93125	203.2	317.5	63.5	63.5	46.038	7.9	3.3	575	1060	1100	1600	71	240	217	288	306	7.9	3.3	0.52	1.1	0.63	17.7
EE122080/122125	203.2	317.5	66.675	66.675	50.8	4.3	3.3	615	995	1100	1600	55.9	234	218	293	305	4.3	3.3	0.3	2	1.1	17.4
93800/93126	203.2	317.5	68.262	63.5	50.8	4.3	3.3	575	1060	1100	1600	75.8	237	217	286	306	4.3	3.3	0.52	1.1	0.63	18.7
93800A/93126	203.2	317.5	68.262	63.5	50.8	7.9	3.3	575	1060	1100	1600	75.8	240	217	286	306	7.9	3.3	0.52	1.1	0.63	18.6
HM542948/HM542911	203.2	346.075	79.375	80.962	60.325	1.5	3.3	900	1460	1000	1500	78.9	224	224	315	322	1.5	3.3	0.39	1.55	0.85	28.8
EE420801/421417	203.2	360	92.075	88.897	63.5	3.3	3.3	875	1340	1000	1500	78.9	246	227	329	349	3.3	3.3	0.42	1.4	0.79	34.5
EE420801/421437	203.2	365.049	92.075	88.897	63.5	3.3	3.3	875	1340	1000	1500	78.9	246	227	332	351	3.3	3.3	0.42	1.4	0.79	36
EE420801/421450	203.2	368.3	92.075	88.897	63.5	3.3	3.3	875	1340	1000	1500	78.9	246	227	333	353	3.3	3.3	0.42	1.4	0.79	36.9
EE710806/711574	203.2	399.928	72	61.913	54	7.1	3.2	788	1100	1000	1500	84.5	223	274	354	371	7.1	3.2	0.47	1.27	0.7	36.8
EE114080/114160	203.2	406.4	92.075	85.725	57.15	6.4	6.4	935	1310	1000	1500	119.9	260	226	352	387	6.4	6.4	0.79	0.75	0.42	48.1
EE380080/380190	203.2	482.6	117.475	95.25	73.025	6.4	6.4	1190	1590	1000	1500	148.6	274	236	408	451	6.4	6.4	0.87	0.69	0.38	88.7
LL641148/LL641110	203.479	261.142	28.575	31.75	21.433	1.6	1.6	189	394	1000	1500	43.7	213	220	244	250	1.6	1.6	0.41	1.47	0.81	3.57
LM241148/LM241110	203.987	276.225	42.662	46.038	34.133	3.5	3.3	390	780	1000	1500	45	220	220	261	265	3	3	0.31	1.9	1.1	7.25
LM241148/LM241111	203.987	276.225	42.863	46.038	34.132	3.6	3.2	375	715	1000	1500	46.3	217	221	257	264	3.6	3.2	0.32	1.88	1.04	7.12
M241549/M241510	204.788	292.1	57.945	57.945	46.038	3.5	3.3	540	1050	1000	1500	52.8	229	216	271	283	3.5	3.3	0.33	1.8	0.99	12.1
93806A/93125	204.788	317.5	63.5	63.5	46.038	4.3	3.2	604	1130	1000	1500	71.4	219	227	278	295	4.3	3.2	0.52	1.15	0.63	17.1
67985/67920	206.375	282.575	46.038	46.038	36.512	3.5	3.3	365	800	1000	1500	61.9	231	216	261	276	3.5	3.3	0.51	1.2	0.65	8.48
67987/67920	206.375	282.575	46.038	49.212	36.513	3.6	3.2	349	707	1000	1500	61.6	220	222	259	272	3.6	3.2	0.51	1.18	0.65	8.17
EE132084/132125	206.375	317.5	53.975	53.975	34.925	4	3.3	460	725	1000	1500	48	234	220	293	302	4	3.3	0.31	1.9	1.1	13
93812/93125	206.375	317.5	63.5	63.5	46.038	4.3	3.2	6.4	1130	1000	1500	71.4	221	227	278	295	4.3	3.2	0.52	1.15	0.63	16.9
EE132084/162127	206.375	319.088	53.975	53.975	34.925	4	3.2	439	724	1000	1500	48.4	220	238	285	292	4	3.2	0.31	1.91	1.05	13.6
H242649/H242610	206.375	336.55	98.425	100.012	77.788	3.3	3.3	1040	1900	900	1300	73.4	242	222	306	325	3.3	3.3	0.33	1.8	0.99	32.8
EE420812X/421417	206.375	360	92.075	88.897	63.5	6.4	3.2	938	1460	900	1300	75.6	225	243	317	334	6.4	3.2	0.4	1.49	0.82	34.7
EE380081/380190	206.375	482.6	117.475	95.25	73.025	6.4	6.4	1450	2060	900	1300	152.8	225	272	386	428	6.4	6.4	0.87	0.69	0.38	92.7
67989/67920	209.55	282.575	46.038	46.038	36.512	3.5	3.3	365	800	900	1300	61.9	233	218	261	276	3.5	3.3	0.51	1.2	0.65	8.11
93825/93125	209.55	317.5	63.5	63.5	46.038	4.3	3.3	575	1060	1000	1500	71	240	221	288	306	4.3	3.3	0.52	1.1	0.63	16.7
93825A/93125	209.55	317.5	63.5	63.5	46.038	12.7	3.3	575	1060	1000	1500	71	248	221	288	306	12.7	3.3	0.52	1.1	0.63	16.6
93825/93126	209.55	317.5	68.262	63.5	50.8	4.3	3.3	575	1060	1000	1500	75.8	240	221	286	306	4.3	3.3	0.52	1.1	0.63	17.6
93825A/93126	209.55	317.5	68.262	63.5	50.8	12.7	3.3	575	1060	1000	1500	75.8	248	221	286	306	12.7	3.3	0.52	1.1	0.63	17.5
HM743345/HM743310	209.55	333.375	69.85	69.85	52.388	6.4	6.4	690	1190	1000	1500	71.3	247	227	302	322	6.4	6.4	0.44	1.4	0.75	21.7
96825/96140	209.55	355.6	68.262	66.675	47.625	7	3.3	605	1170	1000	1500	85.9	260	236	321	343	7	3.3	0.59	1	0.56	26.7
LM742745/LM742710	212.725	285.75	46.038	46.038	34.925	3.5	3.3	350	755	1000	1500	60.4	237	224	267	280	3.5	3.3	0.48	1.2	0.69	8.15
M246932/M246910	212.725	336.55	65.088	65.088	50.8	6.4	3.2	708	1380	1000	1500	59.9	232	258	309	320	6.4	3.2	0.33	1.8	0.99	21.6



EVERGLORY INDUSTRY CO., LIMITED

No. 29 Industrial Park North Road Wafangdian City Liaoning China

www.evergloryindustry.com

info@evergloryindustry.com

Tel / Whatsapp: 008613

Bearing NO.	Boundary dimensions(mm)							Basic load ratings(kN)		Limiting speed(rpm)		Application point	Abutment and fillet dimensions(mm)						Value			Weight(kg)
	d	D	T	B	C	r _{1, 2min}	r _{3, 4min}	Cr	Cor	Grease	Oil		a	d _{a max}	d _{b min}	D _{a max}	D _{b min}	r _{a max}	r _{b max}	e	Y	
LM742748/LM742710	215.9	285.75	46.038	46.038	34.925	3.6	3.2	356	781	1000	1500	60.7	229	231	265	276	3.6	3.2	0.48	1.25	0.69	7.55
LM742749/LM742710	215.9	285.75	46.038	46.038	34.925	3.5	3.3	350	755	1000	1500	60.4	239	225	267	280	3.5	3.3	0.48	1.2	0.69	7.77
543085/543114	215.9	290.01	31.75	31.75	22.225	3.5	3.3	225	455	1000	1500	45.3	237	228	271	279	3.5	3.3	0.39	1.5	0.85	5.49
EE130852/131400	215.9	355.6	69.85	69.85	49.212	6.8	1.5	695	1230	1000	1500	59.8	258	240	329	340	6.8	1.5	0.33	1.8	0.99	25.4
EE130851/131400	215.9	355.6	69.85	69.85	49.213	6.7	1.6	727	1310	1000	1500	59.9	235	263	319	330	6.7	1.6	0.33	1.82	1	25.9
EE420850/421417	215.9	360	82.55	79.372	63.5	1.6	3.2	938	1460	1000	1500	75.7	225	243	317	334	1.6	3.2	0.4	1.49	0.82	30.9
LM742747/LM742710	216.408	285.75	46.038	49.212	34.925	3.5	3.3	352	780	1000	1500	60	230	230	271	277	3	3	0.48	1.25	0.7	7.85
LM742747A/LM742710	216.713	285.75	46.038	49.212	34.925	3.5	3.3	352	780	1000	1500	60	230	230	271	277	3	3	0.48	1.25	0.7	7.8
EE710865/711600	219.916	406.4	63.5	61.913	39.688	7.1	6.4	788	1100	1000	1500	76	240	274	355	367	7.1	6.4	0.47	1.27	0.7	32.1
543086/543114	219.969	290.01	31.75	31.75	22.225	3.5	3.3	225	455	1000	1500	45.3	239	231	271	279	3.5	3.3	0.39	1.5	0.85	5.14
543086/543116	219.969	292.009	31.75	31.75	22.225	3.6	3.2	231	472	1000	1500	45.1	233	238	267	272	3.6	3.2	0.38	1.56	0.86	5.27
LM245832/LM245810	220.116	317.5	47.625	52.338	36.512	3.3	3.3	523	980	900	1300	49	235	249	302	304	3	3	0.31	1.9	1.1	12.5
M244249/M244210	220.662	314.325	61.912	61.912	49.212	6.4	3.3	595	1190	900	1300	57	250	233	292	305	6.4	3.3	0.33	1.8	0.99	14.9
LM245833/LM245810	220.878	317.5	47.625	52.338	36.512	3.3	3.3	523	980	900	1300	49	336	249	302	304	3	3	0.31	1.9	1.1	12.5
EE380875/380190	222.25	482.6	117.475	95.25	73.025	6.4	6.4	1450	2060	900	1300	152.8	241	272	386	428	6.4	6.4	0.87	0.69	0.38	88.8
LM844049/LM844010	223.838	295.275	46.038	46.038	34.925	3.6	3.2	360	792	900	1300	63.1	237	239	274	286	3.6	3.2	0.5	1.2	0.66	8.01
EE130889/131400	225.425	355.6	69.85	69.85	49.212	6.8	1.5	695	1230	900	1300	59.8	263	245	329	340	6.8	1.5	0.33	1.8	0.99	23.6
EE430888/431575	225.425	400.05	88.9	87.312	63.5	1.5	3.3	945	1510	900	1300	82	266	246	359	379	1.5	3.3	0.44	1.4	0.75	42.6
EE710905/711600	227.33	406.4	63.5	61.913	39.688	7.1	6.4	788	1100	900	1300	76	248	274	355	367	7.1	6.4	0.47	1.27	0.7	30.9
EE113089/113170	228.397	431.8	92.075	85.725	49.212	6.4	6.4	885	1320	900	1300	132.5	287	256	378	410	6.4	6.4	0.88	0.68	0.38	49
EE113089/113181	228.397	459.892	85.344	85.725	42.482	6.4	3.2	994	1450	900	1300	128.1	247	275	372	397	6.4	3.2	0.88	0.68	0.37	55
EE113091/113170	228.46	431.8	92.075	85.725	49.212	6.4	6.4	885	1320	900	1300	132.5	287	256	378	410	6.4	6.4	0.88	0.68	0.38	49
544090/544116	228.6	295.275	33.338	31.75	23.812	3.5	3.3	224	460	900	1300	49.6	250	240	279	288	3.5	3.3	0.4	1.5	0.82	5.25
544090/544118	228.6	300.038	33.338	31.75	23.812	3.5	3.3	224	460	900	1300	49.6	250	240	282	291	3.5	3.3	0.4	1.5	0.82	5.66
88900/88126	228.6	320.675	50.8	49.212	33.338	6.4	3.3	445	840	900	1300	65.4	260	242	300	312	6.4	3.3	0.48	1.2	0.68	11.6
88900/88128	228.6	327.025	52.388	49.212	34.925	6.4	3.3	445	840	900	1300	67	260	242	302	315	6.4	3.3	0.48	1.2	0.68	12.7
8573/8520	228.6	327.025	52.388	52.388	36.512	6.4	3.3	470	940	900	1300	59.6	261	244	304	317	6.4	3.3	0.41	1.5	0.81	13.3
96900/96140	228.6	355.6	68.262	66.675	47.625	7	3.3	605	1170	900	1300	85.9	270	246	321	343	7	3.3	0.59	1	0.56	23.3
EE130902/131400	228.6	355.6	69.85	69.85	49.212	6.8	1.5	695	1230	900	1300	59.8	265	246	329	340	6.8	1.5	0.33	1.8	0.99	23
HM746645/HM746610	228.6	355.6	69.85	69.85	50.8	6.4	6.4	772	1370	900	1300	77	247	261	322	338	6.4	6.4	0.47	1.27	0.7	24
HM746646/HM746610	228.6	355.6	69.85	69.85	50.8	6.4	6.4	765	1300	900	1300	75.6	266	244	324	345	6.4	6.4	0.47	1.3	0.7	23.1
M249732/M249710	228.6	358.775	71.438	71.438	53.975	3.6	3.2	773	1590	900	1300	64.4	242	279	330	342	3.6	3.2	0.33	1.8	0.99	26.6
EE710906/711574	228.6	399.928	72	61.913	54	7.1	3.2	788	1100	900	1300	84.5	249	274	354	371	7.1	3.2	0.47	1.27	0.7	32.6
EE430900/431575	228.6	400.05	88.9	87.312	63.5	10.4	3.3	945	1510	900	1300	82	277	248	359	379	10.4	3.3	0.44	1.4	0.75	41.7
EE430902/431575	228.6	400.05	88.9	87.312	63.5	19.8	3.3	945	1510	900	1300	82	286	248	359	379	19.8	3.3	0.44	1.4	0.75	41.3
EE700091/700167	228.6	425.45	101.6	95.25	76.2	7	6.4	1280	2000	900	1300	80.8	281	257	384	406	7	6.4	0.33	1.8	0.99	57
HH949549/HH949510	228.6	488.95	123.825	111.125	73.025	6.4	6.4	1600	2500	900	1300	166.5	307	264	420	470	6.4	6.4	0.94	0.64	0.35	103
EE390090/390200	228.6	508	117.475	95.25	73.025	6.4	6.4	1240	1780	900	1300	168.3	305	266	429	479	6.4	6.4	0.94	0.64	0.35	96.5
LM245846/LM245810	230.188	317.5	47.625	52.338	36.512	3.3	3.3	523	980	900	1300	49	246	249	302	304	3	3	0.31	1.9	1.1	11
LL244549/LL244510	231.775	268.288	22.499	21.501	18.499	2	2	130	317	900	1300	38.1	242	240	258	262	2	2	0.33	1.8	0.99	1.82
544091/544116	231.775	295.275	33.338	31.75	23.812	3.5	3.3	224	460	900	1300	49.6	251	241	279	288	3.5	3.3	0.4	1.5	0.82	4.96
544091/544118	231.775	300.038	33.338	31.75	23.812	3.5	3.3	224	460	900	1300	49.6	251	241	282	291	3.5	3.3	0.4	1.5	0.82	5.38
LM245848/LM245810	231.775	317.5	47.625	52.338	36.512	3.3	3.3	523	980	900	1300	49	248	249	302	304	3	3	0.31	1.9	1.1	10.5
M246942/M246910	231.775	336.55	65.088	65.088	50.8	6.4	3.3	640	1270	900	1300	60.1	265	247	313	326	6.4	3.3	0.33	1.8	0.99	18.4
M246943/M246910	231.775	336.55	65.088	69.85	50.8	6.4	3.2	708	1380	900	1300	59.9	251	258	309	320	6.4	3.2	0.33	1.8	0.99	18.6
M249734/M249710	231.775	358.775	71.438	71.438	53.975	6.4	3.2	773	1590	900	1300	64.4	251	279	330	342	6.4	3.2	0.33	1.8	0.99	26.3
HM647448/HM647411	231.775	377.825	79.375	80.963	58.738	3.2	3.2	958	1630	900	1300	77.6	244	266	337	353	3.2	3.2	0.43	1.4	0.77	32.9
M249743/M249710	231.775	358.775	71.438	71.438	53.975	6.4	3.3	760	1540	900	1300	64.6	276	256	335	348	6.4	3.3	0.33	1.8	0.99	26.2
LM446349/LM446310	234.95	311.15	46.038	46.038	33.338	3.6	3.2	407	825	900	1300	52.4	248	253	290	298	3.6	3.2	0.36	1.66	0.91	8.73
LM545849/LM545810	234.95	314.325	49.212	49.212	36.512	3.5	3.3	455	955	900	1300	57.4	260	247	296	309	3.5	3.3	0.4	1.5	0.83	10.4
LM545849/LM545812	234.95	317.5	49.213	49.213	36.513	3.6	3.2	485	981	900	1300	57.5	248	252	294	303	3.6	3.2	0.4	1.51	0.83	10.6
88925/88126	234.95	320.675	50.8	49.212	33.338	6.4	3.3	445	840	900	1300	65.4	263	246	300	312	6.4	3.3	0.48	1.2	0.68	10.7
88925/88128	234.95	327.025	52.388	49.212	34.925	6.4	3.3	445	840	900	1300	67	263	246	302	315	6.4	3.3	0.48	1.2	0.68	11.8
8574/8520	234.95	327.025	52.388	52.388	36.513	6.4	3.2	468	930	900	1300	60	254	258	300	310	6.4	3.2	0.41	1.48	0.81	12.2

EVERGLORY INDUSTRY CO., LIMITED

No. 29 Industrial Park North Road Wafangdian City Liaoning China

www.evergloryindustry.com

info@evergloryindustry.com

Tel / Whatsapp: 008613130008503

Bearing NO.	Boundary dimensions(mm)							Basic load ratings(kN)		Limiting speed(rpm)		Application point	Abutment and fillet dimensions(mm)						Value			Weight(kg)
	d	D	T	B	C	r _{1, 2min}	r _{3, 4min}	Cr	Cor	Grease	Oil		a	d _{a max}	d _{b min}	D _{a max}	D _{b min}	r _{a max}	r _{b max}	e	Y	
8575/8520	234.95	327.025	52.388	52.388	36.512	6.4	3.3	470	940	900	1300	59.6	264	248	304	317	6.4	3.3	0.41	1.5	0.81	12.4
8575/8522	234.95	328.625	52.388	52.388	36.513	6.4	3.2	468	930	900	1300	60	254	258	300	310	6.4	3.2	0.41	1.48	0.81	12.4
96925/96140	234.95	355.6	68.262	66.675	47.625	7	3.3	605	1170	900	1300	85.9	273	249	321	343	7	3.3	0.59	1	0.56	22.1
M252330/M252310	234.95	381	74.613	74.613	57.15	6.4	3.2	854	1670	900	1300	69	254	294	351	363	6.4	3.2	0.33	1.8	0.99	32.5
H247548/H247510	234.95	384.175	112.713	112.712	90.488	6.4	6.4	1450	2680	900	1300	83.8	254	265	342	362	6.4	6.4	0.33	1.8	0.99	50
H247549/H247510	234.95	384.175	112.712	112.712	90.488	6.4	6.4	1220	2220	900	1300	84.2	276	251	344	369	6.4	6.4	0.33	1.8	0.99	48.2
88931/88126	236.538	320.675	44.45	44.45	33.338	3.6	3.2	409	755	900	1300	64.4	250	254	298	309	3.6	3.2	0.48	1.24	0.68	9.24
M246949/M246910	237.33	336.55	65.088	65.088	50.8	6.4	3.3	640	1270	900	1300	60.1	268	250	313	326	6.4	3.3	0.33	1.8	0.99	17.3
M249736/M249710	237.33	358.775	71.438	71.438	53.975	6.4	3.3	760	1540	900	1300	64.6	279	259	335	348	6.4	3.3	0.33	1.8	0.99	25
EE125094/125145	241.122	368.3	68.262	68.262	53.975	6.4	3.3	685	1210	900	1300	65.3	277	258	339	354	6.4	3.3	0.34	1.7	0.96	24.1
8578/8520	241.3	327.025	52.388	52.388	36.512	6.4	3.3	470	940	900	1300	59.6	267	250	304	317	6.4	3.3	0.41	1.5	0.81	11.4
EE170950/171400	241.3	355.6	50.8	50.8	33.338	6.4	3.2	508	924	900	1300	56.1	260	280	328	336	6.4	3.2	0.36	1.65	0.91	16.1
EE127095/127135	241.3	349.148	57.15	57.15	44.45	6.4	3.3	570	1060	900	1300	59.5	274	257	325	338	6.4	3.3	0.35	1.7	0.93	16.8
EE170950/171400	241.3	355.6	50.8	50.8	33.338	6.4	3.3	460	815	900	1300	56	275	260	331	341	6.4	3.3	0.36	1.7	0.91	15.2
EE127095/127140	241.3	355.6	57.15	57.15	44.45	6.4	3.3	570	1060	900	1300	59.5	274	257	328	341	6.4	3.3	0.35	1.7	0.93	18
EE170950/171436	241.3	365.049	50.8	50.8	33.338	6.4	3.2	508	924	900	1300	56.1	260	280	328	336	6.4	3.2	0.36	1.65	0.91	17.4
EE170950/171450	241.3	368.3	50.8	50.8	33.338	6.4	3.3	460	815	900	1300	56	275	260	338	348	6.4	3.3	0.36	1.7	0.91	17.1
EE125095/125145	241.3	368.3	68.262	68.262	53.975	6.4	3.3	685	1210	900	1300	65.3	278	258	339	354	6.4	3.3	0.34	1.7	0.96	24.1
EE275095/275155	241.3	393.7	73.817	69.85	50.005	6.4	6.4	700	1280	900	1300	76.1	293	274	364	382	6.4	6.4	0.4	1.5	0.82	32.3
EE275095/275160	241.3	406.4	69.85	69.85	46.038	6.4	6.4	700	1280	800	1100	72.1	293	274	371	389	6.4	6.4	0.4	1.5	0.82	34.3
EE923095/923175	241.3	444.5	101.6	100.012	76.2	6.4	4.8	1410	2240	800	1100	84.4	295	273	403	423	6.4	4.8	0.34	1.8	0.98	65.4
EE295950/295193	241.3	488.95	120.65	120.65	92.075	6.4	6.4	1720	2860	800	1100	92.8	315	288	445	469	6.4	6.4	0.31	1.9	1.1	101
EE390095/390200	241.3	508	117.475	95.25	73.025	6.4	6.4	1240	1780	800	1100	168.3	312	272	429	479	6.4	6.4	0.94	0.64	0.35	93
LL648434/LL648415	243.683	315.913	31.75	31.75	22.225	3.6	3.2	241	549	800	1100	54	257	268	295	301	3.6	3.2	0.43	1.39	0.77	6
EE126097/126150	244.475	381	79.375	76.2	57.15	6.4	4.8	820	1540	800	1100	87.5	286	261	344	367	6.4	4.8	0.52	1.2	0.64	30.7
EE700096/700167	244.475	425.45	93.6663	87.313	76.2	1.6	6.4	1180	1980	800	1100	81.2	254	285	364	381	1.6	6.4	0.33	1.8	0.99	52.4
28880/28820	247.65	304.8	22.225	22.225	15.875	1.6	1.6	155	322	800	1100	38.8	257	262	285	289	1.6	1.6	0.32	1.85	1.02	3.05
M348449/M348410	247.65	346.075	63.5	63.5	50.8	6.4	6.4	726	1440	800	1100	61.7	267	268	319	331	6.4	6.4	0.34	1.75	0.96	17.4
EE170975/171400	247.65	355.6	50.8	50.8	33.338	6.4	3.3	460	815	800	1100	56	278	263	331	341	6.4	3.3	0.36	1.7	0.91	14.2
EE170975/171450	247.65	368.3	50.8	50.8	33.338	6.4	3.3	460	815	800	1100	56	278	263	338	348	6.4	3.3	0.36	1.7	0.91	16.1
M252337/M252310	247.65	381	74.613	74.613	57.15	6.4	3.2	854	1670	800	1100	69	267	294	351	363	6.4	3.2	0.33	1.8	0.99	29.7
HH249949/HH249910	247.65	406.4	115.888	117.475	93.662	6.4	6.4	1530	2920	800	1100	87.4	293	266	366	392	6.4	6.4	0.33	1.8	0.99	58.2
EE115097/115175	247.65	444.5	104.775	103.188	76.2	6.4	4.8	1560	2460	800	1100	85.3	267	296	395	412	6.4	4.8	0.35	1.73	0.95	65
EE515097/515237	247.65	603.25	160.338	158.75	122.238	6.4	9.5	3070	4210	800	1100	127.4	267	345	520	545	6.4	9.5	0.38	1.57	0.86	224
EE126098/126150	249.25	381	79.375	76.2	57.15	6.4	4.8	788	1470	800	1100	88.5	268	278	337	356	6.4	4.8	0.52	1.16	0.64	29.5
LL648449/LL648416	254	315.913	31.75	31.75	22.225	3.6	4.8	241	549	800	1100	54	267	268	295	301	3.6	4.8	0.43	1.39	0.77	4.99
29875/29819	254	317.5	22.225	22.225	15.875	1.5	1.5	153	380	800	1100	43.4	276	271	307	311	1.5	1.5	0.35	1.7	0.95	4.18
29875/29820	254	323.85	22.225	22.225	15.875	1.5	1.5	153	380	800	1100	43.4	276	271	310	315	1.5	1.5	0.35	1.7	0.95	4.57
HH249749/HH249710	254	358.775	71.438	71.438	53.975	3.5	3.3	760	1540	800	1100	64.6	284	267	335	348	3.5	3.3	0.33	1.8	0.99	21.5
EE134100/134143	254	365.125	58.738	58.738	42.862	6.4	6.4	580	1100	800	1100	64.2	289	272	339	354	6.4	6.4	0.37	1.6	0.88	18.4
EE134100/134145	254	368.3	58.738	58.738	42.862	6.4	6.4	580	1100	800	1100	64.2	289	272	340	356	6.4	6.4	0.37	1.6	0.88	19.1
EE275100/275155	254	393.7	73.817	69.85	50.005	6.4	6.4	700	1280	800	1100	76.1	299	280	364	382	6.4	6.4	0.4	1.5	0.82	29.6
EE275100/275158	254	403.225	69.85	69.85	46.038	6.4	6.4	738	1540	700	1000	71.5	273	313	365	378	6.4	6.4	0.4	1.49	0.82	32.5
HM252343/HM252310	254	422.275	86.121	79.771	66.675	6.7	3.2	1010	1680	700	1000	78.7	273	309	384	399	6.7	3.2	0.33	1.8	0.99	42.7
HM252344/HM252310	254	422.275	86.121	79.771	66.675	6.7	3.2	1010	1680	700	1000	78.7	273	309	384	399	6.7	3.2	0.33	1.8	0.99	42.7
EE822100/822175	254	444.5	76.2	73.025	50.8	6.4	6.4	860	1380	700	1000	81	273	316	392	406	6.4	6.4	0.42	1.44	0.79	43
EE822100X/822175	254	444.5	76.2	76.2	50.8	6.4	6.4	860	1380	700	1000	81	273	316	392	406	6.4	6.4	0.42	1.44	0.79	43.6
EE251001/251575	254	400.05	57.15	55.562	41.275	3.3	1.5	635	1050	700	1000	61.2	291	276	372	381	3.3	1.5	0.33	1.8	1	24.3
EE275100/275160	254	406.4	69.85	69.85	46.038	6.4	6.4	700	1280	700	1000	72.1	299	280	371	389	6.4	6.4	0.4	1.5	0.82	31.6
HM252343/HM252310	254	422.275	86.121	79.771	66.675	6.8	3.3	1140	1850	700	1000	77.6	301	278	392	408	6.8	3.3	0.33	1.8	0.99	43.2
HM252343/HM252315	254	431.724	82.55	79.771	60.325	6.8	3.5	1140	1850	700	1000	74.1	301	278	397	413	6.8	3.5	0.33	1.8	0.99	44.9
EE822100/822175	254	444.5	76.2	73.025	50.8	6.4	6.4	995	1500	700	1000	71.1	302	281	405	421	6.4	6.4	0.34	1.8	0.97	42.7
EE941002/941950	254	495.3	76.2	74.612	53.975	6.4	3.3	1080	1790	700	1000	85.1	327	304	455	471	6.4	3.3	0.4	1.5	0.83	64
HH258232/HH258210	254	495.3	141.288	141.288	114.3	6.4	6.4	2330	4670	700	1000	108.1	273	346	442	467	6.4	6.4	0.33	1.8	0.99	128

EVERGLORY INDUSTRY CO., LIMITED

No. 29 Industrial Park North Road Wafangdian City Liaoning China

www.evergloryindustry.com

info@evergloryindustry.com

Tel / Whatsapp: 008613130008503



Bearing NO.	Boundary dimensions(mm)							Basic load ratings(kN)		Limiting speed(rpm)		Application point	Abutment and fillet dimensions(mm)						Value			Weight(kg)
	d	D	T	B	C	r _{1, 2min}	r _{3, 4min}	Cr	Cor	Grease	Oil		a	d _{a max}	d _{b min}	D _{a max}	D _{b min}	r _{a max}	r _{b max}	e	Y	
HH953749/HH953710	254	533.4	133.35	120.65	77.788	6.4	6.4	1840	2770	600	800	177.9	332	285	457	511	6.4	6.4	0.94	0.64	0.35	127
M349546XX/M349510	255.6	342.9	57.15	63.5	44.45	1.6	3.2	612	1280	700	1000	60.1	265	276	321	331	1.6	3.2	0.35	1.73	0.95	14.1
M349547/M349510	255.6	342.9	57.15	63.5	44.45	1.6	3.2	612	1280	700	1000	60.1	265	276	321	331	1.6	3.2	0.35	1.73	0.95	14.1
M349549/M349510	257.175	342.9	57.15	57.15	44.45	6.4	3.3	560	1190	850	1200	59.6	285	269	323	336	6.4	3.3	0.35	1.7	0.94	14.1
M249747/M249710	257.175	358.775	71.438	76.2	53.975	1.6	3.2	773	1590	850	1200	64.4	266	279	330	342	1.6	3.2	0.33	1.8	0.99	21
EE221018/221575	258.763	400.05	69.85	67.47	46.038	9.5	6.4	759	1280	850	1200	71.2	284	295	359	371	9.5	6.4	0.39	1.52	0.84	26.7
EE134102/134143	260.35	365.125	58.738	58.738	42.862	6.4	6.4	580	1100	850	1200	64.2	293	275	339	354	6.4	6.4	0.37	1.6	0.88	17.3
EE134102/134145	260.35	368.3	58.738	58.738	42.862	6.4	6.4	580	1100	850	1200	64.2	293	275	340	356	6.4	6.4	0.37	1.6	0.88	17.9
EE221026/221575	260.35	400.05	69.85	67.47	46.038	9.7	6.4	735	1220	800	1100	71.4	300	278	366	383	9.7	6.4	0.39	1.5	0.84	26.7
EE128102/128160	260.35	406.4	69.85	67.673	53.975	3.3	3.3	750	1430	800	1100	73.5	302	285	376	391	3.3	3.3	0.39	1.6	0.86	31.8
EE435102/435165	260.35	419.1	85.725	84.138	61.912	6.4	3.3	960	1820	800	1100	106	310	281	378	405	6.4	3.3	0.61	0.99	0.54	42.9
HM252348/HM252310	260.35	422.275	86.121	79.771	66.675	6.7	3.2	1010	1680	800	1100	78.7	280	309	384	399	6.7	3.2	0.33	1.8	0.99	41.2
HM252349/HM252310	260.35	422.275	86.121	79.771	66.675	6.8	3.3	1140	1850	800	1100	77.6	304	282	392	408	6.8	3.3	0.33	1.8	0.99	41.6
EE551026/551662	260.35	422.275	86.124	79.771	66.675	6.8	3.3	975	1590	800	1100	77.3	302	281	387	404	6.8	3.3	0.33	1.8	0.99	41
HM252348/HM252315	260.35	431.724	82.55	79.771	60.325	6.7	3.6	1010	1680	800	1100	75.2	280	309	385	398	6.7	3.6	0.33	1.8	0.99	42.9
HM252349/HM252315	260.35	431.724	82.55	79.771	60.325	6.8	3.5	1140	1850	800	1100	74.1	304	282	397	413	6.8	3.5	0.33	1.8	0.99	43.3
EE295102/295193	260.35	488.95	120.65	120.65	92.075	6.4	6.4	1720	2860	800	1100	92.8	325	297	445	469	6.4	6.4	0.31	1.9	1.1	93.8
LM451344/LM451310	262.975	355.6	57.15	62	44.45	3.6	3.2	605	1280	900	1300	62.3	276	287	332	343	3.6	3.2	0.36	1.67	0.92	15.7
38880/38820	263.525	325.438	28.575	28.575	25.4	1.5	1.5	228	555	900	1300	46.6	281	274	312	318	1.5	1.5	0.35	1.7	0.95	5.3
LM451345/LM451310	263.525	355.6	57.15	57.15	44.45	3.5	3.3	615	1260	850	1200	62.4	290	276	335	348	3.5	3.3	0.36	1.6	0.9	15.3
L853042/L853010	264.975	352.425	36.513	34.925	23.813	3.6	3.2	310	653	850	1200	71.2	278	295	329	338	3.6	3.2	0.54	1.11	0.61	8.82
LM451347/LM451310	264.975	355.6	57.15	62	44.45	3.6	3.2	605	1280	850	1200	62.3	278	287	332	343	3.6	3.2	0.36	1.67	0.92	15.3
29880/29820	266.7	323.85	22.225	22.225	15.875	1.5	1.5	153	380	850	1200	43.4	282	277	310	315	1.5	1.5	0.35	1.7	0.95	3.67
38885/38820	266.7	325.438	28.575	28.575	25.4	1.5	1.5	228	555	850	1200	46.6	283	276	312	318	1.5	1.5	0.35	1.7	0.95	5
38886/38820XX	266.7	325.438	28.575	33.47	25.4	1.6	1.6	217	7	850	1200	48.6	276	281	306	312	1.6	1.6	0.37	1.64	0.9	4.97
LM451349/LM451310	266.7	355.6	57.15	57.15	44.45	3.5	3.3	615	1260	850	1200	62.4	292	277	335	348	3.5	3.3	0.36	1.6	0.9	14.7
LM451349A/LM451311	266.7	355.6	57.15	57.15	44.4	10.4	3.2	605	1280	850	1200	62.3	294	287	332	343	10.4	3.2	0.36	1.67	0.92	14.5
EE275105/275155	266.7	393.7	73.817	69.85	50.005	6.4	6.4	700	1280	850	1200	76.1	306	286	364	382	6.4	6.4	0.4	1.5	0.82	26.7
EE275105/275160	266.7	406.4	69.85	69.85	46.038	6.4	6.4	700	1280	850	1200	72.1	306	286	371	389	6.4	6.4	0.4	1.5	0.82	28.8
HM252349A/HM252310	266.7	422.275	86.121	79.771	66.675	6.8	3.2	1010	1680	850	1200	78.7	286	309	384	399	6.8	3.2	0.33	1.8	0.99	39.5
EE551050/551700	266.7	431.724	82.55	79.771	60.325	6.7	3.6	980	1710	850	1200	74.3	286	304	375	388	6.7	3.6	0.33	1.8	0.99	40.9
EE551050/551662	266.7	422.275	86.124	79.771	66.675	6.8	3.3	975	1590	850	1200	77.3	306	284	387	404	6.8	3.3	0.33	1.8	0.99	39.4
H852849/H852810	266.7	444.5	120.65	117.475	88.9	6.4	6.4	1610	3050	850	1200	119.9	320	282	392	431	6.4	6.4	0.58	1	0.57	72
M252349/M252310	269.875	381	74.612	74.612	57.15	6.4	3.3	790	1590	850	1200	68.8	304	285	356	370	6.4	3.3	0.33	1.8	0.99	24.8
29888/29819	273.05	317.5	22.225	22.225	15.875	1.6	1.6	147	361	850	1200	43	282	284	304	307	1.6	1.6	0.35	1.73	0.95	2.61
EE275108/275155	273.05	393.7	73.817	69.85	50.005	6.4	6.4	700	1280	850	1200	76.1	309	290	364	382	6.4	6.4	0.4	1.5	0.82	25.2
EE275108/275160	273.05	406.4	69.85	69.85	46.038	6.4	6.4	700	1280	850	1200	72.1	309	290	371	389	6.4	6.4	0.4	1.5	0.82	27.3
L853048/L853010	275	352.425	36.513	40	23.813	3.6	3.2	310	653	850	1200	71.2	281	295	329	338	3.6	3.2	0.54	1.11	0.61	7.96
L853049/L853010	276.225	352.425	36.512	34.925	23.812	3.5	3.3	320	665	850	1200	72	300	288	333	344	3.5	3.3	0.54	1.1	0.62	7.85
LL352148/LL352111	279.4	317.5	22.225	22.86	17.653	1.6	1.6	151	422	850	1200	44	289	289	307	311	1.6	1.6	0.35	1.73	0.95	2.37
LL352149/LL352110	279.4	317.5	24.384	24.384	18.288	1.6	1.6	151	422	850	1200	44.7	289	289	307	311	1.6	1.6	0.35	1.73	0.95	2.52
L555233/L555210	279.4	374.65	47.625	47.625	34.925	3.6	3.2	468	971	850	1200	64.7	293	309	352	361	3.6	3.2	0.4	1.49	0.82	14
EE722110/722185	279.4	469.9	95.25	93.662	69.85	9.7	3.3	1180	2060	850	1200	87.2	336	308	431	451	9.7	3.3	0.38	1.6	0.87	60.9
EE295110/295193	279.4	488.95	120.65	120.65	92.075	1.3	6.4	1720	2860	850	1200	92.8	329	307	445	469	1.3	6.4	0.31	1.9	1.1	86.2
LM654642/LM654611	279.982	380.009	65.088	65.088	49.212	3.6	3.2	664	1410	850	1200	75.9	293	307	356	370	3.6	3.2	0.43	1.39	0.77	20
LM654642/LM654610	279.982	380.898	65.088	65.088	49.212	3.5	3.3	660	1550	850	1200		302	298	356	368	3.5	3.3	0.43	1.39	0.76	19
EE128112/128160	280	6.4	69.85	67.673	53.975	6.4	3.2	767	1470	850	1200	75	299	311	369	383	6.4	3.2	0.39	1.56	0.86	27.7
EE101103/101575	280.192	400.05	52.388	0.211	34.925	6.7	3.2	521	991	850	1200	67.7	300	317	366	375	6.7	3.2	0.41	1.48	0.81	18.7
EE101103/101600	280.192	406.4	52.388	50.211	34.925	6.8	3.3	520	870	850	1200	68.1	315	299	380	391	6.8	3.3	0.41	1.5	0.81	18.9
EE128110/128160	280.192	406.4	69.85	67.673	53.975	6.7	3.2	767	1470	850	1200	75	300	311	369	383	6.7	3.2	0.39	1.56	0.86	27.6
EE128111/128160	280.192	406.4	69.85	67.673	53.975	6.8	3.3	750	1430	850	1200	73.5	316	295	376	391	6.8	3.3	0.39	1.6	0.86	27.2
EE128111/128161	280.192	409.981	69.85	67.673	53.975	6.8	3.3	750	1430	850	1200	73.5	316	295	377	393	6.8	3.3	0.39	1.6	0.86	28.2
545112/545139	285.75	354.013	33.338	31.75	22.225	3.6	3.2	240	537	850	1200	65.8	299	308	337	344	3.6	3.2	0.49	1.23	0.68	6.3
545112/545141	285.75	358.775	33.338	31.75	22.225	3.5	3.3	252	575	850	1200	66.3	307	298	339	348	3.5	3.3	0.49	1.2	0.67	7.09

EVERGLORY INDUSTRY CO., LIMITED

No. 29 Industrial Park North Road Wafangdian City Liaoning China

www.evergloryindustry.com

info@evergloryindustry.com

Bearing NO.	Boundary dimensions(mm)							Basic load ratings(kN)		Limiting speed(rpm)		Application point	Abutment and fillet dimensions(mm)						Value			Weight(kg)
	d	D	T	B	C	r _{1, 2min}	r _{3, 4min}	Cr	Cor	Grease	Oil		a	d _{a max}	d _{b min}	D _{a max}	D _{b min}	r _{a max}	r _{b max}	e	Y	
LM654649/LM654610	285.75	380.898	65.088	65.088	49.212	3.5	3.3	615	1490	850	1200	76.1	316	300	355	371	3.5	3.3	0.43	1.4	0.77	20
EE921124/921850	285.75	469.9	81.77	80.569	57.15	9.7	3.3	1100	1810	850	1200	69.4	338	315	438	451	9.7	3.3	0.29	2.1	1.1	49.4
M255499/M255410A	288.925	406.4	77.788	77.788	60.325	6.4	3.3	1010	2080	850	1200		316	310	379	388	6.4	3.3	0.34	1.78	0.98	29.8
M255449/M255410	288.925	406.4	77.788	77.788	60.325	6.4	3.3	895	1830	850	1200	72.8	324	304	380	395	6.4	3.3	0.34	1.8	0.98	29.8
M255448/M255411	288.925	406.949	77.907	77.788	61	9.5	3.6	1010	2210	850	1200	73.3	314	318	374	388	9.5	3.6	0.34	1.77	0.98	31.1
L357040/L357010	289.975	393.7	50.8	50.8	38.1	6.4	3.2	524	1180	850	1200	64.8	309	329	369	378	6.4	3.2	0.36	1.67	0.92	17.4
L555249/L555210	292.1	374.65	47.625	47.625	34.925	3.5	3.3	490	1060	800	1100	64.5	316	303	355	366	3.5	3.3	0.4	1.5	0.82	12.5
84115/84155	292.1	393.7	63.5	50.8	44.45	3.5	6.4	545	1120	800	1100	99.8	323	305	364	383	3.5	6.4	0.61	0.99	0.54	18.6
EE722115/722185	292.1	469.9	95.25	93.662	69.85	9.7	3.3	1180	2060	800	1100	87.2	342	315	431	451	9.7	3.3	0.38	1.6	0.87	56.7
EE224115/224200	292.1	508	106.363	107.95	74.613	6.4	3.2	1480	2540	800	1100	88.5	311	362	453	469	6.4	3.2	0.33	1.84	1.01	82.5
EE790114/790221	292.1	558.8	136.525	136.525	98.425	6.4	6.4	2480	4100	700	1000	113.5	362	332	506	537	6.4	6.4	0.39	1.5	0.84	147
EE790116/790221	292.1	558.8	136.525	136.525	98.425	19.8	6.4	2350	4000	700	1000	114.2	338	366	488	510	19.8	6.4	0.4	1.52	0.84	142
EE111175/117100	298.45	431.8	69.85	58.738	53.975	6.4	3.3	755	1400	700	1000	88.1	336	316	400	417	6.4	3.3	0.44	1.4	0.75	29.2
EE291175/291749	298.45	444.5	63.5	61.912	39.688	8	3.3	685	1140	700	1000	71.8	339	319	415	427	8	3.3	0.38	1.6	0.87	28.7
EE291175/291750	298.45	444.5	63.5	61.912	39.688	8	1.5	685	1140	700	1000	71.8	339	319	417	427	8	1.5	0.38	1.6	0.87	28.7
HH258248/HH258210	299.975	495.3	141.288	141.288	114.3	6.4	6.4	2330	4670	700	1000	108.1	319	346	442	467	6.4	6.4	0.33	1.8	0.99	106
HH258248/HH258210	300	495.3	141.288	141.288	114.3	6.4	6.4	2330	4550	630	850	106	330	341	464	468	6	6	0.33	1.8	1	107
HM256849/HM256810	300.038	422.275	82.55	82.55	63.5	6.4	3.3	990	2050	630	850	76.7	337	317	395	411	6.4	3.3	0.34	1.8	0.98	34.2
L357049/L357010	304.8	393.7	50.8	50.8	38.1	6.4	3.3	530	1140	630	850	63.7	334	318	374	385	6.4	3.3	0.36	1.7	0.92	14.5
LM757049/LM757010	304.8	406.4	63.5	63.5	47.625	6.4	3.3	690	1490	630	850	79.4	337	317	380	396	6.4	3.3	0.44	1.4	0.75	21.4
EE1291120X/129172	304.8	438.048	76.2	76.992	53.975	6.4	4.8	788	1610	630	850	82	325	343	401	415	6.4	4.8	0.4	1.49	0.82	34.4
EE291201/291749	304.8	444.5	63.5	61.912	39.688	8	3.3	685	1140	630	850	71.8	342	323	415	427	8	3.3	0.38	1.6	0.87	27.3
EE291201/291750	304.8	444.5	63.5	61.912	39.688	8	1.5	685	1140	630	850	71.8	342	323	417	427	8	1.5	0.38	1.6	0.87	27.3
EE724119/724191	304.8	488.95	92.075	92.075	63.5	16	3.2	1270	2340	630	850	92	344	359	439	456	16	3.2	0.4	1.49	0.82	60.4
EE724120/724191	304.8	488.95	92.075	92.075	63.5	16	3.2	1270	2340	630	850	92	344	359	439	456	16	3.2	0.4	1.49	0.82	60.4
EE941205/941950	304.8	495.3	76.2	74.612	53.975	6.4	3.3	1080	1790	630	850	85.1	352	329	455	471	6.4	3.3	0.4	1.5	0.83	51
EE941205/941950A	304.8	495.3	76.2	74.612	53.975	6.4	3.3	1140	1940	630	850		339	329	459	463	6.4	3.3	0.4	1.49	0.82	55.8
EE941205/941950	304.8	495.3	76.2	77.866	53.975	6.4	3.2	1020	1610	630	850	88.1	325	355	441	455	6.4	3.2	0.4	1.49	0.82	50.7
EE724119/724195	304.8	495.3	95.25	92.075	69.85	16	6.4	1270	2340	630	850	95.2	344	359	439	474	16	6.4	0.4	1.49	0.82	64.8
EE724120/724195	304.8	495.3	95.25	92.075	69.85	16	6.4	1240	2150	630	850	93.9	364	329	451	474	16	6.4	0.4	1.5	0.82	63.3
M959442/M959410	304.8	499.948	101.6	79.375	53.975	6.4	6.4	1190	2030	630	850	203	367	327	444	487	6.4	6.4	1.2	0.51	0.28	67.6
EE790120/790221	304.8	558.8	136.525	136.525	98.425	1.3	6.4	2480	4100	630	850	113.5	364	338	506	537	1.3	6.4	0.39	1.5	0.84	141
LM757049A/LM757010	305.054	406.4	63.5	63.5	47.625	6	3.2	748	1580	630	850	79.6	325	323	376	390	6.4	3.2	0.44	1.36	0.75	21.2
H859049/H859010	314.325	495.3	120.65	119.062	88.9	6.4	6.4	1710	3300	630	850	125.3	368	335	446	484	6.4	6.4	0.55	1.1	0.6	83.8
EE291250/291750	317.5	444.5	63.5	61.912	39.688	8	1.5	685	1140	630	850	71.8	349	329	417	427	8	1.5	0.38	1.6	0.87	24.3
EE291251/291750	317.5	444.5	63.5	61.913	39.688	15	1.6	721	1380	630	850	70	355	346	404	414	15	1.6	0.38	1.59	0.87	25.7
EE291250/291749	317.5	444.5	63.5	61.912	39.688	8	3.3	685	1140	630	850	71.8	349	329	415	427	8	3.3	0.38	1.6	0.87	24.2
HM259048/HM259010	317.5	447.675	85.725	85.725	68.263	3.6	3.2	1060	2330	630	850	79.7	332	352	411	426	3.6	3.2	0.33	1.8	0.99	40.9
HM259049/HM259010	317.5	447.675	85.725	85.725	68.262	3.5	3.3	1120	2350	630	850	80.1	353	333	418	435	3.5	3.3	0.33	1.8	0.99	40.4
EE720125/720236	317.5	596.9	136.525	136.525	98.425	19.8	6.4	2480	4110	600	800	119.6	364	389	520	545	19.8	6.4	0.42	1.42	0.78	161
H961649/H961610	317.5	622.3	147.638	131.762	82.55	14.3	12.7	2270	3800	600	800	206.4	414	358	535	597	14.3	12.7	0.94	0.64	0.35	184
LL758744/LL758715	323.85	381	28.575	28.575	20.638	3.6	3.3	219	570	670	900	64.8	338	340	363	369	3.6	3.3	0.44	1.36	0.75	5.15
EE720128/720236	325.438	596.9	136.525	136.525	98.425	6.4	6.4	2480	4110	630	850	119.6	345	389	520	545	6.4	6.4	0.42	1.42	0.78	158
EE971298/972100	329.87	533.4	76.2	76.2	50.8	4.7	3.3	1060	1800	630	850	78.4	383	364	497	510	4.7	3.3	0.33	1.8	0.99	58.5
L860048/L860010	330.2	415.925	47.625	47.625	34.925	12.7	3.3	505	1150	630	850	83	365	342	394	408	12.7	3.3	0.5	1.2	0.66	14.3
L860049/L860010	330.2	415.925	47.625	47.625	34.925	3.5	3.3	505	1150	630	850	83	356	342	394	408	3.5	3.3	0.5	1.2	0.66	14.6
EE161300/161850	330.2	469.9	60.325	55.562	38.1	7	6.4	710	1420	630	850	92.7	377	358	441	459	7	6.4	0.5	1.2	0.66	30.1
EE161300/161900	330.2	482.6	60.325	55.562	38.1	7	6.4	710	1420	630	850	92.7	377	358	447	464	7	6.4	0.5	1.2	0.66	32.9
EE203130/203190	330.2	482.6	66.675	63.5	44.45	6.8	6.8	810	1560	630	850	84.9	377	358	450	467	6.8	6.8	0.42	1.4	0.79	36.4
EE526130/526190	330.2	482.6	85.725	80.167	60.325	6.4	3.3	995	1830	630	850	88.9	370	348	447	465	6.4	3.3	0.39	1.5	0.85	44.9
EE526132/526190	330.2	482.6	85.725	80.167	60.325	3.3	3.3	995	1830	630	850	88.9	367	348	447	465	3.3	3.3	0.39	1.5	0.85	45
EE161300/161925	330.2	488.95	60.325	55.562	38.1	7	6.4	710	1420	630	850	92.7	377	358	451	468	7	6.4	0.5	1.2	0.66	34.3
HM261049/HM261010	333.375	469.9	90.488	90.488	71.438	6.4	3.3	1340	2850	630	850	85	365	362	438	452	6	3	0.33	1.8	1	47
LM361649/LM361610	342.9	450.85	66.675	66.675	52.388	8.5	3.5	805	1840	670	900	75.8	379	359	426	441	8.5	3.5	0.35	1.7	0.94	27.2

EVERGLORY INDUSTRY CO., LIMITED

No. 29 Industrial Park North Road Wafangdian City Liaoning China

www.evergloryindustry.com

info@evergloryindustry.com

Tel / Whatsapp: 008613130008503



Bearing NO.	Boundary dimensions(mm)							Basic load ratings(kN)		Limiting speed(rpm)		Application point	Abutment and fillet dimensions(mm)						Value			Weight(kg)
	d	D	T	B	C	r _{1, 2min}	r _{3, 4min}	Cr	Cor	Grease	Oil		a	d _{a max}	d _{b min}	D _{a max}	D _{b min}	r _{a max}	r _{b max}	e	Y	
LM961548/LM961510	342.9	457.098	66.675	63.5	46.038	3.2	3.2	729	1670	670	900	122.3	356	365	421	443	3.2	3.2	0.71	0.84	0.46	28.2
LM961548/LM961511	342.9	457.098	68.262	63.5	47.625	3.3	3.3	705	1640	670	900		367	363	423	443	3.3	3.3	0.71	0.84	0.46	30
EE971354/972100	342.9	533.4	76.2	76.2	50.8	4.7	3.3	1060	1800	670	900	78.4	390	371	497	510	4.7	3.3	0.33	1.8	0.99	54.4
EE161363/161850	346.075	469.9	60.325	55.562	38.1	7	6.4	710	1420	670	900	92.7	385	366	441	459	7	6.4	0.5	1.2	0.66	26.4
EE161363/161900	346.075	482.6	60.325	55.562	38.1	7	6.4	710	1420	630	850	92.7	385	366	447	464	7	6.4	0.5	1.2	0.6	29.2
EE203136/203190	346.075	482.6	66.675	63.5	44.45	6.8	6.8	810	1560	630	850	84.9	385	366	450	467	6.8	6.8	0.42	1.4	0.79	32.2
EE203137/203190	346.075	482.6	66.675	63.5	44.45	12.7	6.8	810	1560	630	850	84.9	391	366	450	467	12.7	6.8	0.42	1.4	0.79	32
EE161363/161925	346.075	488.95	60.325	55.562	38.1	7	6.4	710	1420	630	850	92.7	385	366	451	468	7	6.4	0.5	1.2	0.66	30.7
HM262748/HM262710	346.075	488.95	95.25	95.25	74.613	6.4	3.2	1350	2900	630	850	88.5	366	381	450	467	6.4	3.2	0.33	1.79	0.99	53.3
HM262749/HM262710	346.075	488.95	95.25	95.25	74.612	6.4	3.3	1250	2600	630	850	87.8	386	364	457	475	6.4	3.3	0.33	1.8	0.99	52.9
EE333137/333197	349.25	501.65	90.488	84.138	69.85	6.4	3.3	1320	2720	630	850	95	394	371	470	488	6.4	3.3	0.37	1.6	0.9	55.8
EE161394/161850	354.012	469.9	60.325	55.562	38.1	7	6.4	710	1420	630	850	92.7	389	370	441	459	7	6.4	0.5	1.2	0.66	24.5
EE161394/161900	354.012	482.6	60.325	55.562	38.1	7	6.4	710	1420	630	850	92.7	389	370	447	464	7	6.4	0.5	1.2	0.66	27.3
EE161394/161925	354.012	488.95	60.325	55.562	38.1	7	6.4	710	1420	630	850	92.7	389	370	451	468	7	6.4	0.5	1.2	0.66	28.8
L163149/L163110	355.6	444.5	60.325	60.325	47.625	3.5	3.3	660	1660	630	850	67.9	381	369	423	435	3.5	3.3	0.31	2	1.1	20.6
EE161400/161850	355.6	469.9	60.325	55.562	38.1	7	6.4	710	1420	630	850	92.7	390	370	441	459	7	6.4	0.5	1.2	0.66	24.1
EE161400/161900	355.6	482.6	60.325	55.562	38.1	7	6.4	710	1420	630	850	92.7	390	370	447	464	7	6.4	0.5	1.2	0.66	26.9
EE161400/161925	355.6	488.95	60.325	55.562	38.1	7	6.4	710	1420	630	850	92.7	390	370	451	468	7	6.4	0.5	1.2	0.66	28.4
EE231400/231975	355.6	501.65	74.612	66.675	50.8	6.4	3.3	795	1640	630	850	97	403	382	472	489	6.4	3.3	0.44	1.4	0.75	40.5
EE333140/333197	355.6	501.65	90.488	84.138	69.85	6.4	3.3	1320	2720	630	850	95	397	374	470	488	6.4	3.3	0.37	1.6	0.9	53.5
EE231400/232025	355.6	514.35	74.612	66.675	50.8	6.4	3.3	795	1640	630	850	97	403	382	478	495	6.4	3.3	0.44	1.4	0.75	44.6
EE121140/121265	355.6	673.1	152.4	152.4	114.3	16	6.4	3400	5490	630	850	229.9	395	436	595	620	16	6.4	0.38	1.59	0.88	234
LL562749/LL562710	361.95	406.4	23.812	23.812	17.462	2.3	1.5	173	470	630	850		372	371	396	401	2.3	1.5	0.4	1.49	0.82	3.56
HM265049/HM265010	368.249	523.875	101.6	101.6	79.375	6.4	6.4	1590	3390	600	800	94	388	407	484	500	6.4	6.4	0.33	1.8	0.99	56.6
EE181453/182350	368.3	596.9	95.25	92.075	60.325	9.7	6.4	1670	2870	600	800	102.6	428	403	549	570	9.7	6.4	0.41	1.5	0.8	92.7
EE321145/321240	368.3	609.6	142.875	139.7	111.125	8	6.4	2460	4600	600	800	118.9	431	401	556	587	8	6.4	0.36	1.7	0.93	154
EE231462/231975	371.475	501.65	74.612	66.675	50.8	6.4	3.3	795	1640	600	800	97	411	390	472	489	6.4	3.3	0.44	1.4	0.75	35.8
EE231462/232025	371.475	514.35	74.612	66.675	50.8	6.4	3.3	795	1640	600	800	97	411	390	478	495	6.4	3.3	0.44	1.4	0.75	39.8
LL264648/LL264610	374.65	431.8	28.575	28.575	20.638	3.6	3.2	222	622	600	800	56.9	389	393	415	419	3.6	3.2	0.33	1.8	0.99	6.02
LM565943/LM565910	374.65	522.288	85.725	84.138	61.912	6.4	3.3	1210	2550	600	800	92.9	417	393	490	508	6.4	3.3	0.39	1.6	0.86	51.3
EE192148/192200	377.825	508	63.5	58.738	38.1	6.4	3.3	725	1490	600	800	103.9	418	397	480	495	6.4	3.3	0.53	1.1	0.62	31.1
LM565946/LM565910	377.825	522.288	85.725	84.138	61.912	6.4	3.3	1210	2550	600	800	92.9	418	395	490	508	6.4	3.3	0.39	1.6	0.86	50
LM565946/LM565912	377.825	523.875	85.725	84.138	61.913	6.4	3.2	1170	2590	600	800	92.8	398	414	481	497	6.4	3.2	0.38	1.56	0.86	51.9
L865547/L865512	381	479.425	49.212	47.625	34.925	6.4	3.3	585	1310	600	800	92	412	394	456	469	6.4	3.3	0.49	1.2	0.67	18.9
L865548/L865512	381	479.425	49.213	47.625	34.925	12.7	3.2	595	1280	600	800	91.4	413	405	454	466	12.7	3.2	0.49	1.23	0.68	18.6
EE192150/192200	381	508	63.5	58.738	38.1	6.4	3.3	725	1490	600	800	103.9	420	399	480	495	6.4	3.3	0.53	1.1	0.62	30.3
LM565949/LM565910	381	522.288	85.725	84.138	61.912	6.4	3.3	1210	2550	600	800	92.9	420	396	490	508	6.4	3.3	0.39	1.6	0.86	48.8
LM565949/LM565912	381	523.875	85.725	84.138	61.913	6.4	3.2	1170	2590	600	800	92.8	401	414	481	497	6.4	3.2	0.38	1.56	0.86	50.7
HM266446/HM266410	381	546.1	104.775	104.775	82.55	6.4	6.4	1900	4210	600	800	97.6	401	421	505	515	6.4	6.4	0.33	1.8	0.99	79.5
HM266447/HM266410	381	546.1	104.775	104.775	82.55	6.4	6.4	1840	4000	600	800	97.5	428	405	508	531	6.4	6.4	0.33	1.8	0.99	78.3
M268730/M268710	381	590.55	114.3	114.3	88.9	6.4	6.4	1980	4470	600	800	103.7	401	459	545	560	6.4	6.4	0.33	1.8	0.99	116
LL365348/LL365310	384.175	441.325	28.575	28.575	20.638	3.5	3.3	247	655	560	750	59.2	402	394	427	435	3.5	3.3	0.34	1.8	0.97	6.33
LL365347/LL365310	384.175	441.325	28.575	31.75	20.638	3.6	3.2	236	612	560	750	58.6	398	398	424	428	3.6	3.2	0.34	1.76	0.97	5.66
HM266448/HM266410	384.175	546.1	104.775	104.775	82.55	6.4	6.4	1900	4210	560	750	97.6	404	421	505	515	6.4	6.4	0.33	1.8	0.99	78
HM266449/HM266410	384.175	546.1	104.775	104.775	82.55	6.4	6.4	1840	4000	560	750	97.5	429	407	508	531	6.4	6.4	0.33	1.8	0.99	76.7
LM665949/LM665910	385.762	514.35	82.55	82.55	63.5	6.4	3.3	1180	2610	560	750	99	424	401	485	504	6.4	3.3	0.42	1.4	0.79	45.2
M667935/M667910	387.248	546.1	87.313	87.313	66.675	6.4	6.4	1330	2870	560	750	105.1	407	438	510	525	6.4	6.4	0.42	1.44	0.79	61.6
M667935/M667911G2	387.248	546.1	87.312	87.312	68.262	6.4	6.4	1390	3150	560	750		424	414	510	528	6.4	6.4	0.42	1.43	0.79	56.6
EE234154/234215	393.7	546.1	76.2	61.12	55.562	6.4	6.4	815	1650	600	800	112.9	438	417	507	529	6.4	6.4	0.48	1.3	0.69	44.8
EE234154/234220	393.7	558.8	65.088	61.119	44.45	6.4	6.4	815	1650	600	800	101.8	438	417	516	536	6.4	6.4	0.48	1.3	0.69	44.3
EE234156/234215	396.875	546.1	76.2	61.12	55.562	6.4	6.4	815	1650	600	800	112.9	439	419	507	529	6.4	6.4	0.48	1.3	0.69	43.9
LM567943/LM567910	396.875	549.275	85.725	84.138	61.912	6.4	3.3	1260	2720	600	800	101.1	442	420	517	535	6.4	3.3	0.41	1.5	0.81	57.1
EE234156/234220	396.875	558.8	65.088	61.12	44.45	6.4	6.4	815	1650	600	800	101.8	439	419	516	536	6.4	6.4	0.48	1.3	0.69	43.4
LL566848/LL566810	403.225	460.375	28.575	28.575	20.638	3.5	3.3	246	765	600	800	70	420	417	443	448	3	3	0.4	1.5	0.8	6.7



EVERGLORY INDUSTRY CO., LIMITED

No. 29 Industrial Park North Road Wafangdian City Liaoning China

www.evergloryindustry.com

info@evergloryindustry.com

Tel / Whatsapp: 00861313000850

Bearing NO.	Boundary dimensions(mm)							Basic load ratings(kN)		Limiting speed(rpm)		Application point	Abutment and fillet dimensions(mm)						Value			Weight(kg)
	d	D	T	B	C	r _{1, 2min}	r _{3, 4min}	Cr	Cor	Grease	Oil		a	d _{a max}	d _{b min}	D _{a max}	D _{b min}	r _{a max}	r _{b max}	e	Y	
L467549/L467510	406.4	508	61.912	61.912	47.625	3.3	3.3	800	1960	560	750	83.3	435	420	484	498	3.3	3.3	0.37	1.6	0.9	27.6
EE234160/234215	406.4	546.1	76.2	61.12	55.562	6.4	6.4	815	1650	560	750	112.9	444	424	507	529	6.4	6.4	0.48	1.3	0.69	44.3
M667944/M667911	406.4	546.1	87.313	87.313	68.263	6.4	6.4	1330	2870	560	750	105.1	427	438	510	525	6.4	6.4	0.42	1.44	0.79	53.7
LM567949/LM567910	406.4	549.275	85.725	84.138	61.912	6.4	3.3	1260	2720	530	700	101.1	447	425	517	535	6.4	3.3	0.41	1.5	0.81	53.2
EE234160/234220	406.4	558.8	65.088	61.12	44.45	6.4	6.4	815	1650	530	700	101.8	444	424	516	536	6.4	6.4	0.48	1.3	0.69	43.8
EE285160/285226	406.4	574.675	76.2	67.866	50.8	6.8	3.3	920	1850	530	700	114	453	429	534	552	6.8	3.3	0.5	1.2	0.66	53.2
EE833160X/833232	406.4	590.55	107.95	107.95	80.963	9.5	6.4	1780	3540	530	700	100	433	453	545	560	9.5	6.4	0.32	1.85	1.02	89.7
EE736160/736238	406.4	609.524	82.55	79.375	60.325	7.9	6.4	1520	3030	530	700	95.9	430	476	565	570	7.9	6.4	0.35	1.73	0.95	76.2
EE911600/912400	406.4	609.6	92.075	84.138	60.325	6.7	6.4	1430	2640	530	700	105.6	428	466	555	570	6.7	6.4	0.38	1.57	0.86	80.1
EE571602/572650	406.4	673.1	88.9	87.833	60.325	6.4	3.3	1750	3100	530	700	110	479	457	629	647	6.4	3.3	0.4	1.5	0.83	119
H969249/H969210	406.4	762	180.975	161.925	107.95	12.7	12.7	3690	6100	380	500	250	446	467	723	723	12	12	0.94	0.64	0.35	320
M667947/M667911	409.575	546.1	87.313	87.312	68.263	6.4	6.4	1330	2870	380	500	105.1	430	438	510	525	6.4	6.4	0.42	1.44	0.79	52.4
M667948/M667911	409.575	546.1	87.312	87.312	68.262	6.4	6.4	1350	3050	380	500		440	431	510	528	6.4	6.4	0.42	1.43	0.79	49.8
M667948/M667910	409.575	546.1	87.313	87.313	66.675	6.4	6.4	1330	2870	380	500	105.1	430	438	510	525	6.4	6.4	0.42	1.44	0.79	52.2
EE285162/285226	409.575	574.675	76.2	67.866	50.8	6.8	3.3	920	1850	380	500	114	455	431	534	552	6.8	3.3	0.5	1.2	0.66	52.1
EE911618/912400	411.162	609.6	92.075	84.138	60.325	6.8	6.4	1470	2750	500	670	103.9	461	440	566	586	6.8	6.4	0.38	1.6	0.86	80.7
M268749/M268710	415.925	590.55	114.3	114.3	88.9	6.4	6.4	1860	4250	500	670	105	437	459	545	560	6.4	6.4	0.34	1.8	1	94.5
M268749/M268710	415.925	590.55	114.3	114.3	88.9	6.4	6.4	2120	4800	500	670	104	448	453	560	563	6	6	0.33	1.8	1	120
EE328167/328269	425.45	685.698	142.875	142.8	104.775	12.7	6.4	3050	5700	500	670	135.1	497	462	630	661	12.7	6.4	0.4	1.5	0.83	193
EE241693/242375	430.212	603.25	76.2	73.025	50.8	6.4	6.4	1240	2250	500	670	122.1	479	457	564	585	6.4	6.4	0.52	1.1	0.63	62
EE80385/80325	431.8	533.4	46.038	46.038	34.925	3.3	3.3	580	1380	500	670	69.3	458	447	511	521	3.3	3.3	0.31	2	1.1	20.8
80170/80217	431.8	552.45	44.45	44.45	31.75	3.3	3.3	610	1480	500	670	71	467	456	530	538	3.3	3.3	0.32	1.9	1	25.8
EE239170/239225	431.8	571.5	73.025	73.025	53.975	3.2	3.2	980	2150	500	670	96.5	446	469	535	540	3.2	3.2	0.38	1.57	0.86	45.6
80170/80222	431.8	565.15	44.45	44.45	31.75	3.3	3.3	610	1480	500	670	71	467	456	536	545	3.3	3.3	0.32	1.9	1	28.6
LM869448/LM869410	431.8	571.5	74.612	74.612	52.388	3.3	3.3	1080	2350	500	670	122.6	471	448	539	560	3.3	3.3	0.55	1.1	0.6	47.9
EE239170/239225A	431.8	571.5	76.2	73.025	57.15	3.2	3.2	980	2150	500	670	99.7	446	469	535	540	3.2	3.2	0.38	1.57	0.86	46.8
BT1B328284/HA1	431.8	571.5	89.694	89.77	66.75	6.4	6.4	1450	3450	500	670	111	464	460	540	550	6	6	0.44	1.35	0.8	60
EE241701/242375	431.8	603.25	76.2	73.025	50.8	6.4	6.4	1240	2500	480	600	122.1	480	458	564	585	6.4	6.4	0.52	1.1	0.63	61.4
EE571703/572650	431.8	673.1	88.9	87.833	60.325	6.4	3.3	1750	3100	480	600	110	491	469	629	647	6.4	3.3	0.4	1.5	0.83	108
EE737173/737260	441.325	660.4	91.28	85.725	62.705	10.4	6.4	1350	2630	480	600	109.5	470	510	600	610	10.4	6.4	0.37	1.6	0.88	95.5
M270744/M270710	444.5	635	120.65	120.65	95.25	6.4	6.4	2290	5250	480	600	113.8	465	495	585	600	6.4	6.4	0.33	1.8	0.99	120
80176/80217	447.675	552.45	44.45	44.45	31.75	3.3	3.3	610	1480	480	600	71	475	464	530	538	3.3	3.3	0.32	1.9	1	22
80176/80222	447.675	565.15	44.45	44.45	31.75	3.3	3.3	610	1480	480	600	71	475	464	536	545	3.3	3.3	0.32	1.9	1	24.8
M270749/M270710	447.675	635	120.65	120.65	95.25	6.4	6.4	1900	4350	450	600	114.6	502	474	591	617	6.4	6.4	0.33	1.8	0.99	117
LM770945/LM770910	450.85	603.25	85.725	84.138	60.325	6.4	3.3	1310	2900	450	600	115.9	496	471	570	590	6.4	3.3	0.45	1.3	0.73	62.5
EE737179X/737262	456.692	660.4	92.075	91.262	63.5	6.4	6.4	1350	2630	450	600	110.3	478	510	600	610	6.4	6.4	0.37	1.6	0.88	90.5
EE425179A/425299	456.794	761.873	142.875	142.875	101.6	16	6.4	3240	5610	450	600	154.5	497	530	685	710	16	6.4	0.44	1.35	0.74	242
L570648/L570610	457.073	573.088	74.613	74.612	57.15	6.4	6.4	1100	2930	450	600	100.4	478	484	540	550	6.4	6.4	0.4	1.49	0.82	42.8
80180/80217	457.2	552.45	44.45	44.45	31.75	3.3	3.3	615	1340	450	600		474	471	531	536	3.3	3.3	0.32	1.88	1.04	18.7
L570649/L570610	457.2	573.088	74.612	74.612	57.15	6.4	6.4	1020	2610	500	670	101.2	493	472	542	562	6.4	6.4	0.4	1.5	0.83	42
EE244180/244235	457.2	596.9	76.2	73.025	53.975	9.5	3.3	1040	2360	500	670	102	500	475	565	580	9.5	3.3	0.4	1.5	0.82	49.9
LM770949/LM770910	457.2	603.25	85.725	84.138	60.325	6.4	3.3	1310	2900	480	630	115.9	499	474	570	590	6.4	3.3	0.45	1.3	0.73	59.5
LM272235/LM272210	457.2	615.95	85.725	85.725	66.675	6.4	6.4	1470	3800	450	600	98	489	512	584	596	6	6	0.33	1.8	1	72
EE737181/737260	457.2	660.4	91.28	85.725	62.705	10.4	6.4	1550	2780	450	600	106.9	507	479	615	636	10.4	6.4	0.37	1.6	0.88	86.2
EE737181/737262	457.2	660.4	92.075	85.725	63.5	10.4	6.4	1350	2630	450	600	110.3	486	510	600	610	10.4	6.4	0.37	1.6	0.88	88.5
EE671801/672873	457.2	730.148	120.65	114.3	82.55	9.5	6.4	2420	4120	450	600	128.9	484	520	660	680	9.5	6.4	0.39	1.53	0.84	163
LL771948/LL771911	476.25	565.15	41.275	41.275	31.75	3.3	3.3	535	1340	450	600	100.2	502	489	545	557	3.3	3.3	0.47	1.3	0.7	18.2
M272749/M272710	479.425	679.45	128.588	128.588	101.6	6.4	6.4	2800	6400	450	600	121.1	535	504	635	663	6.4	6.4	0.34	1.8	0.97	148
80480/80425	482.6	615.95	53.975	46.038	41.275	3.3	3.3	780	1700	450	600	90	516	503	588	600	3.3	3.3	0.35	1.7	0.95	35.2
LM272249/LM272210	482.6	615.95	85.725	85.725	66.675	6.4	6.4	1390	3450	450	600	106.1	522	501	582	604	6.4	6.4	0.37	1.6	0.88	59.8
EE243190/243250	482.6	634.873	80.962	80.962	63.5	6.4	3.3	1340	3300	450	600	99.1	530	508	606	622	6.4	3.3	0.34	1.8	0.97	67.6
EE640191/640260	488.671	660.4	93.662	94.458	69.85	6.4	6.4	1700	3800	450	600	98.2	535	511	624	643	6.4	6.4	0.31	2	1.1	87.7
LM772748/LM772710	488.95	634.873	84.138	84.138	61.912	6.4	3.3	1370	3200	450	600	124.7	532	508	602	623	6.4	3.3	0.47	1.3	0.7	63.9
EE640192/640260	488.95	660.4	93.662	94.458	69.85	6.4	6.4	1700	3800	450	600	98.2	535	511	624	643	6.4	6.4	0.31	2	1.1	87.6

EVERGLORY INDUSTRY CO., LIMITED

No. 29 Industrial Park North Road Wafangdian City Liaoning China

www.evergloryindustry.com

info@evergloryindustry.com

Tel / Whatsapp: 008613130008503



Bearing NO.	Boundary dimensions(mm)								Basic load ratings(kN)		Limiting speed(rpm)		Applicati on point	Abutment and fillet dimensions(mm)						Value			Weight(kg)
	d	D	T	B	C	r _{1, 2min}	r _{3, 4min}	Cr	Cor	Grease	Oil	a	d _{a max}	d _{b min}	D _{a max}	D _{b min}	r _{a max}	r _{b max}	e	Y	Y ₀	Refer	
EE243192/243250	489.026	634.873	80.962	80.962	63.5	6.4	3.3	1340	3300	450	600	99.1	533	512	606	622	6.4	3.3	0.34	1.8	0.97	64.5	
EE243197/243250	498.323	634.873	80.963	80.962	63.5	6.4	3.2	1320	3290	450	600	100	520	530	595	605	6.4	3.2	0.34	1.75	0.96	58.7	
EE243196AX/243250	498.399	634.873	80.962	80.962	63.5	6.4	3.3	1470	3650	450	600	100	530	522	616	610	6	3	0.35	1.7	0.9	60	
EE243196/243250	498.475	634.873	80.962	80.962	63.5	6.4	3.3	1340	3300	450	600	99.1	538	516	606	622	6.4	3.3	0.34	1.8	0.97	59.9	
EE243196AS/243250	498.653	634.873	80.962	80.962	63.5	6.4	3.3	1470	3650	450	600	100	530	522	616	610	6	3	0.35	1.7	0.9	59.5	
M274149/M274110	501.65	711.2	136.526	136.525	106.363	6.4	6.4	2800	6410	450	600	126.8	525	550	655	675	6.4	6.4	0.33	1.8	0.99	164	
EE981992/982900	505.968	736.6	88.9	81.758	53.975	6.4	3.3	1620	3400	450	600	134.9	571	547	693	712	6.4	3.3	0.48	1.3	0.69	114	
EE982003/982900	508	736.6	88.9	81.758	53.975	6.4	3.3	1620	3400	450	600	134.9	572	548	693	712	6.4	3.3	0.48	1.3	0.69	113	
EE426200/426330	508	838.2	146.03	139.7	104.775	9.5	9.5	3320	5860	400	530	170.6	540	590	755	780	9.5	9.5	0.48	1.26	0.69		
EE982028/982900	514.35	736.6	88.9	81.758	53.975	6.4	3.3	1620	3400	400	530	134.9	576	551	693	712	6.4	3.3	0.48	1.3	0.69	109	
EE982051/982900	520.7	736.6	88.9	81.758	53.975	6.4	3.3	1620	3400	400	530	134.9	579	554	693	712	6.4	3.3	0.48	1.3	0.69	106	
LL575343/LL575310	533.4	635	50.8	50.8	38.1	6.4	6.4	705	1800	400	530	101.4	566	549	610	626	6.4	6.4	0.4	1.5	0.82	28.2	
EE522102/523087	533.4	784.225	88.9	82.55	53.975	6.4	6.4	1750	3500	380	500	139.5	596	573	730	752	6.4	6.4	0.48	1.3	0.69	129	
M276449/M276410	536.575	761.873	146.05	146.05	114.3	6.4	6.4	3360	8000	380	500	134	564	582	726	735	6	6	0.33	1.8	1	208	
LL575349/LL575310	539.75	635	50.8	50.8	38.1	6.4	6.4	705	1800	430	560	101.4	569	552	610	626	6.4	6.4	0.4	1.5	0.82	26.1	
EE542215/542290	546.1	736.6	76.2	76.2	50.8	6.4	6.4	1280	2590	400	530	142.2	598	574	695	715	6.4	6.4	0.51	1.2	0.65	79.7	
L476549/L476510	549.275	692.15	80.962	80.962	61.912	6.4	6.4	1430	3550	560	750	113.1	591	568	658	679	6.4	6.4	0.38	1.6	0.88	67.4	
EE542220/542290	558.8	736.6	76.2	76.2	50.8	6.4	6.4	1280	2590	380	500	142.2	604	581	695	715	6.4	6.4	0.51	1.2	0.65	73.2	
EE843220/843290	558.8	736.6	88.108	88.108	63.5	6.4	6.4	1750	3900	380	500	111.3	606	585	699	718	6.4	6.4	0.34	1.8	0.97	93.7	
LM377448/LM377410	558.8	736.6	104.775	104.775	80.963	6.4	6.4	2090	4940	380	500	120.3	580	600	690	705	6.4	6.4	0.35	1.73	0.95	114	
LM377449/LM377410	558.8	736.6	104.775	104.775	80.962	6.4	6.4	2300	5600	380	500	120.7	607	581	696	720	6.4	6.4	0.35	1.7	0.95	118	
M278749/M278710	571.5	812.8	155.575	155.575	120.65	6.4	6.4	4000	9300	370	470	143.6	634	601	759	790	6.4	6.4	0.33	1.8	0.99	256	
M278749/M278710	571.6	812.8	155.575	158.75	120.65	6.4	6.4	3790	8760	370	470	143.2	595	630	750	775	6.4	6.4	0.33	1.8	0.99	254	
LL778149/LL778110	584.2	685.8	49.212	49.212	34.925	3.5	3.3	735	1970	370	470	114.3	613	599	663	675	3.5	3.3	0.44	1.4	0.75	29.6	
EE662303/663550	584.2	901.7	150.02	139.7	107.95	7.9	9.5	3900	7360	360	460	152.6	610	670	830	840	7.9	9.5	0.33	1.81	1	319	
680235/680270	596.9	685.8	31.75	31.75	25.4	3.5	3.3	380	995	340	450	124.9	621	610	664	675	3.5	3.3	0.52	1.1	0.63	17.4	
EE649237/649310	602.945	787.4	93.662	93.662	69.85	6.4	6.4	2000	4800	340	450	129.2	655	629	749	771	6.4	6.4	0.37	1.6	0.89	115	
EE649239/649310	607.72	787.4	93.662	93.662	69.85	6.4	6.4	2000	4800	340	450	129.2	658	631	749	771	6.4	6.4	0.37	1.6	0.89	111	
EE649238/649310	609.345	787.4	93.662	93.662	69.85	6.4	6.4	1980	4970	340	450	126.9	635	650	740	750	6.4	6.4	0.37	1.61	0.89	112	
L879946/L879910	609.397	762	95.25	92.075	71.438	6.4	6.4	1700	4510	340	450	153	635	640	720	740	6.4	6.4	0.49	1.23	0.67	91.4	
L879947/L879910	609.6	762	95.25	92.075	71.438	6.4	6.4	1780	4700	340	450	152.9	656	627	722	750	6.4	6.4	0.49	1.2	0.68	93.3	
L580049/L580010	609.6	774.7	85.725	79.375	60.32	6.4	6.4	1780	4250	340	450	130.5	654	634	737	755	6.4	6.4	0.4	1.5	0.82	90.1	
EE649240/649310	609.6	787.4	93.662	93.662	69.85	6.4	6.4	2000	4800	340	450	129.2	659	632	749	771	6.4	6.4	0.37	1.6	0.89	110	
EE649240AX/649310	609.6	787.4	93.662	93.662	69.85	6.4	6.4	2000	4800	340	450	125	637	643	760	755	6	6	0.37	1.6	0.9	110	
EE743240/743320	609.6	812.8	82.55	82.55	60.325	6.4	6.4	1910	4290	340	450	112.7	635	660	755	765	6.4	6.4	0.33	1.83	1.01	112	
80780/80720	635	736.6	57.15	53.975	41.275	3.3	3.3	870	2500	340	450	125	664	648	712	726	3.3	3.3	0.44	1.4	0.75	36.6	
M281635/M281610	653.928	933.45	179.388	177.8	141.288	12	6.4	5040	11500	320	430	167.7	690	720	870	890	12	6.4	0.33	1.8	0.99	384	
L281146/L281110	660.235	812.8	95.25	95.25	73.025	6.4	6.4	2000	5270	320	430	123.8	685	695	775	790	6.4	6.4	0.33	1.8	0.99	100	
L281147/L281110	660.4	812.8	95.25	95.25	73.025	6.4	6.4	2000	5270	320	430	123.8	685	695	775	790	6.4	6.4	0.33	1.8	0.99	100	
L281148/L281110	660.4	812.8	95.25	95.25	73.025	6.4	6.4	2200	5900	320	430	123.1	701	678	778	799	6.4	6.4	0.33	1.8	0.99	105	
EE749260/749336	660.4	854.075	85.725	85.468	60.325	9.7	6.4	2000	4650	320	430	124.5	712	690	813	831	9.7	6.4	0.35	1.7	0.94	119	
LL481448/LL481411	673.1	793.75	66.675	61.912	49.212	6.4	6.4	995	2660	320	430	119.7	708	691	764	781	6.4	6.4	0.36	1.7	0.92	52	
LM281849/LM281810	679.45	901.7	142.875	142.875	111.125	9.7	6.4	3580	9000	280	380	149	730	728	870	867	9	6	0.33	1.8	1	242	
EE655270/655345	685.8	876.3	93.662	92.075	69.85	6.4	6.4	2160	5550	300	400	149.9	737	712	832	857	6.4	6.4	0.42	1.4	0.79	134	
EE755280/755360	711.2	914.4	85.725	82.55	60.325	6.4	6.4	1870	4800	280	380	140.5	767	746	870	891	6.4	6.4	0.38	1.6	0.87	136	
EE755282/755360	719.854	914.4	84.138	80.963	60.325	4.8	6.4	1760	4470	280	380	139.3	740	780	870	870	4.8	6.4	0.38	1.58	0.87	123	
EE755285/755360	723.9	914.4	84.138	80.962	60.325	3.3	6.4	1870	4800	280	380	140.5	770	752	870	891	3.3	6.4	0.38	1.6	0.87	126	
LL582949/LL582910B	736.6	825.5	31.75	31.75	25.4	3.5	3.3	429	1370	300	400	119	754	767	804	809	3	3	0.4	1.5	0.8	22.5	
LL582949/LL582910	736.6	825.5	31.75	31.75	25.4	3.6	3.2	497	1550	300	400	117	755	760	800	800	3.6	3.2	0.4	1.51	0.83	21.3	
EE752295/752380	749.3	965.2	93.663	80.963	66.675	6.4	3.2	1830	4790	280	380	159.7	775	820	910	920	6.4	3.2	0.4	1.49	0.82	152	
LM283649/LM283610	749.3	990.6	159.5	160.338	123	6.4	6.4	4400	11700	280	380	165.2	815	782	938	969	6.4	6.4	0.33	1.8	0.99	329	
LL783647/LL783610	758.825	901.7	66.675	65.088	46.038	6.4	6.4	1410	3790	280	380	149.9	785	790	870	870	6.4	6.4	0.44	1.36	0.75	71.2	
LL483448/33483418	759.925	889	69.85	69.85	50.8	3.3	3.3	1230	3800	280	380	132	782	785	867	858	3	3	0.37	1.6	0.9	67.5	
L183448/L183410	759.925	889	88.9	88.9	72	3.3	3.3	1940	6200	260	360	123	782	785	867	872	3	3	0.3	2	1.1	94	



EVERGLORY INDUSTRY CO., LIMITED

No. 29 Industrial Park North Road Wafangdian City Liaoning China

www.evergloryindustry.com

info@evergloryindustry.com

Tel / Whatsapp: 008613130008503

Bearing NO.	Boundary dimensions(mm)							Basic load ratings(kN)		Limiting speed(rpm)		Applicati on point	Abutment and fillet dimensions(mm)							Value			Weight(kg)
	d	D	T	B	C	r _{1, 2min}	r _{3, 4min}	Cr	Cor	Grease	Oil		a	d _{a max}	d _{b min}	D _{a max}	D _{b min}	r _{a max}	r _{b max}	e	Y	Y ₀	
EE175301/175350	762	889	63.5	63.5	50.8	3.3	3.3	1160	3450	280	380	131.4	797	780	861	876	3.3	3.3	0.38	1.6	0.87	64.4	
EE175300/175350	762	889	69.85	69.85	50.8	3.2	3.2	1290	3920	280	380	132.3	780	790	860	860	3.2	3.2	0.38	1.58	0.87	69	
LL483449/LL483418	762	889	69.85	69.85	50.8	3.3	3.3	1160	3450	280	380	133.8	797	780	861	875	3.3	3.3	0.38	1.6	0.87	68.1	
L183449/L183410	762	889	88.9	88.9	72	3.3	3.3	1940	6200	260	360	123	784	785	867	872	3	3	0.3	2	1.1	92.5	
LL783649/LL783610	762	901.7	66.675	65.088	46.038	6.4	6.4	1410	3790	260	360	149.9	785	790	870	870	6.4	6.4	0.44	1.36	0.75	69.3	
EE752300/752380	762	965.2	93.662	80.962	66.675	6.4	3.3	2100	5200	260	360	158.8	815	793	926	943	6.4	3.3	0.4	1.5	0.83	147	
EE752306/752380	774.7	965.2	93.663	80.962	66.675	6.4	3.2	1830	4790	240	340	159.7	800	820	910	920	6.4	3.2	0.4	1.49	0.82	133	
EE752305/752380	774.7	965.2	93.662	80.962	66.675	6.4	3.3	2100	5200	240	340	158.8	822	800	926	943	6.4	3.3	0.4	1.5	0.83	137	
EE157337/157430	857.25	1092.2	120.65	111.125	76.2	19	6.4	2810	7350	200	300	228	912	912	1062	1047	18	6	0.57	1.05	0.6	245	
EE158350/158442	889	1123.95	120.65	111.125	76.2	19	6.4	2860	6850	200	300	199	940	940	1070	1080	19	6.4	0.45	1.34	0.73	237	
LL687949/LL687910	977.9	1130.3	66.675	63.5	47.625	6.4	6.4	1460	4350	180	260	182.9	1019	1002	1095	1112	6.4	6.4	0.43	1.4	0.76	101	
EE168400/168500	1016	1270	101.6	101.6	66.675	9.7	9.7	2750	7500			229	1054	1087	1232	1214	9	9	0.5	1.2	0.7	275	
LL788349/LL788310	1066.8	1219.2	65.088	65.088	42.862	3.3	3.3	1520	4750			209	1106	1090	1187	1202	3.3	3.3	0.47	1.3	0.7	108	
EE776420/776520	1066.8	1320.8	95.25	88.9	69.85	6.4	6.4	2660	7140			170.5	1090	1140	1260	1280	6.4	6.4	0.57	1.05	0.58	270	
EE776430/776520	1092.2	1320.8	95.25	88.9	69.85	6.4	6.4	2730	7650			270.7	1153	1128	1269	1301	6.4	6.4	0.57	1.1	0.58	249	
EE277455/277565	1155.7	1435.1	120.65	120.65	95.25	6.4	6.4	4150	12000			207.3	1227	1199	1377	1403	6.4	6.4	0.36	1.7	0.92	431	
LL889049/LL889010	1270	1435.1	69.85	65.088	47.625	6.4	6.4	1630	5550			285.4	1315	1294	1392	1413	6.4	6.4	0.57	1.1	0.58	144	



EVERGLORY INDUSTRY CO., LIMITED

No. 29 Industrial Park North Road Wafangdian City Liaoning China

www.evergloryindustry.com

info@evergloryindustry.com

Tel / Whatsapp: 008613130008503