

Single Row Cylindrical Roller Bearings

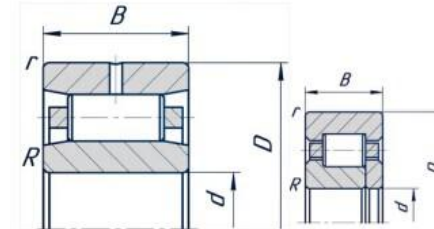

| Bearing NO. | | Boundary dimensions(mm) | | | | | | | Basic load ratings(kN) | | Limiting speed(rpm) | | Abutment and fillet dimensions(mm) | | | | | | Weight(kg) |
|-------------|---------|-------------------------|-----|----|----------------------|----------------------|-------|-------|------------------------|-----|---------------------|------|------------------------------------|--------------------|--------------------|--------------------|--------------------|--------------------|------------|
| New | Old | d | D | B | r _{1, 2min} | r _{3, 4min} | Fw | Ew | Cr | Cor | Grease | Oil | d _{a min} | d _{b min} | D _{a max} | D _{b max} | r _{a max} | r _{b max} | Refer |
| N220M | 2220 | 100 | 180 | 34 | 2.1 | 2.1 | | 160 | 190 | 260 | 3200 | 3800 | 114 | | | 166 | 2 | 2 | 3.45 |
| NJ220EM | | 100 | 180 | 34 | 2.1 | 2.1 | 119 | | 190 | 260 | 3200 | 3800 | | 114 | 169 | | 2 | 2 | 3.9 |
| NF220M | 12220 | 100 | 180 | 34 | 2.1 | 2.1 | | 160 | 190 | 260 | 3200 | 3800 | 114 | | | 166 | 2 | 2 | 3.55 |
| NU220M | 32220 | 100 | 180 | 34 | 2.1 | 2.1 | 120 | | 190 | 260 | 3200 | 3800 | | 114 | 169 | | 2 | 2 | 5.2 |
| NJ220EM | 42220 | 100 | 180 | 34 | 2.1 | 2.1 | 119 | | 190 | 260 | 3200 | 3800 | | 114 | 169 | | 2 | 2 | 3.9 |
| NU2220M | 32520 | 100 | 180 | 46 | 2.1 | 2.1 | 120 | | 260 | 390 | 3200 | 3800 | | 114 | 169 | | 2 | 2 | 5.2 |
| NU320EM | 32320EH | 100 | 215 | 47 | 3 | 3 | 127.5 | | 380 | 470 | 2400 | 3000 | | 116 | 202 | | 2.5 | 2.5 | 8.35 |
| N320EM | 2320EH | 100 | 215 | 47 | 3 | 3 | | 191.5 | 380 | 470 | 2400 | 3000 | 116 | | | 197 | 2.5 | 2.5 | 9.67 |
| N2320M | 2620 | 100 | 215 | 73 | 3 | 3 | | 185.5 | 440 | 630 | 2400 | 3000 | 116 | | | 197 | 2.5 | 2.5 | 13.1 |
| NU2320M | 32620 | 100 | 215 | 73 | 3 | 3 | 129.5 | | 440 | 630 | 2400 | 3000 | | 116 | 197 | | 2.5 | 2.5 | 13.2 |
| NJ2320M | 42620 | 100 | 215 | 73 | 3 | 3 | 129.5 | | 440 | 630 | 2400 | 3000 | | 116 | 197 | | 2.5 | 2.5 | 13.5 |
| NF1021M | 12121 | 105 | 160 | 26 | 2 | 1.1 | 119.5 | 145.5 | 120 | 176 | 4000 | 4800 | | 114 | 150 | | 2 | 1 | 1.93 |
| N1021M | 2121 | 105 | 160 | 26 | 2 | 1.1 | | 145.5 | 120 | 176 | 4000 | 4800 | 117 | | | 150 | 2 | 1 | 1.82 |
| N221M | 2221 | 105 | 190 | 36 | 2.1 | 2.1 | | 168.8 | 210 | 290 | 3000 | 3600 | 119 | | | 175 | 2 | 2 | 4.33 |
| NJ221M | 42221 | 105 | 190 | 36 | 2.1 | 2.1 | 126.8 | | 210 | 290 | 3000 | 3600 | | 121 | 179 | | 2 | 2 | 4.34 |
| N321EM | 2321EH | 105 | 225 | 49 | 3 | 3 | | 201 | 420 | 550 | 2200 | 2800 | 121 | | | 203 | 2.5 | 2.5 | 10.5 |
| NU321EM | 32321EH | 105 | 225 | 49 | 3 | 3 | 133 | | 420 | 550 | 2200 | 2800 | | 121 | 212 | | 2.5 | 2.5 | 10.6 |
| N421M | 2421 | 105 | 260 | 60 | 4 | 4 | | 220.5 | 550 | 700 | 2200 | 2800 | 121 | | | 224 | 3 | 3 | 17.2 |

| Bearing NO. | | Boundary dimensions(mm) | | | | | | | Basic load ratings(kN) | | | Limiting speed(rpm) | | Abutment and fillet dimensions(mm) | | | | | | Weight(kg) |
|-------------|---------|-------------------------|-----|----|----------------------|----------------------|-------|-------|------------------------|------|--------|---------------------|--------------------|------------------------------------|--------------------|--------------------|--------------------|--------------------|-------|------------|
| New | Old | d | D | B | r _{1, 2min} | r _{3, 4min} | Fw | Ew | Cr | Cor | Grease | Oil | d _{a min} | d _{b min} | D _{a max} | D _{b max} | r _{a max} | r _{b max} | Refer | |
| N1022M | 2122 | 110 | 170 | 28 | 2 | 1.1 | | 155 | 148 | 203 | 3800 | 4500 | 122 | | | 160 | | | 2.31 | |
| NU1022M | 32122 | 110 | 170 | 28 | 2 | 1.1 | 125 | | 148 | 203 | 3800 | 4500 | | 119 | 157 | | 2 | 1 | 2.32 | |
| NJ1022M | 42122 | 110 | 170 | 28 | 2 | 1.1 | 125 | | 148 | 203 | 3800 | 4500 | | 119 | 157 | | 2 | 1 | 2.39 | |
| N222M | 2222 | 110 | 200 | 38 | 2.1 | 2.1 | | 178.5 | 255 | 340 | 2800 | 3400 | 124 | | | 185 | 2 | 2 | 5.02 | |
| NU222M | 32222 | 110 | 200 | 38 | 2.1 | 2.1 | 132.5 | | 255 | 340 | 2800 | 3400 | | 124 | 185 | | 2 | 2 | 5.05 | |
| NJ222M | 42222 | 110 | 200 | 38 | 2.1 | 2.1 | 132.5 | | 255 | 340 | 2800 | 3400 | | 124 | 185 | | 2 | 2 | 5.1 | |
| NU2222EC | 32522 | 110 | 200 | 53 | | | 132 | | 380 | 520 | 2800 | 3400 | | 124 | 185 | | 2 | 2 | 7.73 | |
| N322EM | 2322EH | 110 | 240 | 50 | 3 | 3 | | 211 | 430 | 540 | 2000 | 2600 | 126 | | | 227 | 2.5 | 2.5 | 11.4 | |
| NU322M | 32322 | 110 | 240 | 50 | 3 | 3 | 143 | 207 | 400 | 525 | 2000 | 2600 | | 126 | 222 | | 2.5 | 2.5 | 11.6 | |
| NJ322M | 42322 | 110 | 240 | 50 | 3 | 3 | 143 | 207 | 400 | 525 | 2000 | 2600 | | 126 | 222 | | 2.5 | 2.5 | 11.8 | |
| NU2322EM | 32622EH | 110 | 240 | 80 | 3 | 3 | 143 | | 620 | 800 | 2000 | 2600 | | 126 | 222 | | 2.5 | 2.5 | 18.3 | |
| N422M | 2422 | 110 | 280 | 65 | 4 | 4 | | 235 | 580 | 735 | 2000 | 2600 | 130 | | | 252 | 3 | 3 | 21.8 | |
| NU422M | 32422 | 110 | 280 | 65 | 4 | 4 | 155 | | 580 | 735 | 2000 | 2600 | | 135 | 252 | | 3 | 3 | 22 | |
| NJ422M | 42422 | 110 | 280 | 65 | 4 | 4 | 155 | | 580 | 735 | 2000 | 2600 | | 135 | 252 | | 3 | 3 | 22.3 | |
| NU1024M | 32124 | 120 | 180 | 28 | 2 | 1.1 | 135 | | 139 | 210 | 3400 | 4000 | | 130 | 167 | | 2 | 1 | 2.96 | |
| NJ1024M | 42124 | 120 | 180 | 28 | 2 | 1.1 | 135 | | 139 | 210 | 3400 | 4000 | | 130 | 167 | | 2 | 1 | 3.09 | |
| N224M | 2224 | 120 | 215 | 40 | 2.1 | 2.1 | | 191.5 | 286 | 400 | 2400 | 3000 | 134 | | | 199 | 2 | 2 | 6.11 | |
| NU224EM | 32224EH | 120 | 215 | 40 | 2.1 | 2.1 | 143.5 | | 335 | 420 | 2400 | 3000 | | 134 | 199 | | 2 | 2 | 6.27 | |
| NJ224EM | 42224EH | 120 | 215 | 40 | 2.1 | 2.1 | 143.5 | | 335 | 420 | 2400 | 3000 | | 134 | 199 | | 2 | 2 | 6.72 | |
| N2224M | 2524 | 120 | 215 | 58 | 2.1 | 2.1 | | 191.5 | 360 | 550 | 2400 | 3000 | 134 | | | 199 | 2 | 2 | 8.92 | |
| NU2224M | 32524 | 120 | 215 | 58 | 2.1 | 2.1 | 143.5 | | 430 | 585 | 2400 | 3000 | | 134 | 199 | | 2 | 2 | 9.31 | |
| NJ2224M | 42524 | 120 | 215 | 58 | 2.1 | 2.1 | 143.5 | | 430 | 585 | 2400 | 3000 | | 134 | 199 | | 2 | 2 | 9.46 | |
| NF2224EM | 12524EH | 120 | 215 | 58 | 2.1 | 2.1 | | 195.5 | 410 | 620 | 2400 | 3000 | 130 | | | 199 | 2 | 2 | 9.72 | |
| N324M | 2324 | 120 | 260 | 55 | 3 | 3 | | 226 | 500 | 650 | 1900 | 2400 | 136 | | | 242 | 2.5 | 2.5 | 15.1 | |
| NF324M | 12324 | 120 | 260 | 55 | 3 | 3 | | 226 | 476 | 605 | 1900 | 2400 | 136 | | | 242 | 2.5 | 2.5 | 14.3 | |
| NU324EM | 32324EH | 120 | 260 | 55 | 3 | 3 | 154 | | 530 | 610 | 1900 | 2400 | | 136 | 242 | | 2.5 | 2.5 | 15.4 | |
| N2324M | 2624 | 120 | 260 | 86 | 3 | 3 | | 226 | 680 | 980 | 1900 | 2400 | 136 | | | 242 | 2.5 | 2.5 | 23.9 | |
| NU2324EM | 32624EH | 120 | 260 | 86 | 3 | 3 | 154 | | 795 | 1030 | 1900 | 2400 | | 136 | 242 | | 2.5 | 2.5 | 23.1 | |
| NJ2324EM | 42624EH | 120 | 260 | 86 | 3 | 3 | 154 | | 795 | 1030 | 1900 | 2400 | | 136 | 242 | | 2.5 | 2.5 | 23.4 | |
| N424M | 2424 | 120 | 310 | 72 | 5 | 5 | | 260 | 710 | 920 | 1900 | 2400 | 146 | | | 290 | 4 | 4 | 29 | |
| NU424M | 32424 | 120 | 310 | 72 | 5 | 5 | 170 | | 710 | 920 | 1900 | 2400 | | 146 | 290 | | 4 | 4 | 29.1 | |
| NJ424M | 42424 | 120 | 310 | 72 | 5 | 5 | 170 | | 710 | 920 | 1900 | 2400 | | 146 | 290 | | 4 | 4 | 29.7 | |
| N1026M | 2126 | 130 | 200 | 33 | 2 | 1.1 | | 182 | 180 | 280 | 3200 | 3800 | 142 | | | 189 | 2 | 1 | 4.52 | |
| NU1026M | 32126 | 130 | 200 | 33 | 2 | 1.1 | 148 | | 180 | 280 | 3200 | 3800 | | 140 | 187 | | 2 | 1 | 4.66 | |
| NU226EM | 32226EH | 130 | 230 | 40 | 3 | 3 | 153.5 | | 345 | 425 | 2200 | 2800 | | 146 | 212 | | 2.5 | 2.5 | 7.9 | |
| NJ226EM | 42226 | 130 | 230 | 40 | 3 | 3 | 153.5 | | 290 | 410 | 2200 | 2800 | | 146 | 212 | | 2.5 | 2.5 | 7.38 | |
| N2226M | 2526 | 130 | 230 | 64 | 3 | 3 | | 204 | 400 | 630 | 2200 | 2800 | 146 | | | 212 | 2.5 | 2.5 | 11.6 | |
| NU2226EM | 32526 | 130 | 230 | 64 | 3 | 3 | 153.5 | | 530 | 735 | 2200 | 2800 | | 146 | 212 | | 2.5 | 2.5 | 12.5 | |
| NJ2226EM | 42526 | 130 | 230 | 64 | 3 | 3 | 153.5 | | 530 | 735 | 2200 | 2800 | | 146 | 212 | | 2.5 | 2.5 | 12.9 | |
| NJ2226X3 | | 130 | 240 | 72 | | | 158 | | 630 | 850 | 2200 | 2800 | | 146 | 212 | | | | 14.8 | |
| N326M | 2326 | 130 | 280 | 58 | 4 | 4 | | 243 | 550 | 720 | 1800 | 2200 | 149 | | | 258 | 3 | 3 | 17.8 | |
| NU326EM | 32326EH | 130 | 280 | 58 | 4 | 4 | 167 | | 615 | 735 | 1800 | 2200 | | 149 | 258 | | 3 | 3 | 19.3 | |
| NJ326EM | 42326EH | 130 | 280 | 58 | 4 | 4 | 167 | | 615 | 735 | 1800 | 2200 | | 149 | 258 | | 3 | 3 | 19.5 | |
| N2326EM | 2626EH | 130 | 280 | 93 | | | | 243 | 920 | 1230 | 1800 | 2200 | 149 | | | 258 | 3 | 3 | 29 | |
| NU2326EM | 32626EH | 130 | 280 | 93 | 4 | 4 | 167 | | 920 | 1230 | 1800 | 2200 | | 149 | 258 | | 3 | 3 | 28.7 | |
| NJ2326EM | 42626EH | 130 | 280 | 93 | 4 | 4 | 167 | | 920 | 1230 | 1800 | 2200 | | 149 | 258 | | 3 | 3 | 28.9 | |
| NUP2326M | 92626 | 130 | 280 | 93 | 4 | 4 | 167 | | 920 | 1230 | 1800 | 2200 | | 149 | 258 | | 3 | 3 | 30.5 | |
| NU3028M | 3032128 | 140 | 210 | 53 | 2 | 2 | 158 | | 330 | 630 | 2600 | 3400 | | 152 | 196 | | 2 | 2 | 7.64 | |
| NU3128M | 3032728 | 140 | 225 | 68 | 2.1 | 2.1 | 162.5 | | 390 | 625 | 2600 | 3400 | | 155 | 209 | | 2 | 2 | 10.6 | |
| N228M | 2228 | 140 | 250 | 42 | 3 | 3 | | 221 | 345 | 490 | 2400 | 3000 | 157 | | | 232 | 2.5 | 2.5 | 9.14 | |

EVERGLORY INDUSTRY CO., LIMITED

No. 29 Industrial Park North Road Wafangdian City Liaoning China

www.evergloryindustry.com

info@evergloryindustry.com

Tel / Whatsapp: 008613130008503



| Bearing NO. | | Boundary dimensions(mm) | | | | | | | Basic load ratings(kN) | | Limiting speed(rpm) | | Abutment and fillet dimensions(mm) | | | | | | Weight(kg) |
|-------------|---------|-------------------------|-----|--------|----------------------|----------------------|-------|-------|------------------------|------|---------------------|------|------------------------------------|--------------------|--------------------|--------------------|--------------------|--------------------|------------|
| New | Old | d | D | B | r _{1, 2min} | r _{3, 4min} | Fw | Ew | Cr | Cor | Grease | Oil | d _{a min} | d _{b min} | D _{a max} | D _{b max} | r _{a max} | r _{b max} | Refer |
| NU228EM | 32228EH | 140 | 250 | 42 | 3 | 3 | 169 | | 395 | 515 | 2400 | 3000 | | 157 | 232 | | 2.5 | 2.5 | 9.36 |
| NJ228EM | 42228EH | 140 | 250 | 42 | 3 | 3 | 169 | | 395 | 515 | 2400 | 3000 | | 157 | 232 | | 2.5 | 2.5 | 9.43 |
| NUP228M | 92228 | 140 | 250 | 42 | 3 | 3 | 169 | | 345 | 490 | 2400 | 3000 | | 157 | 232 | | 2.5 | 2.5 | 9.51 |
| NU2228EM | 32528EH | 140 | 250 | 68 | 3 | 3 | 169 | | 550 | 790 | 2000 | 2600 | | 157 | 232 | | 2.5 | 2.5 | 15.9 |
| NJ2228M | 42528 | 140 | 250 | 68 | 3 | 3 | 169 | | 475 | 760 | 2000 | 2600 | | 157 | 232 | | 2.5 | 2.5 | 14.8 |
| N328M | 2328 | 140 | 300 | 62 | 4 | 4 | | 263.6 | 610 | 805 | 1900 | 2400 | 160 | | | 278 | 3 | 3 | 21.9 |
| NF328M | 12328 | 140 | 300 | 62 | 4 | 4 | | 260 | 610 | 805 | 1900 | 2400 | 160 | | | 278 | 3 | 3 | 22.8 |
| NU328EM | 32328EH | 140 | 300 | 62 | 4 | 4 | 180 | | 665 | 880 | 1800 | 2200 | | 160 | 278 | | 3 | 3 | 23.7 |
| NUP328M | 92328 | 140 | 300 | 62 | 4 | 4 | 180 | | 610 | 805 | 1800 | 2200 | | 160 | 278 | | 3 | 3 | 24.5 |
| N2328M | 2628 | 140 | 300 | 102 | 4 | 4 | | 260 | 880 | 1300 | 1800 | 2200 | 160 | | | 278 | 3 | 3 | 34.6 |
| NU2328EM | 32628 | 140 | 300 | 102 | 4 | 4 | 180 | | 1020 | 1380 | 1800 | 2200 | | 160 | 278 | | 3 | 3 | 35.8 |
| NJ2328EM | 42628 | 140 | 300 | 102 | 4 | 4 | 180 | | 1020 | 1380 | 1800 | 2200 | | 160 | 278 | | 3 | 3 | 41 |
| NJ428M | 42428 | 140 | 360 | 82 | 5 | 5 | 196 | | 896 | 998 | 1700 | 2000 | | 160 | 278 | | 4 | 4 | 46.3 |
| NU1930M | 1032930 | 150 | 210 | 28 | 2 | 1.1 | 165 | | 164 | 252 | 2600 | 3200 | | 160 | 196 | | 2 | 1 | 2.98 |
| NU2930M | 2032930 | 150 | 210 | 36 | 2 | 1.1 | 165 | | 204 | 335 | 2600 | 3200 | | 160 | 196 | | 2 | 1 | 3.83 |
| NU1030M | 32130 | 150 | 225 | 35 | 2.1 | 1.5 | 169.5 | | 202 | 294 | 2600 | 3200 | | 162 | 209 | | 2 | 1.5 | 4.94 |
| NJ1030M | 42130 | 150 | 225 | 35 | 2.1 | 1.5 | 169.5 | | 202 | 294 | 2600 | 3200 | | 162 | 209 | | 2 | 1.5 | 5.05 |
| N230M | 2230 | 150 | 270 | 45 | 3 | 3 | | 238 | 395 | 580 | 2000 | 2600 | 167 | | | 251 | 2.5 | 2.5 | 11.6 |
| NU230EM | 32230EH | 150 | 270 | 45 | 3 | 3 | 182 | | 450 | 595 | 1900 | 2400 | | 167 | 251 | | 2.5 | 2.5 | 12.5 |
| NJ230EM | 42230EH | 150 | 270 | 45 | 3 | 3 | 182 | | 450 | 595 | 1900 | 2400 | | 167 | 251 | | 2.5 | 2.5 | 12.7 |
| NUP230EM | 92230EH | 150 | 270 | 45 | 3 | 3 | 182 | | 450 | 595 | 1900 | 2400 | | 167 | 251 | | 2.5 | 2.5 | 13 |
| NU2230EM | 32530EH | 150 | 270 | 73 | 3 | 3 | 182 | | 635 | 930 | 1900 | 2400 | | 167 | 251 | | 2.5 | 2.5 | 19.9 |
| NU2230EWB | 32530K | 150 | 270 | 73/143 | 3 | 3 | 182 | | 635 | 930 | 1900 | 2400 | | 167 | 251 | | 2.5 | 2.5 | 23.3 |
| NJ2230EM | 42530EH | 150 | 270 | 73 | 3 | 3 | 182 | | 635 | 930 | 1900 | 2400 | | 167 | 251 | | 2.5 | 2.5 | 21.4 |
| RN330 | | 150 | | 65 | 4 | 4 | | 277 | 715 | 890 | 1700 | 2000 | 170 | | | | 3 | 3 | 16.1 |
| N330M | 2330 | 150 | 320 | 65 | 4 | 4 | | 280.8 | 715 | 890 | 1700 | 2000 | 170 | | | 297 | 3 | 3 | 26.5 |
| NU330EM | 32330EH | 150 | 320 | 65 | 4 | 4 | 193 | | 750 | 1020 | 1700 | 2000 | | 170 | 297 | | 3 | 3 | 26.8 |
| NJ330EM | 42330EH | 150 | 320 | 65 | 4 | 4 | 193 | | 750 | 1020 | 1700 | 2000 | | 170 | 297 | | 3 | 3 | 27.2 |
| NUP330M | 92330 | 150 | 320 | 65 | 4 | 4 | 193 | | 680 | 920 | 1700 | 2000 | | 170 | 297 | | 3 | 3 | 27.4 |
| NU330-113 | | 150 | 320 | 65/108 | 4 | 4 | 193 | | 715 | 890 | 1700 | 2000 | | 170 | 297 | | 3 | 3 | 29.6 |
| NU2330EM | 32630EH | 150 | 320 | 108 | 4 | 4 | 193 | | 1160 | 1600 | 1700 | 2000 | | 170 | 297 | | 3 | 3 | 41.5 |
| NJ2330EM | 42630EH | 150 | 320 | 108 | 4 | 4 | 193 | | 1160 | 1600 | 1700 | 2000 | | 170 | 297 | | 3 | 3 | 42.4 |
| NF2330EM | 12630EH | 150 | 320 | 108 | 4 | 4 | 193 | | 1160 | 1600 | 1700 | 2000 | | 170 | 297 | | 3 | 3 | 43.6 |
| NU3330M | 3032330 | 150 | 320 | 128 | 4 | 4 | 193 | | 1250 | 1900 | 1400 | 1800 | | 170 | 297 | | 3 | 3 | 49.9 |
| NJ3330M | 3042330 | 150 | 320 | 128 | 4 | 4 | 193 | | 1250 | 1900 | 1400 | 1800 | | 170 | 297 | | 3 | 3 | 51 |
| NU2932M | 2032932 | 160 | 220 | 36 | 2 | 2 | 173 | | 240 | 450 | 2500 | 3200 | | 170 | 206 | | 1.5 | 1.5 | 4.08 |
| NJ2932M | 2042932 | 160 | 220 | 36 | 2 | 2 | 173 | | 240 | 450 | 2500 | 3200 | | 170 | 206 | | 1.5 | 1.5 | 4.17 |
| NU1032M | 32132 | 160 | 240 | 38 | 2.1 | 2.1 | 180 | | 238 | 340 | 2400 | 3000 | | 172 | 224 | | 2 | 2 | 5.96 |
| NJ1032M | 42132 | 160 | 240 | 38 | 2.1 | 2.1 | 180 | | 238 | 340 | 2400 | 3000 | | 172 | 224 | | 2 | 2 | 6.13 |
| N232M | 2232 | 160 | 290 | 48 | 3 | 3 | | 257 | 460 | 650 | 1800 | 2200 | 177 | | | 271 | 2.5 | 2.5 | 14.3 |
| NU232EM | 32232EH | 160 | 290 | 48 | 3 | 3 | 193 | | 500 | 665 | 1800 | 2200 | | 177 | 271 | | 2.5 | 2.5 | 14.8 |
| NJ232EM | 42232EH | 160 | 290 | 48 | 3 | 3 | 195 | | 500 | 665 | 1800 | 2200 | | 177 | 271 | | 2.5 | 2.5 | 14.6 |
| NUP232EM | 92232 | 160 | 290 | 48 | 3 | 3 | 193 | | 500 | 665 | 1800 | 2200 | | 177 | 271 | | 2.5 | 2.5 | 15.5 |
| NU2232EM | 32532EH | 160 | 290 | 80 | 3 | 3 | 193 | | 810 | 1190 | 1800 | 2200 | | 177 | 271 | | 2.5 | 2.5 | 24.2 |
| N332M | 2332 | 160 | 340 | 68 | 4 | 4 | | 292 | 705 | 995 | 1500 | 1800 | 180 | | | 317 | 3 | 3 | 30.63 |
| NU332EM | 32332EH | 160 | 340 | 68 | 4 | 4 | 204 | | 860 | 1050 | 1500 | 1800 | | 180 | 317 | | 3 | 3 | 33 |
| NJ332EM | 42332EH | 160 | 340 | 68 | 4 | 4 | 204 | | 860 | 1050 | 1500 | 1800 | | 180 | 317 | | 3 | 3 | 33.6 |
| N2332M | 2632 | 160 | 340 | 114 | 4 | 4 | | 292 | 1080 | 1650 | 1500 | 1800 | 180 | | | 317 | | | 51.6 |
| NU2332EM | 32632EH | 160 | 340 | 114 | 4 | 4 | 204 | | 1310 | 1820 | 1500 | 1800 | | 180 | 317 | | 3 | 3 | 56.5 |
| NU3332M | | 160 | 340 | 136 | 4 | 4 | 208 | | 1240 | 1850 | 1500 | 1800 | | 180 | 317 | | 3 | 3 | 63 |

EVERGLORY INDUSTRY CO., LIMITED

No. 29 Industrial Park North Road Wafangdian City Liaoning China

www.evergloryindustry.com

info@evergloryindustry.com

Tel / Whatsapp: 008613130008503



| Bearing NO. | | Boundary dimensions(mm) | | | | | | | Basic load ratings(kN) | | Limiting speed(rpm) | | Abutment and fillet dimensions(mm) | | | | | | Weight(kg) |
|-------------|---------|-------------------------|-----|-----|-----------------------|-----------------------|-------|-----|------------------------|------|---------------------|------|------------------------------------|--------------------|--------------------|--------------------|--------------------|--------------------|------------|
| New | Old | d | D | B | r _{1, 2 min} | r _{3, 4 min} | Fw | Ew | Cr | Cor | Grease | Oil | d _{a min} | d _{b min} | D _{a max} | D _{b max} | r _{a max} | r _{b max} | Refer |
| NU3834M | | 170 | 215 | 34 | 1.1 | 1 | 181.5 | | 187 | 385 | 2500 | 3200 | | 179 | 204 | | 1 | 1 | 2.99 |
| NU2934M | 2032934 | 170 | 230 | 36 | 2 | 1.1 | 185 | | 211 | 360 | 2500 | 3200 | | 181 | 216 | | 2 | 1 | 4.24 |
| NU1034M | 32134 | 170 | 260 | 42 | 2.1 | 2.1 | 193 | | 287 | 415 | 2200 | 2800 | | 185 | 244 | | 2 | 2 | 8.23 |
| NJ1034M | 42134 | 170 | 260 | 42 | 2.1 | 2.1 | 193 | | 287 | 415 | 2200 | 2800 | | 185 | 244 | | 2 | 2 | 8.46 |
| NU3034M | 3032134 | 170 | 260 | 67 | 2.1 | 2.1 | 193 | | 510 | 875 | 2200 | 2800 | | 185 | 244 | | 2 | 2 | 13.4 |
| NU3134M | 3032734 | 170 | 280 | 88 | 2.1 | 2.1 | 200 | | 665 | 1080 | 2000 | 2400 | | 185 | 263 | | 2 | 2 | 22 |
| N234M | 2234 | 170 | 310 | 52 | 4 | 4 | | 272 | 520 | 780 | 1800 | 2200 | 190 | | | 288 | 3 | 3 | 18.2 |
| NU234EM | 32234EH | 170 | 310 | 52 | 4 | 4 | 208 | | 475 | 635 | 1800 | 2200 | | 190 | 288 | | 3 | 3 | 17.7 |
| NJ234EM | 42234EH | 170 | 310 | 52 | 4 | 4 | 208 | | 475 | 635 | 1800 | 2200 | | 190 | 288 | | 3 | 3 | 18.1 |
| NU2234EM | 32534EH | 170 | 310 | 86 | 4 | 4 | 205 | | 925 | 1330 | 1800 | 2200 | | 190 | 288 | | 3 | 3 | 31.5 |
| NU3234M | | 170 | 310 | 110 | 4 | 4 | 208 | | 915 | 1470 | 1800 | 2200 | | 190 | 288 | | 3 | 3 | 37.9 |
| N334M | 2334 | 170 | 360 | 72 | 4 | 4 | | 310 | 795 | 1010 | 1400 | 1700 | 190 | | | 337 | 3 | 3 | 37.3 |
| NU334M | 32334 | 170 | 360 | 72 | 4 | 4 | 220 | | 795 | 1010 | 1400 | 1700 | | 190 | 337 | | 3 | 3 | 37.7 |
| NJ334M | 42334 | 170 | 360 | 72 | 4 | 4 | 220 | | 795 | 1010 | 1400 | 1700 | | 190 | 337 | | 3 | 3 | 38.4 |
| NU2234EM | 32534EH | 170 | 360 | 86 | 4 | 4 | 205 | | 960 | 1500 | 1800 | 2200 | | 190 | 337 | | 3 | 3 | 29 |
| NU2334M | 32634 | 170 | 360 | 120 | 4 | 4 | 220 | | 1220 | 1750 | 1400 | 1700 | | 190 | 337 | | 3 | 3 | 63.7 |
| NJ2334M | 42634 | 170 | 360 | 120 | 4 | 4 | 220 | | 1220 | 1750 | 1400 | 1700 | | 190 | 337 | | 3 | 3 | 64.7 |
| NU3334M | | 170 | 360 | 140 | 4 | 4 | 220 | | 1350 | 1980 | 1400 | 1700 | | 190 | 337 | | 3 | 3 | 72.1 |
| NU3836M | | 180 | 225 | 34 | 2.1 | 2.1 | 191.5 | | 192 | 405 | 2200 | 2800 | | 189 | 214 | | 2 | 2 | 3.15 |
| NU1936M | 1032936 | 180 | 250 | 33 | 2.1 | 2.1 | 198 | | 219 | 355 | 2200 | 2800 | | 191 | 236 | | 2 | 2 | 4.92 |
| NU2936M | 2032936 | 180 | 250 | 42 | 2.1 | 2.1 | 198 | | 255 | 430 | 2200 | 2800 | | 191 | 236 | | 2 | 2 | 6.18 |
| NU1036EM | 32136EH | 180 | 280 | 46 | 2.1 | 2.1 | 205 | | 380 | 565 | 1800 | 2400 | | 195 | 263 | | 2 | 2 | 10.2 |
| NJ1036EM | 42136EH | 180 | 280 | 46 | 2.1 | 2.1 | 205 | | 380 | 565 | 1800 | 2400 | | 195 | 263 | | 2 | 2 | 10.8 |
| NU3036M | 3032136 | 180 | 280 | 74 | 2.1 | 2.1 | 206 | | 365 | 955 | 1800 | 2400 | | 195 | 263 | | 2 | 2 | 17.4 |
| NU236EM | 32236EH | 180 | 320 | 52 | 4 | 4 | 217 | | 625 | 850 | 1700 | 2000 | | 200 | 297 | | 3 | 3 | 18 |
| NJ236EM | 42236EH | 180 | 320 | 52 | 4 | 4 | 217 | | 625 | 850 | 1700 | 2000 | | 200 | 297 | | 3 | 3 | 18.6 |
| NUP236EM | 92236EH | 180 | 320 | 52 | 4 | 4 | 217 | | 625 | 850 | 1700 | 2000 | | 200 | 297 | | 3 | 3 | 21.4 |
| NU2236EM | 32536EH | 180 | 320 | 86 | 4 | 4 | 215 | | 1010 | 1510 | 1700 | 2000 | | 200 | 297 | | 3 | 3 | 30.3 |
| NJ2236EM | 42536EH | 180 | 320 | 86 | 4 | 4 | 215 | | 1010 | 1510 | 1700 | 2000 | | 200 | 297 | | 3 | 3 | 31 |
| NUP2236M | 92536 | 180 | 320 | 86 | 4 | 4 | 215 | | 960 | 1580 | 1700 | 2000 | | 200 | 297 | | 3 | 3 | 32.1 |
| NU3236M | 3032236 | 180 | 320 | 112 | 4 | 4 | 218 | | 950 | 1560 | 1700 | 2000 | | 200 | 297 | | 3 | 3 | 39.6 |
| N336M | 2336 | 180 | 380 | 75 | 4 | 4 | | 330 | 910 | 1150 | 1500 | 1800 | 200 | | | 356 | 3 | 3 | 39.6 |
| NU336M | 32336 | 180 | 380 | 75 | 4 | 4 | 230 | | 910 | 1150 | 1500 | 1800 | | 200 | 356 | | 3 | 3 | 43.5 |
| NU2336M | 32636 | 180 | 380 | 126 | 4 | 4 | 232 | | 1380 | 1990 | 1300 | 1600 | | 200 | 356 | | 3 | 3 | 68.9 |
| NJ2336M | 42636 | 180 | 380 | 126 | 4 | 4 | 232 | | 1380 | 1990 | 1300 | 1600 | | 200 | 356 | | 3 | 3 | 69.5 |
| NU3336M | | 180 | 380 | 150 | 4 | 4 | 232 | | 1600 | 2410 | 1300 | 1600 | | 200 | 356 | | 3 | 3 | 86.4 |
| NU2838M | 2032838 | 190 | 240 | 30 | 2.1 | 2.1 | 203 | | 180 | 355 | 2200 | 2800 | | 202 | 227 | | 2 | 2 | 3.22 |
| NU2938M | 2032938 | 190 | 260 | 42 | 2.1 | 2.1 | 208 | | 260 | 450 | 2200 | 2800 | | 201 | 245 | | 2 | 2 | 6.42 |
| NU1038M | 32138 | 190 | 290 | 46 | 2.1 | 2.1 | 215 | | 365 | 535 | 2000 | 2600 | | 206 | 273 | | 2 | 2 | 10.7 |
| NU3038M | 3032138 | 190 | 290 | 75 | 2.1 | 2.1 | 219 | | 565 | 1010 | 1800 | 2200 | | 206 | 273 | | 2 | 2 | 18.3 |
| NU238EM | 32238EH | 190 | 340 | 55 | 4 | 4 | 230 | | 695 | 955 | 1600 | 1900 | | 211 | 317 | | 3 | 3 | 21.6 |
| NJ238EM | 42238EH | 190 | 340 | 55 | 4 | 4 | 230 | | 695 | 955 | 1600 | 1900 | | 211 | 317 | | 3 | 3 | 22 |
| NUP238EM | 92238EH | 190 | 340 | 55 | 4 | 4 | 230 | | 695 | 955 | 1600 | 1900 | | 211 | 317 | | 3 | 3 | 22.3 |
| NU2238EM | 32538EH | 190 | 340 | 92 | 4 | 4 | 228 | | 1100 | 1670 | 1600 | 1900 | | 211 | 317 | | 3 | 3 | 39.5 |
| NU3238M | 3032238 | 190 | 340 | 120 | 4 | 4 | 231 | | 1070 | 1780 | 1400 | 1600 | | 211 | 317 | | 3 | 3 | 49.3 |
| N338M | 2338 | 190 | 400 | 78 | 5 | 5 | | 345 | 975 | 1260 | 1200 | 1500 | 215 | | | 372 | 4 | 4 | 48.5 |
| NU338M | 32338 | 190 | 400 | 78 | 5 | 5 | 245 | | 975 | 1260 | 1200 | 1500 | | 215 | 372 | | 4 | 4 | 50.2 |
| NJ338M | 42338 | 190 | 400 | 78 | 5 | 5 | 245 | | 975 | 1260 | 1200 | 1500 | | 215 | 372 | | 4 | 4 | 49.4 |
| NU2338M | 32638 | 190 | 400 | 132 | 5 | 5 | 245 | | 1520 | 2220 | 1200 | 1500 | | 215 | 372 | | 4 | 4 | 84.9 |
| NU3338M | | 190 | 400 | 155 | 5 | 5 | 245 | | 1730 | 2630 | 1200 | 1500 | | 215 | 372 | | 4 | 4 | 99.2 |

EVERGLORY INDUSTRY CO., LIMITED

No. 29 Industrial Park North Road Wafangdian City Liaoning China

www.evergloryindustry.com

info@evergloryindustry.com

Tel / Whatsapp: 008613130008503



| Bearing NO. | | Boundary dimensions(mm) | | | | | | | Basic load ratings(kN) | | Limiting speed(rpm) | | Abutment and fillet dimensions(mm) | | | | | | Weight(kg) |
|-------------|-----------|-------------------------|-----|-----|----------------------|----------------------|-----|-----|------------------------|------|---------------------|------|------------------------------------|--------------------|--------------------|--------------------|--------------------|--------------------|------------|
| New | Old | d | D | B | r _{1, 2min} | r _{3, 4min} | Fw | Ew | Cr | Cor | Grease | Oil | d _{a min} | d _{b min} | D _{a max} | D _{b max} | r _{a max} | r _{b max} | Refer |
| NU1940M | 1032940 | 200 | 280 | 38 | 2.1 | 2.1 | 220 | | 268 | 425 | 2200 | 2800 | | 216 | 263 | | 2 | 2 | 7.22 |
| NU2940M | 2032940 | 200 | 280 | 48 | 2.1 | 2.1 | 220 | | 365 | 630 | 2200 | 2800 | | 213 | 263 | | 2 | 2 | 9.24 |
| NJ2940M | 2042940 | 200 | 280 | 48 | 2.1 | 2.1 | 222 | | 365 | 630 | 2200 | 2800 | | 213 | 263 | | 2 | 2 | 9.7 |
| NU1040M | 32140 | 200 | 310 | 51 | 2.1 | 2.1 | 227 | | 450 | 720 | 1900 | 2400 | | 216 | 293 | | 2 | 2 | 14.3 |
| NJ1040EM | 42140EH | 200 | 310 | 51 | 2.1 | 2.1 | 227 | | 450 | 720 | 1900 | 2400 | | 216 | 293 | | 2 | 2 | 14.7 |
| NU3140M | 3032140 | 200 | 340 | 112 | 3 | 3 | 233 | | 1190 | 1850 | 1900 | 2400 | | 218 | 320 | | 2.5 | 2.5 | 41.4 |
| N240M | 2240 | 200 | 360 | 58 | 4 | 4 | | 316 | 675 | 995 | 1500 | 1800 | 221 | | | 337 | 3 | 3 | 26.7 |
| NU240EM | 32240EH | 200 | 360 | 58 | 4 | 4 | 243 | | 765 | 1060 | 1500 | 1800 | | 221 | 337 | | 3 | 3 | 26.8 |
| NJ240EM | 42240EH | 200 | 360 | 58 | 4 | 4 | 244 | | 765 | 1060 | 1500 | 1800 | | 221 | 337 | | 3 | 3 | 27.1 |
| NUP240EM | 92240EH | 200 | 360 | 58 | 4 | 4 | 244 | | 765 | 1060 | 1500 | 1800 | | 221 | 337 | | 3 | 3 | 28.2 |
| N2240EM | 2540EH | 200 | 360 | 98 | 4 | 4 | | 325 | 1220 | 1870 | 1500 | 1800 | 221 | | | 337 | 3 | 3 | 44.9 |
| NU2240EM | 32540EH | 200 | 360 | 98 | 4 | 4 | 241 | | 1220 | 1870 | 1500 | 1800 | | 221 | 337 | | 3 | 3 | 45.1 |
| NJ2240M | 42540 | 200 | 360 | 98 | 4 | 4 | 244 | | 960 | 1600 | 1500 | 1800 | | 221 | 337 | | 3 | 3 | 45.5 |
| NU3240M | 3032240 | 200 | 360 | 128 | 4 | 4 | 244 | | 1100 | 1810 | 1500 | 1800 | | 221 | 337 | | 3 | 3 | 58 |
| NU340M | 32340 | 200 | 420 | 80 | 5 | 5 | 260 | | 975 | 1270 | 1500 | 1800 | | 225 | 392 | | 4 | 4 | 56.8 |
| N2340M | 2640 | 200 | 420 | 138 | 5 | 5 | | 364 | 1620 | 2640 | 1200 | 1500 | 225 | | | 392 | 4 | 4 | 94.5 |
| NU2340M | 32640 | 200 | 420 | 138 | 5 | 5 | 260 | | 1510 | 2240 | 1200 | 1500 | | 225 | 392 | | 4 | 4 | 96.8 |
| NU3340M | 3032340 | 200 | 420 | 165 | 5 | 5 | 260 | | 1730 | 2660 | 1200 | 1500 | | 225 | 392 | | 4 | 4 | 115 |
| NU1944M | 1032944 | 220 | 300 | 38 | 2.1 | 1.5 | 240 | 280 | 295 | 495 | 1900 | 2400 | 236 | 233 | 283 | 286 | 2 | 1.5 | 7.88 |
| NU2944M | 2032944 | 220 | 300 | 48 | 2.1 | 1.5 | 240 | 280 | 370 | 660 | 1900 | 2400 | 236 | 233 | 283 | 286 | 2 | 1.5 | 9.93 |
| NU1044M | 32144 | 220 | 340 | 56 | 3 | 3 | 250 | | 500 | 750 | 1800 | 2200 | | 238 | 320 | | 2.5 | 2.5 | 18.2 |
| NJ1044M | 42144 | 220 | 340 | 56 | 3 | 3 | 250 | | 500 | 750 | 1800 | 2200 | | 238 | 320 | | 2.5 | 2.5 | 19.6 |
| N244M | 2244 | 220 | 400 | 65 | 4 | 4 | | 350 | 760 | 1200 | 1500 | 1800 | 241 | | | 376 | 3 | 3 | 36.7 |
| NU244M | 32244 | 220 | 400 | 65 | 4 | 4 | 270 | | 760 | 1200 | 1500 | 1800 | | 241 | 376 | | 3 | 3 | 34.7 |
| NJ244M | 42244 | 220 | 400 | 65 | 4 | 4 | 270 | | 760 | 1200 | 1500 | 1800 | | 241 | 376 | | 3 | 3 | 35.4 |
| NU2244M | 32544 | 220 | 400 | 108 | 4 | 4 | 270 | | 1140 | 1810 | 1300 | 1600 | | 241 | 376 | | 3 | 3 | 61.8 |
| NJ2244M | 42544 | 220 | 400 | 108 | 4 | 4 | 270 | | 1140 | 1810 | 1300 | 1600 | | 241 | 376 | | 3 | 3 | 63 |
| N2344EM | 2644EH | 220 | 460 | 145 | 5 | 5 | | 407 | 1780 | 2620 | 1000 | 1300 | 245 | | | 431 | 4 | 4 | 114 |
| NU2344EM | 32644EH | 220 | 460 | 145 | 5 | 5 | 284 | | 1780 | 2620 | 1000 | 1300 | | 245 | 431 | | 4 | 4 | 120 |
| NU3344M/HC | | 220 | 460 | 180 | | | 284 | | 2130 | 3300 | 800 | 1100 | | 245 | 431 | | 4 | 4 | 140.6 |
| NU1948M | 1032948 | 240 | 320 | 38 | 2.1 | 2.1 | 260 | | 315 | 550 | 2000 | 2400 | | 253 | 302 | | 2 | 2 | 8.68 |
| NU2948M | 2032948 | 240 | 320 | 48 | 2.1 | 2.1 | 260 | | 385 | 710 | 2000 | 2400 | | 253 | 302 | | 2 | 2 | 10.7 |
| NU1048M | 32148 | 240 | 360 | 56 | 3 | 3 | 270 | | 530 | 820 | 1700 | 2000 | | 259 | 340 | | 2.5 | 2.5 | 21.2 |
| NU248M | 32248 | 240 | 440 | 72 | 4 | 4 | 295 | | 985 | 1540 | 1300 | 1600 | | 262 | 415 | | 3 | 3 | 46.9 |
| NJ248M | 42248 | 240 | 440 | 72 | 4 | 4 | 295 | | 935 | 1340 | 1300 | 1600 | | 262 | 415 | | 3 | 3 | 51 |
| NUP248M | 92248 | 240 | 440 | 72 | 4 | 4 | 295 | | 935 | 1340 | 1300 | 1600 | | 262 | 415 | | 3 | 3 | 51.4 |
| NU2248M | 32548 | 240 | 440 | 120 | 4 | 4 | 295 | | 1440 | 2320 | 1000 | 1300 | | 262 | 415 | | 3 | 3 | 84.9 |
| NJ2248M | 42548 | 240 | 440 | 120 | 4 | 4 | 295 | | 1440 | 2320 | 1000 | 1300 | | 262 | 415 | | 3 | 3 | 86.7 |
| N348M | 2348 | 240 | 500 | 95 | 5 | 5 | | 430 | 1400 | 2200 | 1000 | 1300 | 266 | | | 470 | 4 | 4 | 94.6 |
| NU348M | 32348 | 240 | 500 | 95 | 5 | 5 | 310 | | 1400 | 2200 | 1000 | 1300 | | 266 | 470 | | 4 | 4 | 96.3 |
| NU2348M | 32648 | 240 | 500 | 155 | 5 | 5 | 310 | | 2000 | 2990 | 1000 | 1300 | | 266 | 470 | | 4 | 4 | 152 |
| NU1952M | 1032952 | 260 | 360 | 46 | 2.1 | 2.1 | 286 | | 435 | 760 | 1900 | 2200 | | 277 | 342 | | 2 | 2 | 14.4 |
| NU2952M | 2032952 | 260 | 360 | 60 | 2.1 | 2.1 | 286 | | 535 | 995 | 1900 | 2200 | | 277 | 342 | | 2 | 2 | 18.6 |
| NU1052M | 32152 | 260 | 400 | 65 | 4 | 4 | 296 | | 645 | 1000 | 1500 | 1800 | | 282 | 376 | | 3 | 3 | 29.1 |
| NUP1052M | 92152 | 260 | 400 | 65 | 4 | 4 | 296 | | 645 | 1000 | 1500 | 1800 | | 282 | 376 | | 3 | 3 | 37.2 |
| NU252M | 32252 | 260 | 480 | 80 | 5 | 5 | 320 | | 985 | 1800 | 1100 | 1400 | | 286 | 450 | | 4 | 4 | 67.2 |
| NU2052EM | 2032152EH | 260 | 480 | 82 | 5 | 5 | 294 | | 1100 | 1800 | 1100 | 1400 | | 283 | 450 | | 4 | 4 | 40.5 |
| NU2252M | 32552 | 260 | 480 | 130 | 5 | 5 | 320 | | 1710 | 2770 | 900 | 1200 | | 286 | 450 | | 4 | 4 | 111 |
| NU352M | 32352 | 260 | 540 | 102 | 6 | 6 | 336 | | 1540 | 2090 | 900 | 1200 | | 292 | 503 | | 5 | 5 | 118 |
| NU2352M | 32652 | 260 | 540 | 165 | 6 | 6 | 336 | | 2230 | 3350 | 900 | 1200 | | 292 | 503 | | 5 | 5 | 190 |

EVERGLORY INDUSTRY CO., LIMITED

No. 29 Industrial Park North Road Wafangdian City Liaoning China

www.evergloryindustry.com

info@evergloryindustry.com

Tel / Whatsapp: 008613130008503



| Bearing NO. | | Boundary dimensions(mm) | | | | | | | Basic load ratings(kN) | | Limiting speed(rpm) | | Abutment and fillet dimensions(mm) | | | | | | Weight(kg) |
|-------------|----------|-------------------------|-----|-----|----------------------|----------------------|-----|-----|------------------------|------|---------------------|------|------------------------------------|--------------------|--------------------|--------------------|--------------------|--------------------|------------|
| New | Old | d | D | B | r _{1, 2min} | r _{3, 4min} | Fw | Ew | Cr | Cor | Grease | Oil | d _{a min} | d _{b min} | D _{a max} | D _{b max} | r _{a max} | r _{b max} | Refer |
| NU2856M | | 280 | 350 | 42 | 2 | 2 | 299 | | 325 | 705 | 1800 | 2200 | | 295 | 334 | | 2 | 2 | 9.16 |
| NU3856M | | 280 | 350 | 52 | 2 | 1.1 | 298 | | 435 | 985 | 1700 | 2000 | | 293 | 334 | | 2 | 1 | 11.6 |
| NU1956M | 1032956 | 280 | 380 | 46 | 2.1 | 2.1 | 306 | | 450 | 815 | 1800 | 2200 | | 297 | 361 | | 2 | 2 | 15.2 |
| NU2956M | 2032956 | 280 | 380 | 60 | 2.1 | 2.1 | 307 | | 575 | 1150 | 1500 | 1800 | | 297 | 361 | | 2 | 2 | 20.2 |
| NU1056M | 32156 | 280 | 420 | 65 | 4 | 4 | 316 | | 660 | 1050 | 1400 | 1700 | | 302 | 395 | | 3 | 3 | 30.8 |
| NJ1056M | 42156 | 280 | 420 | 65 | 4 | 4 | 316 | | 660 | 1050 | 1400 | 1700 | | 302 | 395 | | 3 | 3 | 32.2 |
| NU256M | 32256 | 280 | 500 | 80 | 5 | 5 | 340 | | 1140 | 1680 | 1000 | 1300 | | 306 | 470 | | 4 | 4 | 70.7 |
| NU2256M | 32556 | 280 | 500 | 130 | 5 | 5 | 340 | | 1770 | 2950 | 900 | 1200 | | 306 | 470 | | 4 | 4 | 117 |
| NU2356M | 32656 | 280 | 580 | 175 | 6 | 6 | 362 | | 2570 | 3950 | 900 | 1200 | | 313 | 542 | | 5 | 5 | 236 |
| NU1960M | 1032960 | 300 | 420 | 56 | 3 | 3 | 332 | | 555 | 975 | 1600 | 2000 | | 320 | 398 | | 2.5 | 2.5 | 24.4 |
| NU2960M | 2032960 | 300 | 420 | 72 | 3 | 3 | 332 | | 725 | 1370 | 1400 | 1700 | | 320 | 398 | | 2.5 | 2.5 | 30.3 |
| NU1060M | 32160 | 300 | 460 | 74 | 4 | 4 | 340 | | 885 | 1400 | 1200 | 1500 | | 323 | 435 | | 3 | 3 | 44.9 |
| NJ1060M | 42160 | 300 | 460 | 74 | 4 | 4 | 340 | | 885 | 1400 | 1200 | 1500 | | 323 | 435 | | 3 | 3 | 46.3 |
| NU260M | 32260 | 300 | 540 | 85 | 5 | 5 | 364 | | 1400 | 2070 | 1000 | 1300 | | 327 | 509 | | 4 | 4 | 86.9 |
| NUP260M | 92260 | 300 | 540 | 85 | 5 | 5 | 364 | | 1400 | 2070 | 1000 | 1300 | | 327 | 509 | | 4 | 4 | 90 |
| NU2260M | 32560 | 300 | 540 | 140 | 5 | 5 | 365 | | 1960 | 3200 | 900 | 1100 | | 327 | 509 | | 4 | 4 | 145 |
| NU360M | 32360 | 300 | 620 | 109 | 7.5 | 7.5 | 385 | | 2200 | 3350 | 900 | 1100 | | 357 | 590 | | 7 | 7 | 166 |
| NU1964M | 1032964 | 320 | 440 | 56 | 3 | 3 | 352 | | 580 | 1050 | 1100 | 1400 | | 340 | 418 | | 2.5 | 2.5 | 25.7 |
| NU2964M | 2032964 | 320 | 440 | 72 | 3 | 3 | 352 | | 755 | 1470 | 1100 | 1400 | | 340 | 418 | | 2.5 | 2.5 | 33.5 |
| NU1064M | 32164 | 320 | 480 | 74 | 4 | 4 | 360 | | 905 | 1470 | 1100 | 1400 | | 343 | 454 | | 3 | 3 | 47.8 |
| NJ1064M | 42164 | 320 | 480 | 74 | 4 | 4 | 360 | | 905 | 1470 | 1100 | 1400 | | 343 | 454 | | 3 | 3 | 47.8 |
| NUP1064M | 92164 | 320 | 480 | 74 | 4 | 4 | 360 | | 905 | 1470 | 1100 | 1400 | | 343 | 454 | | 3 | 3 | 49.1 |
| NU3164M | 3032764 | 320 | 540 | 176 | 5 | 5 | 374 | | 2740 | 4700 | 800 | 1200 | | 347 | 509 | | 4 | 4 | 170 |
| NU264M | 32264 | 320 | 580 | 92 | 5 | 5 | 390 | | 1540 | 2270 | 900 | 1200 | | 347 | 548 | | 4 | 4 | 112 |
| NU2264M | 32564 | 320 | 580 | 150 | 5 | 5 | 390 | | 2260 | 3700 | 900 | 1200 | | 347 | 548 | | 4 | 4 | 181 |
| NU2868M | | 340 | 420 | 48 | 2.1 | 1.5 | 362 | | 435 | 1010 | 1200 | 1500 | | 355 | 400 | | 2 | 1.5 | 14.9 |
| NU3868M | | 340 | 420 | 60 | 2.1 | 2.1 | 362 | | 515 | 1250 | 1200 | 1500 | | 359 | 400 | | 2 | 2 | 18.6 |
| NU1968M | 1032968 | 340 | 460 | 56 | 3 | 3 | 372 | | 600 | 1120 | 1100 | 1400 | | 361 | 438 | | 2.5 | 2.5 | 27.1 |
| NU2968M | 2032968 | 340 | 460 | 72 | 3 | 3 | 370 | | 780 | 1570 | 1100 | 1400 | | 361 | 438 | | 2.5 | 2.5 | 33.7 |
| NU1068M | 32168 | 340 | 520 | 82 | 5 | 5 | 385 | | 1080 | 1740 | 1000 | 1300 | | 368 | 490 | | 4 | 4 | 61.8 |
| NU3168M | 3032768 | 340 | 580 | 190 | 5 | 5 | 399 | | 3500 | 6250 | 700 | 1000 | | 368 | 548 | | 4 | 4 | 214 |
| NU268M | 32268 | 340 | 620 | 92 | 6 | 6 | 420 | | 1590 | 2410 | 900 | 1200 | | 374 | 582 | | 5 | 5 | 128 |
| NU1972M | 1032972 | 360 | 480 | 56 | 3 | 3 | 392 | | 605 | 1160 | 1200 | 1500 | | 381 | 457 | | 2.5 | 2.5 | 28.8 |
| NU2972M | 2032972 | 360 | 480 | 72 | 3 | 3 | 392 | | 790 | 1630 | 1000 | 1300 | | 381 | 457 | | 2.5 | 2.5 | 36.7 |
| NU1072M | 32172 | 360 | 540 | 82 | 5 | 5 | 405 | | 1110 | 1830 | 900 | 1100 | | 388 | 509 | | 4 | 4 | 64.1 |
| NU272M | 32272 | 360 | 650 | 95 | 6 | 6 | 445 | | 1650 | 2560 | 900 | 1100 | | 394 | 611 | | 5 | 5 | 144 |
| NU2272M | 32572 | 360 | 650 | 170 | 6 | 6 | 435 | | 3500 | 6050 | 800 | 100 | | 394 | 611 | | 5 | 5 | 258 |
| NU2372M | 32672 | 360 | 750 | 224 | 7.5 | 7.5 | 455 | | 4950 | 8700 | 700 | 850 | | 420 | 690 | | 7 | 7 | 480 |
| NUP2876Q1 | 2092876Q | 380 | 480 | 60 | 2.1 | 2.1 | 406 | | 550 | 680 | 950 | 1200 | | 396 | 460 | | 2 | 2 | 27 |
| NU1976M | 1032976 | 380 | 520 | 65 | 4 | 4 | 418 | | 775 | 1470 | 950 | 1200 | | 404 | 493 | | 3 | 3 | 41.2 |
| NU1076M | 32176 | 380 | 560 | 82 | 5 | 5 | 425 | | 1140 | 1910 | 950 | 1200 | | 408 | 529 | | 4 | 4 | 67.5 |
| NU3076M | 3032176 | 380 | 560 | 135 | 5 | 5 | 433 | | 1740 | 3600 | 850 | 1000 | | 408 | 529 | | 4 | 4 | 117 |
| NU3176M | 3032776 | 380 | 620 | 194 | 5 | 5 | 440 | | 3350 | 6400 | 850 | 1000 | | 408 | 588 | | 4 | 4 | 238 |
| NU276M | 32276 | 380 | 680 | 95 | 6 | 6 | 470 | | 1700 | 2700 | 850 | 1000 | | 415 | 640 | | 5 | 5 | 158 |
| NU2276M | 32576 | 380 | 680 | 175 | 6 | 6 | 460 | | 3100 | 5250 | 750 | 900 | | 415 | 640 | | 5 | 5 | 290 |
| NU3880M | | 400 | 500 | 75 | 2.1 | 2.1 | 427 | | 785 | 1900 | 1000 | 1200 | | 420 | 479 | | 2 | 2 | 34.2 |
| NU1980M | 1032980 | 400 | 540 | 65 | 4 | 4 | 438 | 502 | 785 | 1520 | 1000 | 1200 | | 425 | 513 | | 3 | 3 | 43 |
| NU2980M | 2032980 | 400 | 540 | 82 | 4 | 4 | 438 | 502 | 1060 | 2250 | 900 | 1100 | | 425 | 513 | | 3 | 3 | 54.9 |
| NU1080M | 32180 | 400 | 600 | 90 | 5 | 5 | 450 | 550 | 1360 | 2280 | 900 | 1100 | | 429 | 568 | | 4 | 4 | 88.2 |
| NJ1080M | 42180 | 400 | 600 | 90 | 5 | 5 | 450 | 550 | 1360 | 2280 | 900 | 1100 | | 429 | 568 | | 4 | 4 | 90.6 |



EVERGLORY INDUSTRY CO., LIMITED

No. 29 Industrial Park North Road Wafangdian City Liaoning China

www.evergloryindustry.com

info@evergloryindustry.com

Tel / Whatsapp: 008613130008503

| Bearing NO. | | Boundary dimensions(mm) | | | | | | Basic load ratings(kN) | | Limiting speed(rpm) | | Abutment and fillet dimensions(mm) | | | | | | Weight(kg) | | |
|-------------|-----------|-------------------------|------|-----|----------------------|----------------------|-------|------------------------|------|---------------------|--------|------------------------------------|--------------------|--------------------|--------------------|--------------------|--------------------|--------------------|-------|------|
| New | Old | d | D | B | r _{1, 2min} | r _{3, 4min} | Fw | Ew | Cr | Cor | Grease | Oil | d _{a min} | d _{b min} | D _{a max} | D _{b max} | r _{a max} | r _{b max} | Refer | |
| NU2280 | 32580 | 400 | 720 | 185 | 6 | 6 | 485 | | 4300 | 7800 | 800 | 950 | | | 435 | 680 | | 5 | 5 | 344 |
| NU3884M | | 420 | 520 | 75 | 2.1 | 2.1 | 447 | | 800 | 1990 | 900 | 1100 | | | 440 | 498 | | 2 | 2 | 35.4 |
| NU1984M | 1032984 | 420 | 560 | 65 | 4 | 4 | 458 | | 830 | 1660 | 900 | 1100 | | | 445 | 533 | | 3 | 3 | 45 |
| NJ1984M | 1042984 | 420 | 560 | 65 | 4 | 4 | 458 | | 830 | 1660 | 900 | 1100 | | | 445 | 533 | | 3 | 3 | 47.4 |
| NU2984M | 2032984 | 420 | 560 | 82 | 4 | 4 | 458 | 522 | 1080 | 2320 | 900 | 1100 | | | 445 | 533 | | 3 | 3 | 58.2 |
| NU1084 | 32184 | 420 | 620 | 90 | 5 | 5 | 470 | 570 | 1390 | 2380 | 900 | 1100 | | | 449 | 588 | | 4 | 4 | 91.7 |
| NU3084 | 3032184 | 420 | 620 | 150 | 5 | 5 | 478 | 568 | 2190 | 4600 | 750 | 900 | | | 449 | 588 | | 4 | 4 | 158 |
| NU2284 | 32584 | 420 | 760 | 195 | 7.5 | 7.5 | 515 | | 4400 | 8200 | 750 | 900 | | | 462 | 713 | | 6 | 6 | 406 |
| NU2988 | 2032988 | 440 | 600 | 95 | 4 | 4 | 484 | | 1300 | 2760 | 900 | 1100 | | | 466 | 572 | | 3 | 3 | 79.9 |
| NU1088 | 32188 | 440 | 650 | 94 | 6 | 6 | 493 | | 1470 | 2530 | 850 | 1000 | | | 476 | 611 | | 5 | 5 | 105 |
| NU3188 | 3032788 | 440 | 720 | 226 | 6 | 6 | 508 | | 4750 | 9800 | 700 | 850 | | | 480 | 700 | | 5 | 5 | 374 |
| NU2288 | 32588 | 440 | 790 | 200 | 7.5 | 7.5 | 530 | | 4850 | 8650 | 700 | 850 | | | 482 | 742 | | 6 | 6 | 446 |
| NU1992 | 1032992 | 460 | 620 | 74 | 4 | 4 | 500 | | 1170 | 2260 | 800 | 950 | | | 486 | 591 | | 3 | 3 | 63.2 |
| NU2992 | 2032992 | 460 | 620 | 95 | 4 | 4 | 502 | | 1650 | 2930 | 800 | 950 | | | 486 | 591 | | 3 | 3 | 83.1 |
| NUP2992 | 2092992 | 460 | 620 | 95 | 4 | 4 | 502 | | 1650 | 2930 | 800 | 950 | | | 486 | 591 | | 3 | 3 | 85 |
| NU1092 | 32192 | 460 | 680 | 100 | 6 | 6 | 516 | | 1580 | 2740 | 800 | 950 | | | 496 | 640 | | 5 | 5 | 123 |
| NU3092 | 3032192 | 460 | 680 | 163 | 6 | 6 | 523 | | 2570 | 5400 | 600 | 750 | | | 496 | 640 | | 5 | 5 | 207 |
| NU3192 | 3032792 | 460 | 760 | 240 | 7.5 | 7.5 | 531 | | 4950 | 10400 | 400 | 480 | | | 506 | 730 | | 6 | 6 | 467 |
| NU2292 | 32592 | 460 | 830 | 212 | 7.5 | 7.5 | 560 | | 4500 | 7900 | 400 | 480 | | | 502 | 782 | | 6 | 6 | 521 |
| NU1996 | 1032996 | 480 | 650 | 78 | 5 | 5 | 525 | | 1200 | 2390 | 400 | 480 | | | 510 | 617 | | 4 | 4 | 75 |
| NU2996 | 2032996 | 480 | 650 | 100 | 5 | 5 | 525 | | 1600 | 3450 | 400 | 480 | | | 510 | 617 | | 4 | 4 | 98.5 |
| NU1096 | 32196 | 480 | 700 | 100 | 6 | 6 | 536 | | 1620 | 2860 | 400 | 480 | | | 517 | 660 | | 5 | 5 | 125 |
| NU3096 | 3032196 | 480 | 700 | 165 | 6 | 6 | 543 | | 2620 | 5600 | 400 | 480 | | | 517 | 660 | | 5 | 5 | 217 |
| NU19/500 | 10329/500 | 500 | 670 | 78 | 5 | 5 | 544 | | 1190 | 2120 | 750 | 900 | | | 529 | 648 | | 4 | 4 | 79 |
| NU29/500 | 20329/500 | 500 | 670 | 100 | 5 | 5 | 543 | | 1870 | 4300 | 750 | 900 | | | 529 | 648 | | 4 | 4 | 101 |
| N39/500E | 30029/500 | 500 | 670 | 128 | 5 | 5 | 543 | | 2060 | 4960 | 700 | 850 | | | 529 | 648 | | 4 | 4 | 135 |
| NU10/500 | 321/500 | 500 | 720 | 100 | 6 | 6 | 556 | | 1660 | 2970 | 670 | 800 | | | 537 | 680 | | 5 | 5 | 131 |
| NU20/500 | 20321/500 | 500 | 720 | 128 | 6 | 6 | 553 | | 2720 | 5600 | 630 | 750 | | | 537 | 680 | | 5 | 5 | 180 |
| NU30/500 | 30321/500 | 500 | 720 | 167 | 6 | 6 | 554 | | 3500 | 7650 | 600 | 700 | | | 537 | 680 | | 5 | 5 | 232 |
| NU31/500E | 30327/500 | 500 | 830 | 264 | 7.5 | 7.5 | 576 | | 6200 | 1100 | 500 | 600 | | | 537 | 680 | | 5 | 5 | 595 |
| NU12/500 | | 500 | 920 | 185 | 7.5 | 7.5 | 604 | | 5180 | 8450 | 560 | 670 | | | 533 | 887 | | 6 | 6 | 585 |
| NF28/530 | 20128/530 | 530 | 650 | 72 | 3 | 3 | | 622 | 1160 | 2800 | 750 | 900 | | | 544 | 636 | | 2.5 | 2.5 | 52.2 |
| NJ28/530 | 20428/530 | 530 | 650 | 72 | 3 | 3 | 560.5 | | 1170 | 2750 | 750 | 900 | | | 544 | 636 | | 2.5 | 2.5 | 52 |
| NU19/530 | 10329/530 | 530 | 710 | 82 | 5 | 5 | 575 | | 1460 | 2910 | 750 | 900 | | | 566 | 690 | | 4 | 4 | 92 |
| NU29/530 | 20329/530 | 530 | 710 | 106 | 5 | 5 | 573 | | 2180 | 4600 | 750 | 900 | | | 566 | 690 | | 4 | 4 | 119 |
| NUP29/530 | 20929/530 | 530 | 710 | 106 | 5 | 5 | 573 | | 2180 | 4600 | 700 | 850 | | | 566 | 690 | | 4 | 4 | 125 |
| NU10/530 | 321/530 | 530 | 780 | 112 | 6 | 6 | 593 | | 2200 | 4050 | 670 | 800 | | | 570 | 754 | | 5 | 5 | 190 |
| NU20/530 | 20321/530 | 530 | 780 | 145 | 6 | 6 | 591 | | 3500 | 7100 | 560 | 670 | | | 570 | 754 | | 5 | 5 | 255 |
| N30/530 | 30021/530 | 530 | 780 | 185 | 6 | 6 | | 724 | 4000 | 8200 | 560 | 670 | 587 | | | | 754 | 5 | 5 | 310 |
| N31/530 | 30027/530 | 530 | 870 | 272 | 7.5 | 7.5 | | 801 | 6500 | 11200 | 480 | 560 | 611 | | | | 834 | 6 | 6 | 680 |
| NU32/530 | 30322/530 | 530 | 980 | 355 | 9.5 | 9.5 | 645 | | 9150 | 17400 | 420 | 520 | | | 582 | 921 | | 8 | 8 | 1230 |
| NJ18/560 | 10428/560 | 560 | 680 | 56 | 3 | 3 | 591 | | 780 | 1750 | 700 | 850 | | | 584 | 647 | | 2.5 | 2.5 | 44.5 |
| NU28/560 | 20328/560 | 560 | 680 | 72 | 3 | 3 | 594 | | 985 | 2610 | 700 | 850 | | | 585 | 653 | | 2.5 | 2.5 | 55.6 |
| NU19/560 | 10329/560 | 560 | 750 | 85 | 5 | 5 | 608 | | 1510 | 3100 | 670 | 800 | | | 592 | 715 | | 4 | 4 | 110 |
| NU10/560 | 321/560 | 560 | 820 | 115 | 6 | 6 | 625 | | 2120 | 3980 | 630 | 750 | | | 586 | 794 | | 5 | 5 | 210 |
| NJ10/560 | 421/560 | 560 | 820 | 115 | 6 | 6 | 625 | | 2120 | 3980 | 630 | 750 | | | 586 | 794 | | 5 | 5 | 210 |
| NU20/560 | 20321/560 | 560 | 820 | 150 | 6 | 6 | 626 | | 3650 | 6890 | 530 | 630 | | | 586 | 794 | | 5 | 5 | 290 |
| NU12/560 | 10322/560 | 560 | 1030 | 206 | 9.5 | 9.5 | 668 | | 6970 | 10200 | 480 | 560 | | | 600 | 990 | | 8 | 8 | 805 |
| NU18/600 | 10328/600 | 600 | 730 | 60 | 3 | 3 | 632 | | 865 | 1990 | 670 | 800 | | | 625 | 716 | | 2.5 | 2.5 | 50.5 |

EVERGLORY INDUSTRY CO., LIMITED

No. 29 Industrial Park North Road Wafangdian City Liaoning China

www.evergloryindustry.com

info@evergloryindustry.com

Tel / Whatsapp: 008613130008503



| Bearing NO. | | Boundary dimensions(mm) | | | | | | | Basic load ratings(kN) | | Limiting speed(rpm) | | Abutment and fillet dimensions(mm) | | | | | | Weight(kg) |
|-------------|-----------|-------------------------|------|-----|----------------------|----------------------|-----|-----|------------------------|-------|---------------------|-----|------------------------------------|--------------------|--------------------|--------------------|--------------------|--------------------|------------|
| New | Old | d | D | B | r _{1, 2min} | r _{3, 4min} | Fw | Ew | Cr | Cor | Grease | Oil | d _{a min} | d _{b min} | D _{a max} | D _{b max} | r _{a max} | r _{b max} | Refer |
| NU19/600 | 10329/600 | 600 | 800 | 90 | 5 | 5 | 655 | | 1590 | 3400 | 630 | 750 | | 642 | 780 | | 4 | 4 | 130 |
| NUP19/600 | 10929/600 | 600 | 800 | 90 | 5 | 5 | 655 | | 1590 | 3400 | 630 | 750 | | 642 | 780 | | 4 | 4 | 140 |
| NF19/600 | 10129/600 | 600 | 800 | 90 | 5 | 5 | 655 | | 1590 | 3400 | 630 | 750 | 736 | | | 780 | 4 | 4 | 135 |
| NU29/600 | 20329/600 | 600 | 800 | 118 | 5 | 5 | 649 | | 2760 | 6500 | 630 | 750 | | 620 | 780 | | 4 | 4 | 157 |
| NUP29/600 | 20929/600 | 600 | 800 | 118 | 5 | 5 | 649 | | 2760 | 6500 | 630 | 750 | | 620 | 780 | | 4 | 4 | 165 |
| NU10/600 | 321/600 | 600 | 870 | 118 | 6 | 6 | 661 | | 2650 | 5050 | 600 | 700 | | 626 | 844 | | 5 | 5 | 245 |
| NU20/600 | 20321/600 | 600 | 870 | 155 | 6 | 6 | 661 | | 3970 | 7800 | 500 | 600 | | 626 | 844 | | 5 | 5 | 325 |
| N30/600 | 30321/600 | 600 | 870 | 200 | 6 | 6 | | 814 | 4890 | 9860 | 500 | 600 | 626 | | | 844 | 5 | 5 | 415 |
| N28/630 | 20028/630 | 630 | 780 | 88 | 4 | 4 | | 743 | 1460 | 3780 | 630 | 750 | 646 | | | 764 | 3 | 3 | 100 |
| NU28/630 | 20328/630 | 630 | 780 | 88 | 4 | 4 | 668 | | 1460 | 3780 | 630 | 750 | | 646 | 764 | | 3 | 3 | 98 |
| N38/630 | 30028/630 | 630 | 780 | 112 | 4 | 4 | | 745 | 2100 | 5400 | 560 | 670 | 646 | | | 764 | 3 | 3 | 120 |
| NF38/630 | 30128/630 | 630 | 780 | 112 | 4 | 4 | | 745 | 2100 | 5400 | 560 | 670 | 646 | | | 764 | 3 | 3 | 125 |
| NU19/630 | 10329/630 | 630 | 850 | 100 | 6 | 6 | 688 | | 1850 | 3900 | 600 | 700 | | 656 | 824 | | 5 | 5 | 160 |
| NU29/630 | 20329/630 | 630 | 850 | 128 | 6 | 6 | 683 | | 3100 | 6800 | 600 | 700 | | 656 | 824 | | 5 | 5 | 220 |
| NUP29/630 | 20929/630 | 630 | 850 | 128 | 6 | 6 | 683 | | 3100 | 6800 | 600 | 700 | | 656 | 824 | | 5 | 5 | 230 |
| NU10/630 | 10321/630 | 630 | 920 | 128 | 7.5 | 7.5 | 702 | | 3200 | 6000 | 450 | 530 | | 666 | 887 | | 6 | 6 | 285 |
| NUP10/630 | 10921/630 | 630 | 920 | 128 | 7.5 | 7.5 | 702 | | 3200 | 6000 | 450 | 530 | | 666 | 887 | | 6 | 6 | 285 |
| NU20/630 | 20321/630 | 630 | 920 | 170 | 7.5 | 7.5 | 699 | | 4500 | 9000 | 480 | 560 | | 666 | 887 | | 6 | 6 | 285 |
| NU30/630 | 30321/630 | 630 | 920 | 212 | 7.5 | 7.5 | 699 | | 6230 | 1420 | 450 | 530 | | 666 | 887 | | 6 | 6 | 490 |
| NJ18/670 | 10428/670 | 670 | 820 | 69 | 4 | 4 | 708 | | 1190 | 2540 | 560 | 670 | | 700 | 787 | | 3 | 3 | 84.5 |
| NU28/670 | 20328/670 | 670 | 820 | 88 | 4 | 4 | 711 | | 1500 | 3950 | 560 | 670 | | 700 | 787 | | 3 | 3 | 103 |
| NU38/670 | 30328/670 | 670 | 820 | 112 | 4 | 4 | 711 | | 1920 | 5200 | 530 | 630 | | 700 | 787 | | 3 | 3 | 128 |
| NU19/670 | 10329/670 | 670 | 900 | 103 | 6 | 6 | 728 | | 2100 | 4500 | 530 | 630 | | 696 | 874 | | 5 | 5 | 195 |
| NUP19/670 | 10929/670 | 670 | 900 | 103 | 6 | 6 | 728 | | 2100 | 4500 | 530 | 630 | | 696 | 874 | | 5 | 5 | 195 |
| NU10/670 | 10321/670 | 670 | 980 | 136 | 7.5 | 7.5 | 747 | | 3500 | 5890 | 430 | 500 | | 703 | 947 | | 6 | 6 | 350 |
| NU20/670 | 20321/670 | 670 | 980 | 180 | 7.5 | 7.5 | 746 | | 5160 | 9800 | 430 | 500 | | 703 | 947 | | 6 | 6 | 480 |
| NU30/670 | 30321/670 | 670 | 980 | 230 | 7.5 | 7.5 | 744 | 914 | 6420 | 12100 | 430 | 500 | | 703 | 947 | | 6 | 6 | 600 |
| NU18/710 | 10328/710 | 710 | 870 | 74 | 4 | 4 | 750 | | 1400 | 3080 | 530 | 630 | | 726 | 854 | | 3 | 3 | 97.5 |
| N28/710 | 20028/710 | 710 | 870 | 95 | 4 | 4 | | 831 | 1870 | 4650 | 530 | 630 | 726 | | | 854 | 3 | 3 | 130 |
| NU19/710 | 10329/710 | 710 | 950 | 106 | 6 | 6 | 770 | | 2350 | 5500 | 500 | 600 | | 736 | 924 | | 5 | 5 | 214 |
| NU29/710 | 20329/710 | 710 | 950 | 140 | 6 | 6 | 766 | | 3450 | 8400 | 500 | 600 | | 736 | 924 | | 5 | 5 | 295 |
| NUP29/710 | 20929/710 | 710 | 950 | 140 | 6 | 6 | 766 | | 3450 | 8400 | 500 | 600 | | 736 | 924 | | 5 | 5 | 300 |
| NU10/710 | 321/710 | 710 | 1030 | 140 | 7.5 | 7.5 | 778 | | 4500 | 8500 | 430 | 500 | | 743 | 997 | | 6 | 6 | 415 |
| NU20/710 | 20321/710 | 710 | 1030 | 185 | 7.5 | 7.5 | 787 | | 5600 | 11200 | 400 | 480 | | 743 | 997 | | 6 | 6 | 540 |
| NU18/750 | | 750 | 920 | 78 | 5 | 5 | 794 | | 1240 | 3240 | 500 | 600 | | 770 | 900 | | 4 | 4 | 110 |
| NU28/750 | | 750 | 920 | 100 | 5 | 5 | 797 | | 1860 | 5000 | 500 | 600 | | 786 | 882 | | 4 | 4 | 145 |
| NF19/750 | | 750 | 1000 | 112 | 6 | 6 | | 943 | 2600 | 5760 | 480 | 560 | 776 | | | 974 | 5 | 5 | 265 |
| NU10/750 | | 750 | 1090 | 150 | 7.5 | 7.5 | 832 | | 4650 | 8600 | 360 | 430 | | 783 | 1057 | | 6 | 6 | 490 |
| NU20/750 | | 750 | 1090 | 195 | 7.5 | 7.5 | 832 | | 6700 | 13800 | 360 | 430 | | 783 | 1057 | | 6 | 6 | 635 |
| NJ18/800 | | 800 | 980 | 82 | 5 | 5 | 848 | | 1650 | 3980 | 450 | 530 | | 837 | 940 | | 4 | 4 | 145 |
| NU38/800 | | 800 | 980 | 136 | 5 | 5 | 848 | | 2530 | 7050 | 400 | 480 | | 837 | 940 | | 4 | 4 | 219 |
| NU19/800 | | 800 | 1060 | 115 | 6 | 6 | 870 | | 2760 | 6150 | 430 | 500 | | 843 | 1013 | | 5 | 5 | 282 |
| NU29/800 | | 800 | 1060 | 150 | 6 | 6 | 873 | | 3550 | 8570 | 400 | 480 | | 843 | 1013 | | 5 | 5 | 385 |
| NU28/850 | | 850 | 1030 | 106 | 5 | 5 | 900 | | 2130 | 5950 | | | | 888 | 989 | | 4 | 4 | 183 |
| NU19/850 | | 850 | 1120 | 118 | 6 | 6 | 925 | | 2780 | 6350 | | | | 894 | 1072 | | 5 | 5 | 320 |
| NU29/850 | | 850 | 1120 | 155 | 6 | 6 | 917 | | 4450 | 10500 | | | | 894 | 1072 | | 5 | 5 | 426 |
| NU18/900 | | 900 | 1090 | 85 | 5 | 5 | 949 | | 1890 | 4500 | | | | 939 | 1048 | | 4 | 4 | 170 |
| NU28/900 | | 900 | 1090 | 112 | 5 | 5 | 950 | | 2580 | 7100 | | | | 939 | 1048 | | 4 | 4 | 217 |
| NU38/900 | | 900 | 1090 | 140 | 5 | 5 | 950 | | 2990 | 8600 | | | | 939 | 1048 | | 4 | 4 | 269 |

EVERGLORY INDUSTRY CO., LIMITED

No. 29 Industrial Park North Road Wafangdian City Liaoning China

www.evergloryindustry.com

info@evergloryindustry.com

Tel / Whatsapp: 008613130008503



| Bearing NO. | | Boundary dimensions(mm) | | | | | | | Basic load ratings(kN) | | Limiting speed(rpm) | | Abutment and fillet dimensions(mm) | | | | | | Weight(kg) |
|-------------|-----------|-------------------------|------|-----|----------------------|----------------------|------|------|------------------------|-------|---------------------|-----|------------------------------------|--------------------|--------------------|--------------------|--------------------|--------------------|------------|
| New | Old | d | D | B | r _{1, 2min} | r _{3, 4min} | Fw | Ew | Cr | Cor | Grease | Oil | d _{a min} | d _{b min} | D _{a max} | D _{b max} | r _{a max} | r _{b max} | Refer |
| NU29/900 | | 900 | 1180 | 165 | 6 | 6 | 969 | | 5000 | 11000 | | | | 939 | 1048 | | 5 | 5 | 560 |
| NU29/950 | 20329/950 | 950 | 1250 | 175 | 7.5 | 7.5 | 1024 | | 5160 | 12000 | | | | 983 | 1217 | | 6 | 6 | 584 |
| NU18/1000 | | 1000 | 1220 | 100 | 6 | 6 | 1053 | | 2550 | 6060 | | | | 1026 | 1194 | | 5 | 5 | 265 |
| NU28/1000 | | 1000 | 1220 | 128 | 6 | 6 | 1058 | | 3200 | 8850 | | | | 1047 | 1170 | | 5 | 5 | 319 |
| NF28/1000 | | 1000 | 1220 | 128 | 6 | 6 | | 1165 | 3220 | 8880 | | | 1026 | | | 1194 | 5 | 5 | 350 |
| NJ28/1000 | | 1000 | 1220 | 128 | 6 | 6 | 1053 | | 3220 | 8880 | | | | 1026 | 1194 | | 5 | 5 | 345 |
| N28/1060 | | 1060 | 1280 | 128 | 6 | 6 | 1225 | | 3450 | 10200 | | | 1086 | | | 1254 | 5 | 5 | 360 |
| NU38/1060 | | 1060 | 1280 | 165 | 6 | 6 | 1120 | | 3750 | 11300 | | | | 1108 | 1228 | | 5 | 5 | 427 |
| NU29/1060 | | 1060 | 1400 | 195 | 7.5 | 7.5 | 1142 | | 6900 | 16700 | | | | 1093 | 1367 | | 6 | 6 | 870 |
| NU39/1060 | | 1060 | 1400 | 250 | 7.5 | 7.5 | 1146 | | 8900 | 23900 | | | | 1093 | 1367 | | 6 | 6 | 1070 |
| NJ18/1120 | | 1120 | 1360 | 106 | 6 | 6 | 1182 | | 3400 | 8500 | | | | 1146 | 1334 | | 5 | 5 | 335 |
| N28/1180 | | 1120 | 1360 | 140 | 6 | 6 | | 1296 | 3880 | 10200 | | | 1146 | | | 1334 | 5 | 5 | 465 |
| NU38/1120 | | 1120 | 1360 | 180 | 6 | 6 | 1180 | | 5700 | 17300 | | | | 1169 | 1307 | | 5 | 5 | 547 |
| NJ18/1180 | | 1180 | 1420 | 106 | 6 | 6 | 1242 | | 2960 | 7180 | | | | 1206 | 1394 | | 5 | 5 | 350 |
| NUP29/1180 | | 1180 | 1540 | 206 | 7.5 | 7.5 | 1258 | | 8800 | 20200 | | | | 1213 | 1507 | | 6 | 6 | 1090 |
| N39/1180 | | 1180 | 1540 | 272 | 7.5 | 7.5 | | 1466 | 10800 | 27800 | | | 1213 | | | 1474 | 6 | 6 | 1400 |
| NU6/1200 | | 1200 | 1520 | 185 | 7.5 | 7.5 | 1270 | | 7300 | 18400 | | | | 1239 | 1474 | | 6 | 6 | 797 |
| NU19/1250 | | 1250 | 1630 | 170 | 7.5 | 7.5 | 1350 | | 6300 | 15400 | | | | 1308 | 1566 | | 6 | 6 | 952 |
| N20/1250 | | 1250 | 1750 | 290 | 9.5 | 9.5 | | 1635 | 12600 | 30200 | | | 1290 | | | 1710 | 8 | 8 | 2320 |
| NU18/1320 | | 1320 | 1600 | 122 | 6 | 6 | 1395 | | 3650 | 9070 | | | | 1346 | 1574 | | 5 | 5 | 530 |
| NUP18/1320 | | 1320 | 1600 | 122 | 6 | 6 | 1395 | | 3650 | 9070 | | | | 1346 | 1574 | | 5 | 5 | 560 |
| NU19/1320 | | 1320 | 1720 | 175 | 7.5 | 7.5 | 1424 | | 7000 | 17100 | | | | 1380 | 1654 | | 6 | 6 | 1100 |
| NU29/1320 | | 1320 | 1720 | 230 | 7.5 | 7.5 | 1420 | | 10400 | 28800 | | | | 1380 | 1654 | | 6 | 6 | 1480 |
| NU39/1320 | | 1320 | 1720 | 300 | 7.5 | 7.5 | 1410 | | 128000 | 32500 | | | | 1380 | 1654 | | 6 | 6 | 1950 |
| N30/1320 | | 1320 | 1850 | 400 | 12 | 12 | | 1737 | 20400 | 52200 | | | 1430 | | | 1803 | 10 | 10 | 3550 |
| N28/1400EM | | 1400 | 1700 | 175 | 7.5 | 7.5 | | 1637 | 6600 | 18300 | | | 1628 | | | 1646 | 6 | 6 | 860 |



EVERGLORY INDUSTRY CO., LIMITED

No. 29 Industrial Park North Road Wafangdian City Liaoning China

www.evergloryindustry.com

info@evergloryindustry.com

Tel / Whatsapp: 008613130008503